

AL-SPEED® FRAME



ATLAS AL-SPEED®

- **STRONG & VERSATILE SYSTEM**
- **LIGHTWEIGHT FRAME**
- **EFFICIENT SET-UP & STRIPPING**



**ATLAS
CONSTRUCTION
SUPPLY, INC.**

ATLAS AL-SPEED® FRAME

THE INNOVATIVE AL-SPEED® FRAME IS A LIGHT, STRONG AND DURABLE ALUMINUM SHORING FRAME THAT WILL IMPROVE THE QUALITY AND SPEED OF CONCRETE CONSTRUCTION, EASE FORMWORK SET-UP AND REMOVAL, AND REDUCE CONCRETE CONSTRUCTION COSTS. THIS VERSATILE SHORING FRAME IS THE RESULT OF RIGOROUS RESEARCH AND TESTING; PERFORMED TO PROVIDE OUR CUSTOMERS WITH THE VERY BEST SHORING SYSTEM AVAILABLE.



THE HIGH LOAD CAPACITY OF THE AL-SPEED® FRAME (16 KIP/LEG)*, COMBINED WITH BEING LIGHTWEIGHT AND REQUIRING MINIMAL COMPONENTS, PROVIDES CONTRACTORS WITH A SHORING FRAME THAT IS RELIABLE, EFFICIENT AND ECONOMICAL. ATLAS CONSTRUCTION SUPPLY TAKES PRIDE IN PROVIDING CUSTOMERS WITH SHORING SOLUTIONS THAT WILL LEAD TO ACCOMPLISHED PROJECT OBJECTIVES AND LASTING RELATIONSHIPS.

*3 TIERS HIGH, CROSS-BRACED TOWERS
SAFETY FACTOR = 2.5 : 1
EQUAL SCREWJACK EXTENSION, TOP & BOTTOM

ADVANTAGES OF AL-SPEED® FRAME

- **ALUMINUM: LIGHTWEIGHT AND DURABLE FRAME WILL PROVIDE A LONG SERVICE LIFE.**
- **HIGH SHORING CAPACITY - 16 KIP/ LEG. 32,000 LBS. SUPPORT CAPACITY PER 50 LB. FRAME. (2.5 TO 1.0 SAFETY FACTOR).**
- **LESS TIME AND LABOR NEEDED FOR ERECTION AND DISMANTLING THAN OTHER SYSTEMS.**
- **6' WIDE FRAME REDUCES TOTAL NUMBER OF FRAMES NEEDED TO SUPPORT SUSPENDED CONCRETE AND FORMWORK. APPROXIMATELY 100 SQ.FT. PER FRAME, UP TO 12" SLAB THICKNESS.**
- **MINIMAL PARTS AND COMPONENTS. FRAME IS COMPLETE WITH INTEGRAL BEARING SURFACES.**
- **6', 5' & 2'8" HIGH FRAMES ACCOMMODATE ALL SHORING HEIGHTS.**
- **ONLY 2 REVOLUTIONS PER INCH FOR AL-SPEED® JACKS. QUICK SET-UP AND REMOVAL OF SYSTEM.**
- **STRIATED HORIZONTAL RAILS.**
- **QUICKLOCK SYSTEM ALLOWS FOR EASY CONNECTION AND REMOVAL OF CROSSBRACES.**
- **BOLTED CONNECTIONS ALLOW FRAME TO BE DISMANTLED INTO HIGH CAPACITY POST SHORES.**

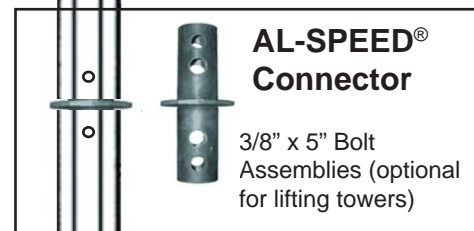
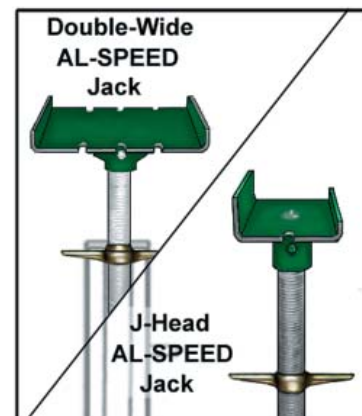

ATLAS AL-SPEED[®] FRAME SIZES

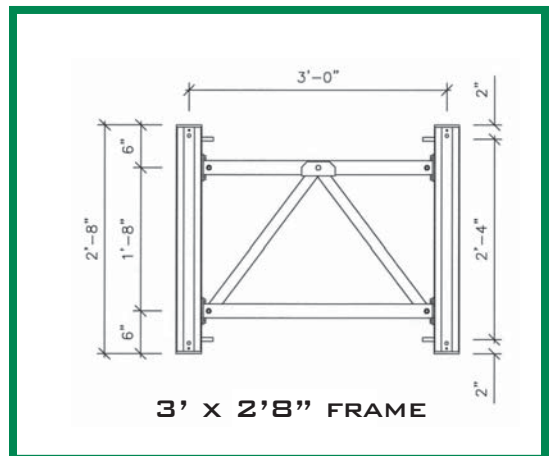
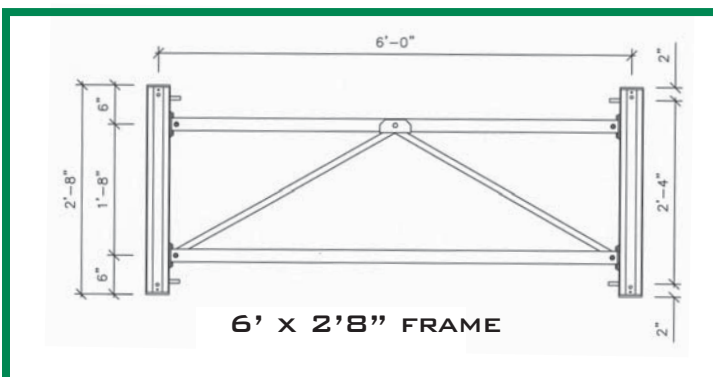
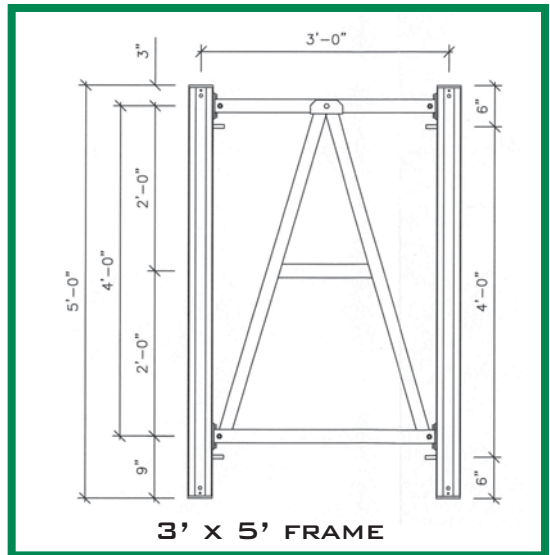
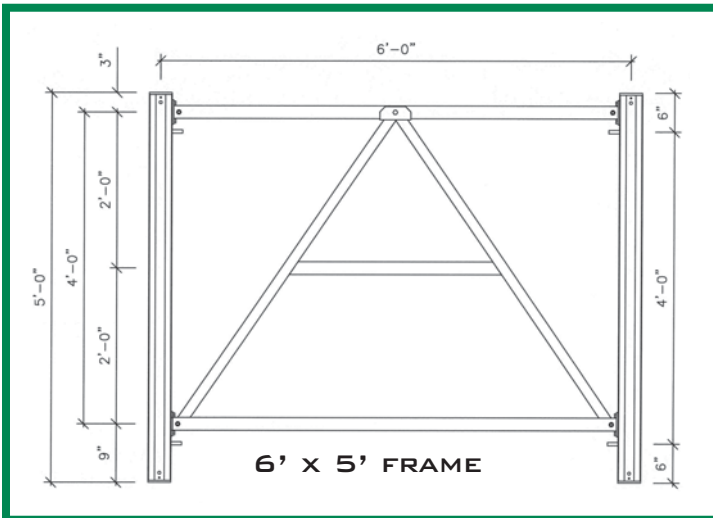
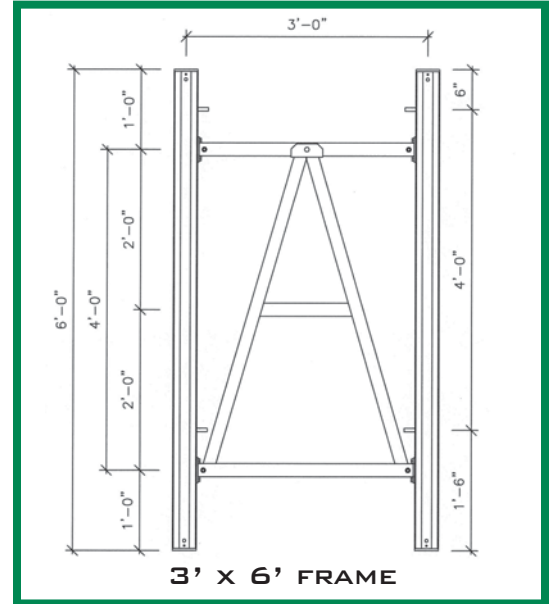
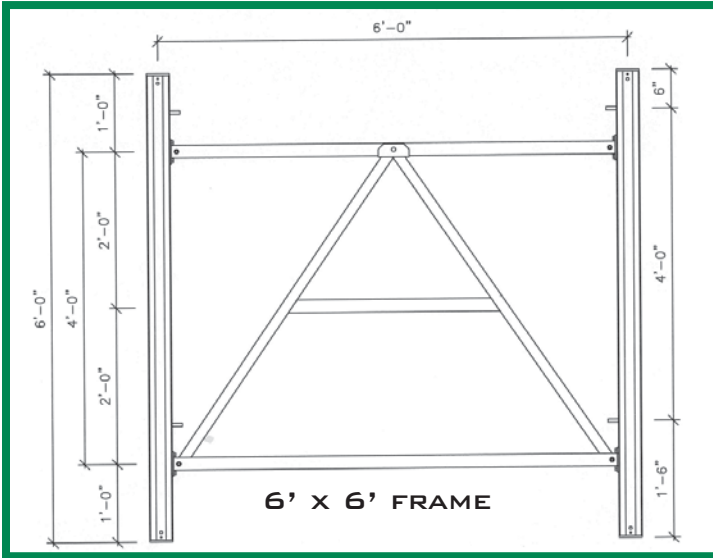

THE ATLAS AL-SPEED® FRAME OFFERS VERSATILITY AND CAN ACCOMMODATE NEARLY ANY SHORING HEIGHT!

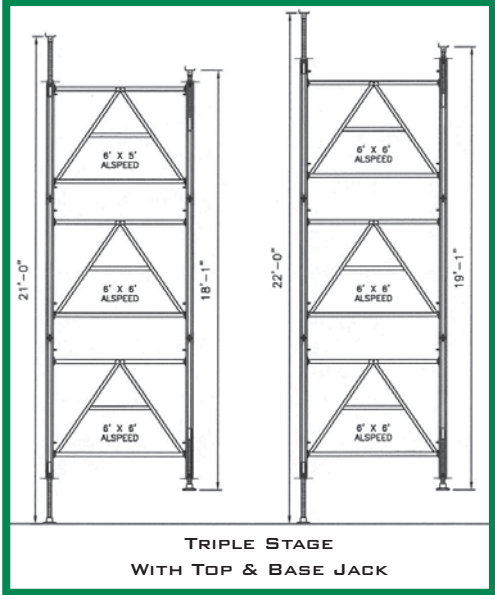
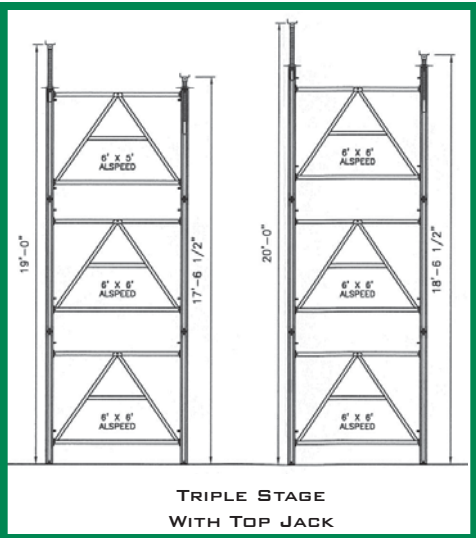
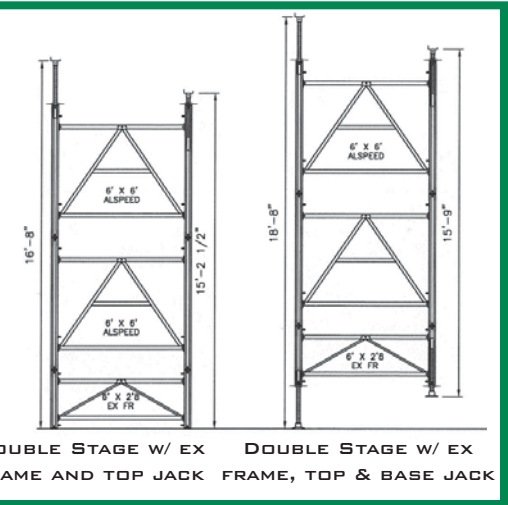
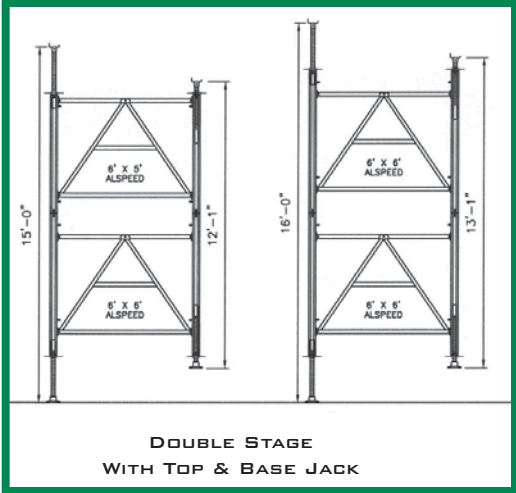
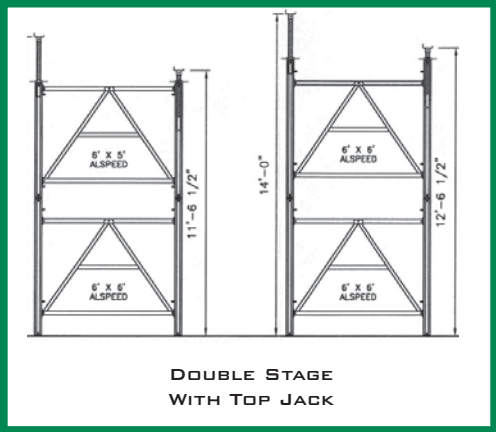
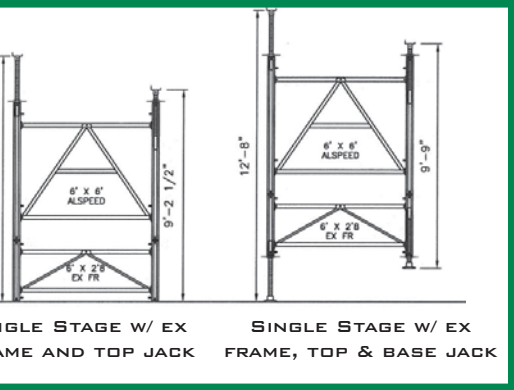
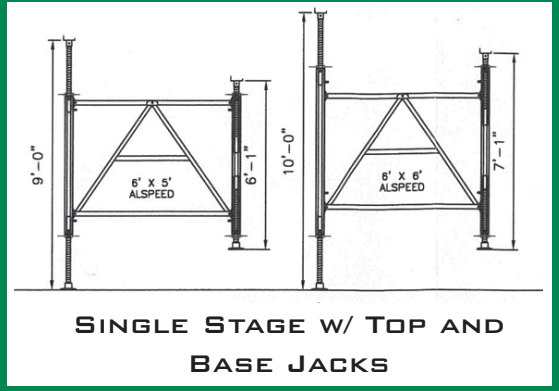
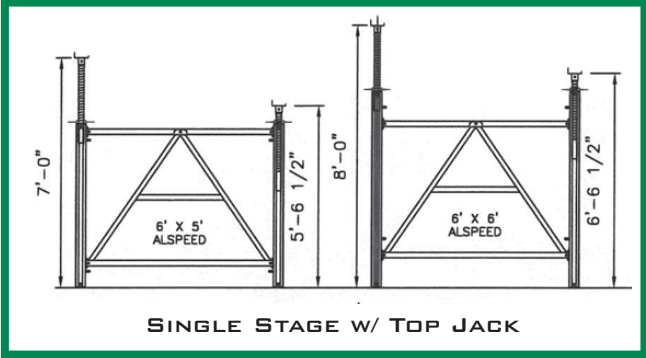

ATLAS AL-SPEED® FRAME

AL-SPEED® SHORING FRAME

IN ADDITION TO ALUMINUM BEAMS, ATLAS OFFERS CONTRACTORS LVL BEAMS, WHICH MAY PROVIDE GREATER VERSATILITY FOR SPECIFIC PROJECTS.



VERSATILITY

THE AL-SPEED® FRAME ALLOWS CONTRACTORS TO REACH NEARLY ANY SHORING HEIGHT, AND PROVIDES A SOLUTION FOR DIFFICULT “CUT-UP” OR CONGESTED BUILDING DESIGNS.

ECONOMICAL

THE VERSATILITY OF THE AL-SPEED® FRAME ALLOWS FOR QUICK ERECTION AND DISMANTLING OF SIMPLE AND INTRICATE DECK LAYOUTS. THE AL-SPEED® FRAME IS LIGHTWEIGHT (50 LBS) AND HAS FEWER PARTS THAN OTHER SHORING SYSTEMS, THEREFORE MAXIMIZING PRODUCTIVITY AND MINIMIZING JOBSITE LOSSES/THEFTS.



ATLAS AL-SPEED® FRAME



ALUMINUM BEAMS -
AVAILABLE IN STANDARD
LENGTHS: 10'6", 12'0",
14'0", 16'0" 18'0"
AND 21'0".

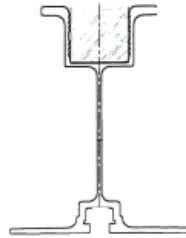

STRINGERS-
AVAILABLE IN STANDARD
LENGTHS: 12'0", 14'0",
16'0", AND 20'0"

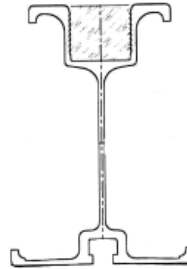

LVL BEAMS-
AVAILABLE IN STANDARD 4" x 4"
WITH 7' AND 14' LENGTHS.

CROSS BRACES-
AVAILABLE IN
STANDARD SIZES
4' x 4', 4' x 6',
4' x 8', 4' x 10'

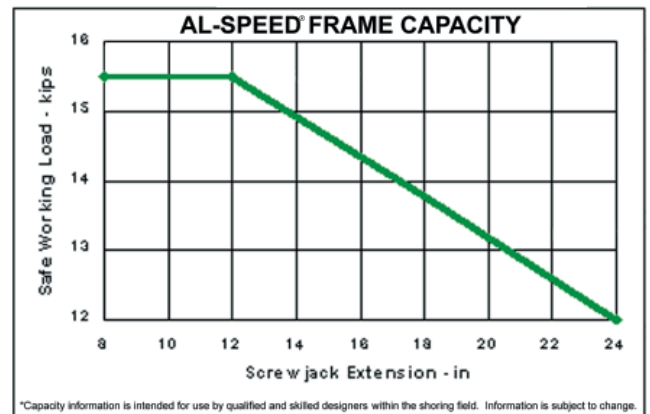
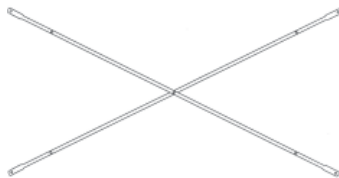

*Capacity information is intended for use by qualified and skilled designers within the shoring field. Information is subject to change.

TRIPLE STAGE, CROSS BRACED TOWERS
SAFETY FACTOR OF 2.5 TO 1.0
EQUAL SCREWJACK EXTENSION, TOP & BOTTOM



ONE TRUCKLOAD SHIPMENT CAN
PROVIDE 10,000 SQ.FT. OF THE
COMPLETE AL-SPEED® SHORING
SYSTEM. SINGLE STAGE, UP TO
1 2" THICK SLAB.



CORPORATE OFFICE

**4640 BRINELL ST.
SAN DIEGO, CA 92111
PHONE (858) 277-2100
TOLL FREE 1-877-588-2100
FAX (858) 277-0585**



**LOS ANGELES
(714) 441-9500
FAX (714) 441-9519**

**LAS VEGAS
(702) 227-6800
FAX (702) 222-0488**

**PHOENIX
(602) 256-0600
FAX (602) 256-0687**

**DENVER
(303) 298-7777
FAX (303) 298-7778**

**SAN FRANCISCO
(510) 353-0100
FAX (510) 353-0142**

**MEXICO
001 (877) 586-2100
FAX 001 (858) 277-0585**