

**EXISTING PATIENT TOWER**

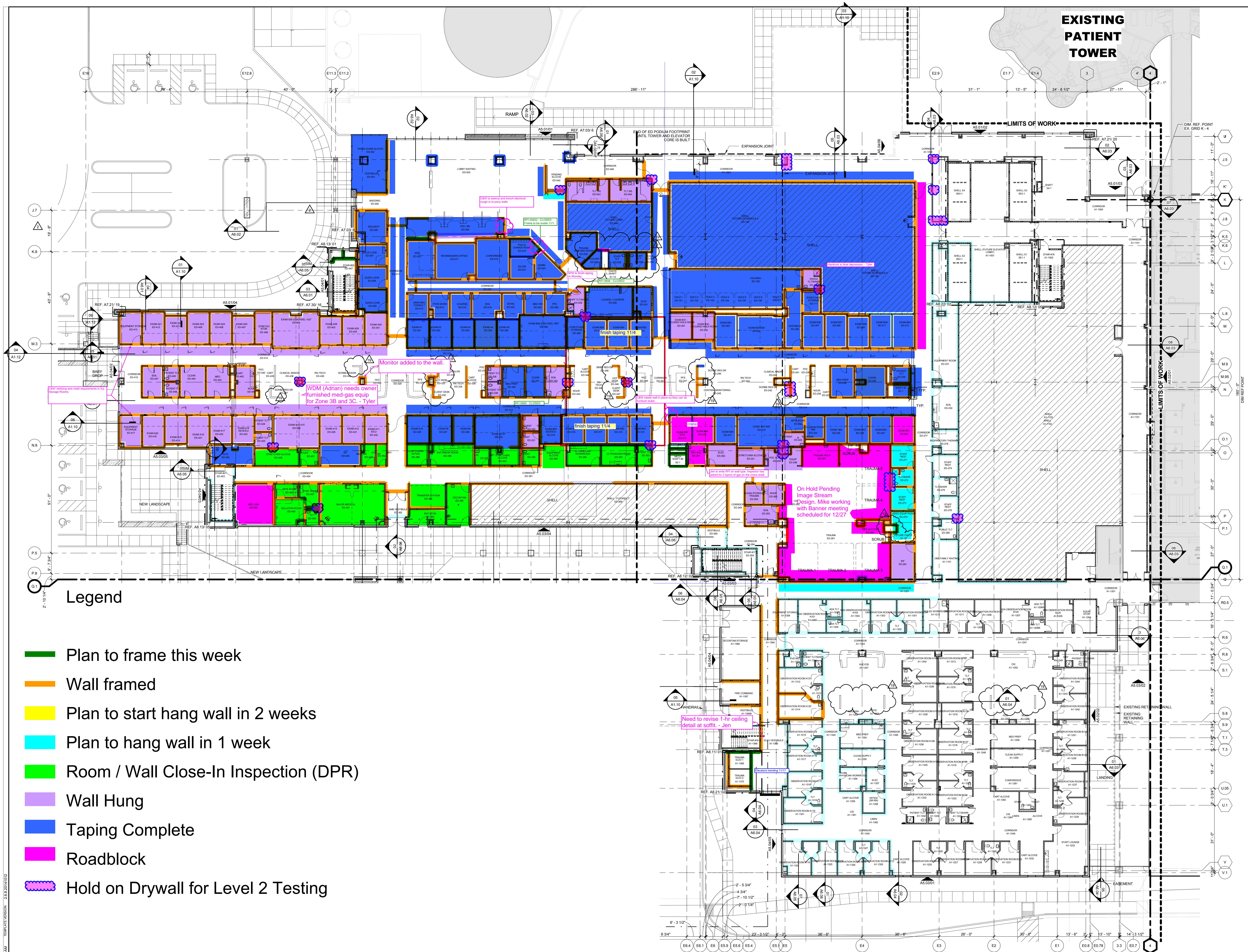

**Legend**

- Plan to frame this week
- Wall framed
- Plan to start hang wall in 2 weeks
- Plan to hang wall in 1 week
- Room / Wall Close-In Inspection (DPR)
- Wall Hung
- Taping Complete
- Roadblock
- Hold on Drywall for Level 2 Testing

Need to revise 1-hr ceiling detail at soffit - Jen

On Hold Pending Image Stream Design, Mike working with Banner meeting scheduled for 12/27

[VDM (Adrian) needs owner furnished med-gas equip for Zone 3B and 3C - Tyler

Monitor added to the wall.

finish taping 11/4

finish taping 11/4

finish taping 11/4

finish taping 11/4

finish taping 11/4

finish taping 11/4

finish taping 11/4

finish taping 11/4

finish taping 11/4

finish taping 11/4