

L-29 L-29T  
DISABLED PERSON SYMBOL  
NTS

(1)

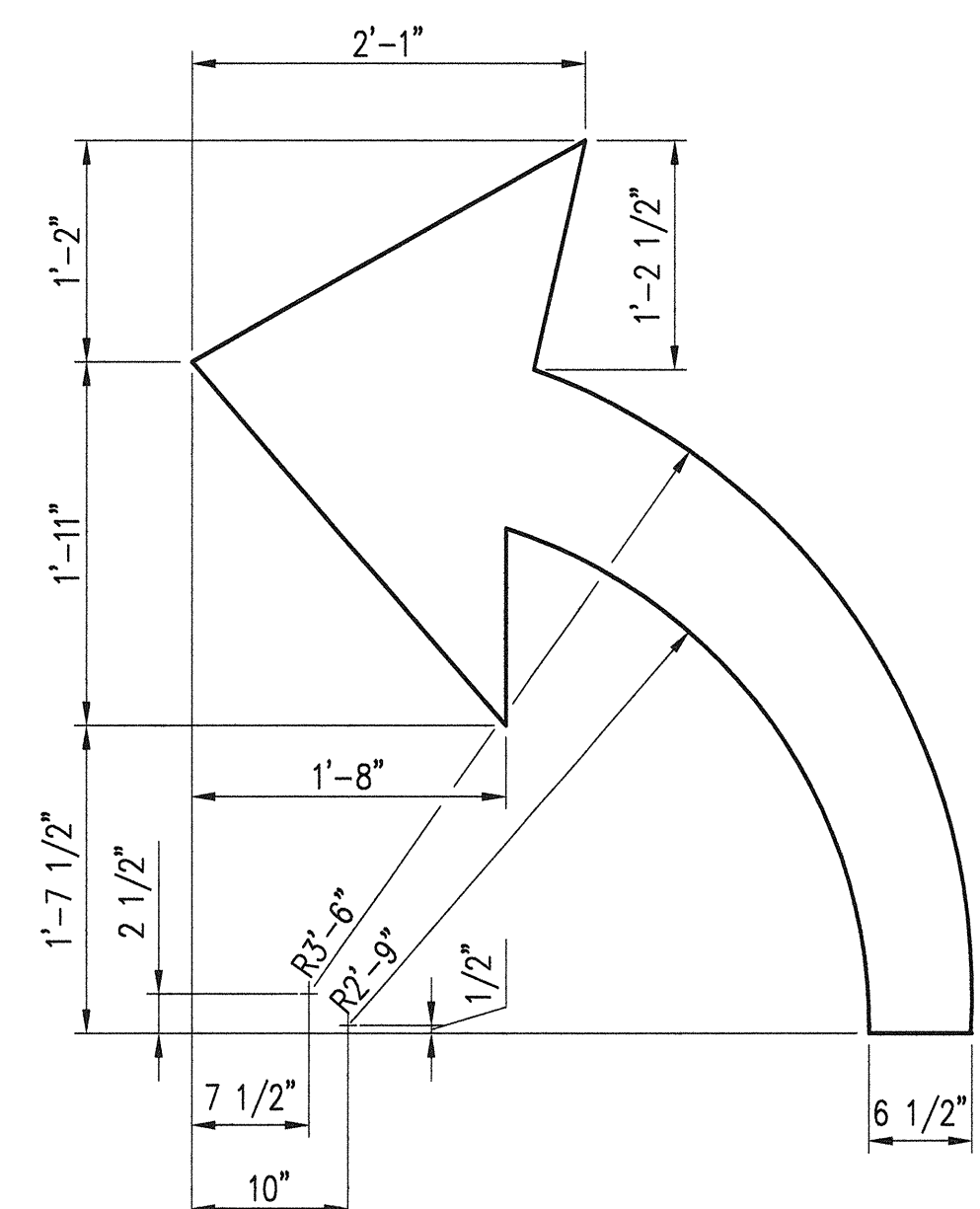

L-20  
LEFT ARROW  
NTS

(6)

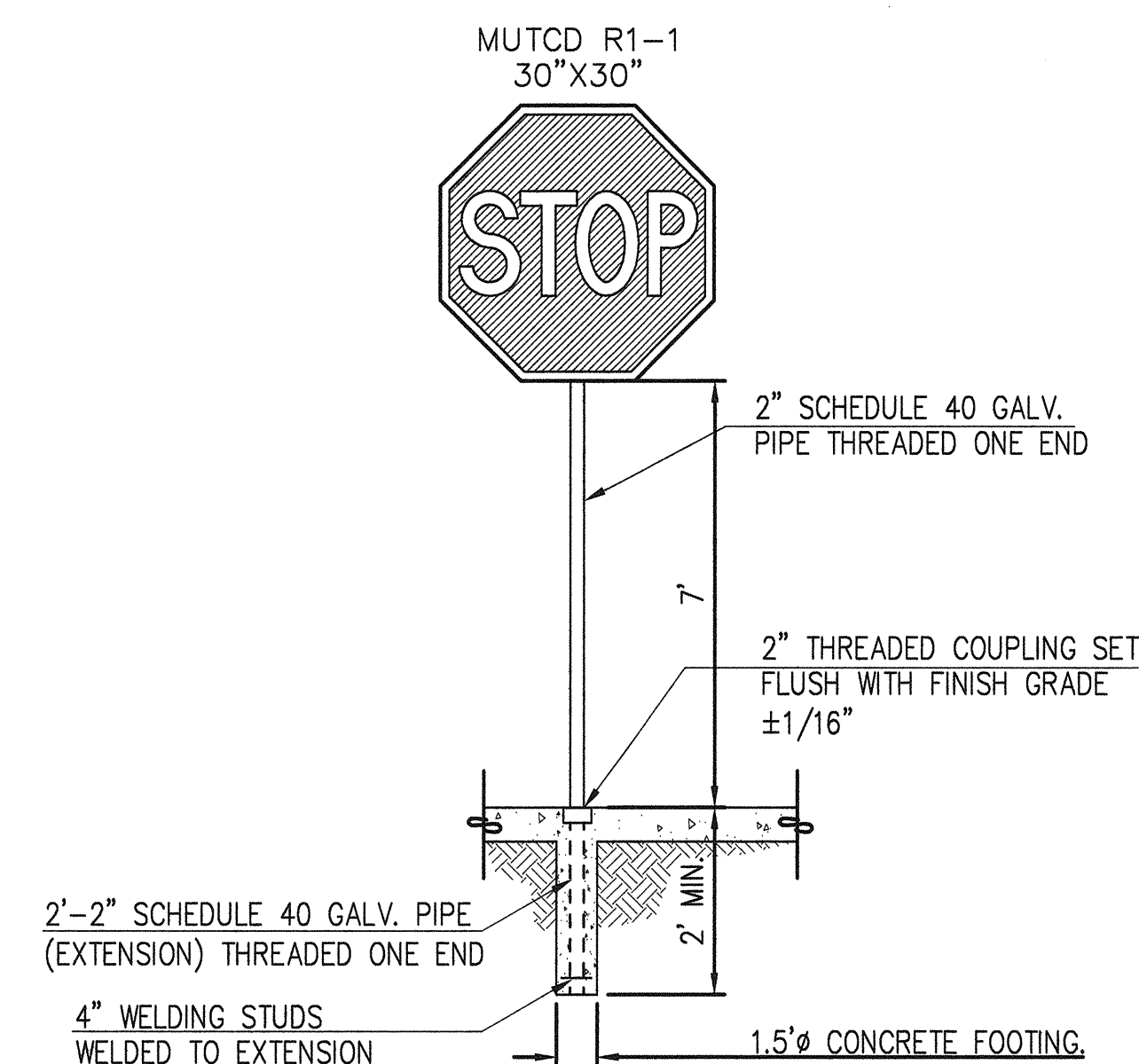

STOP SIGN DETAIL

NTS

(12)

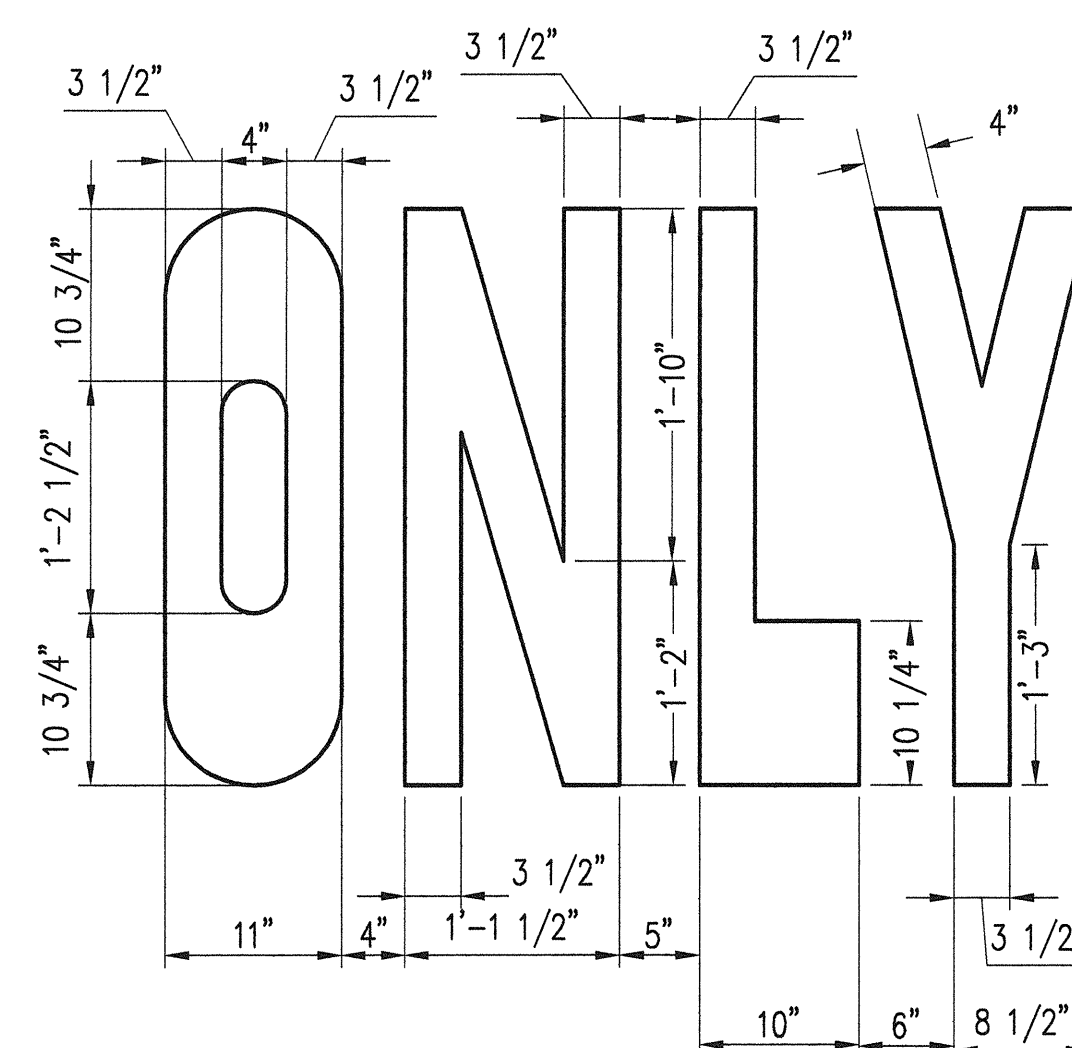

L-25 L-25T  
"ONLY" LEGEND  
NTS

(5)

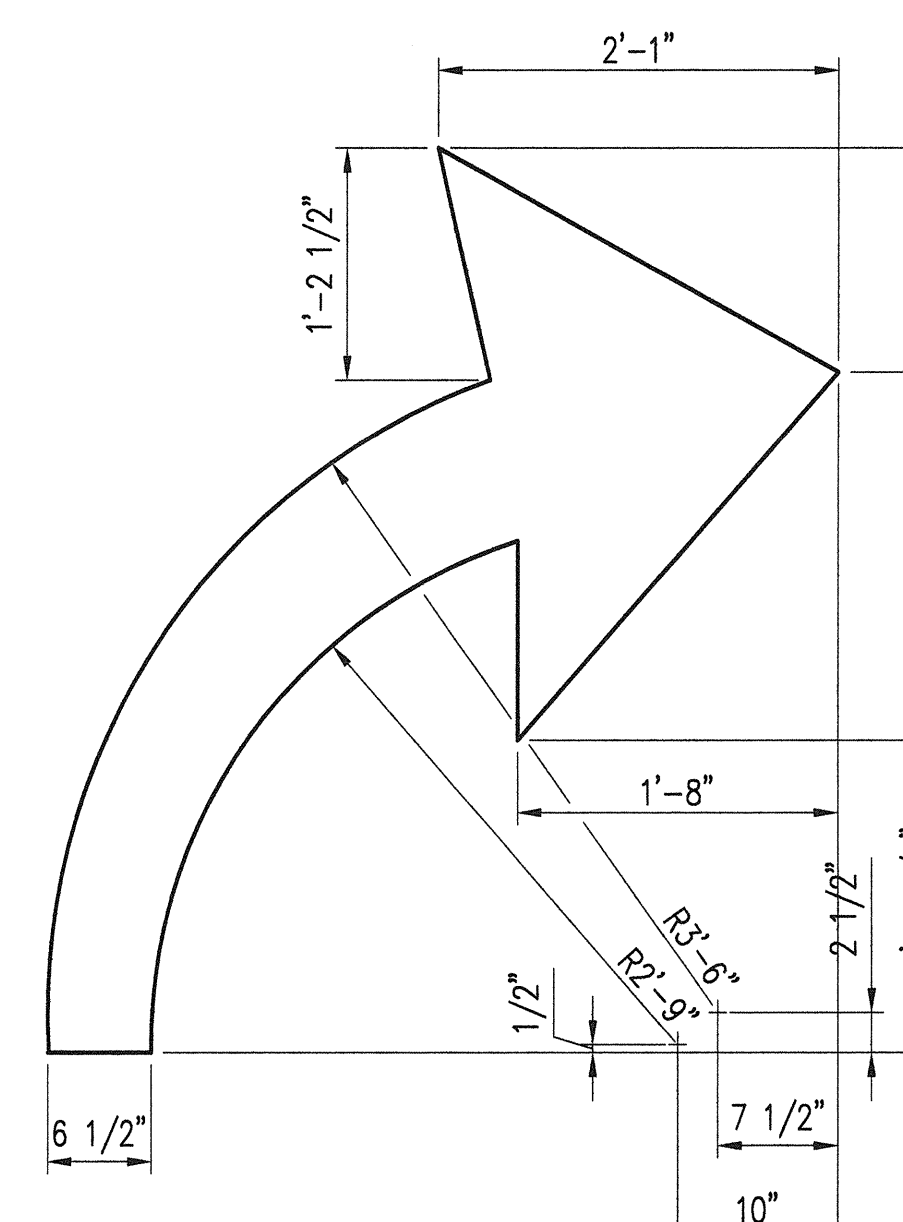

L-21  
RIGHT ARROW  
NTS

(7)

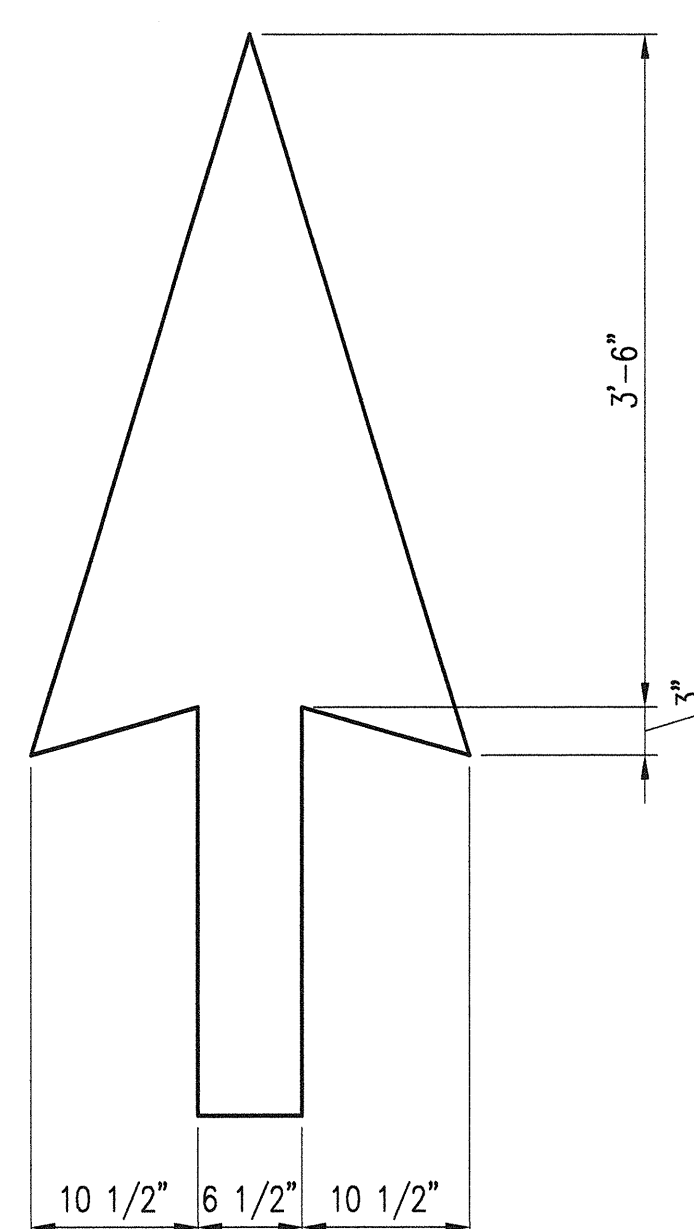

L-22 L-22T  
THROUGH ARROW  
NTS

(10)

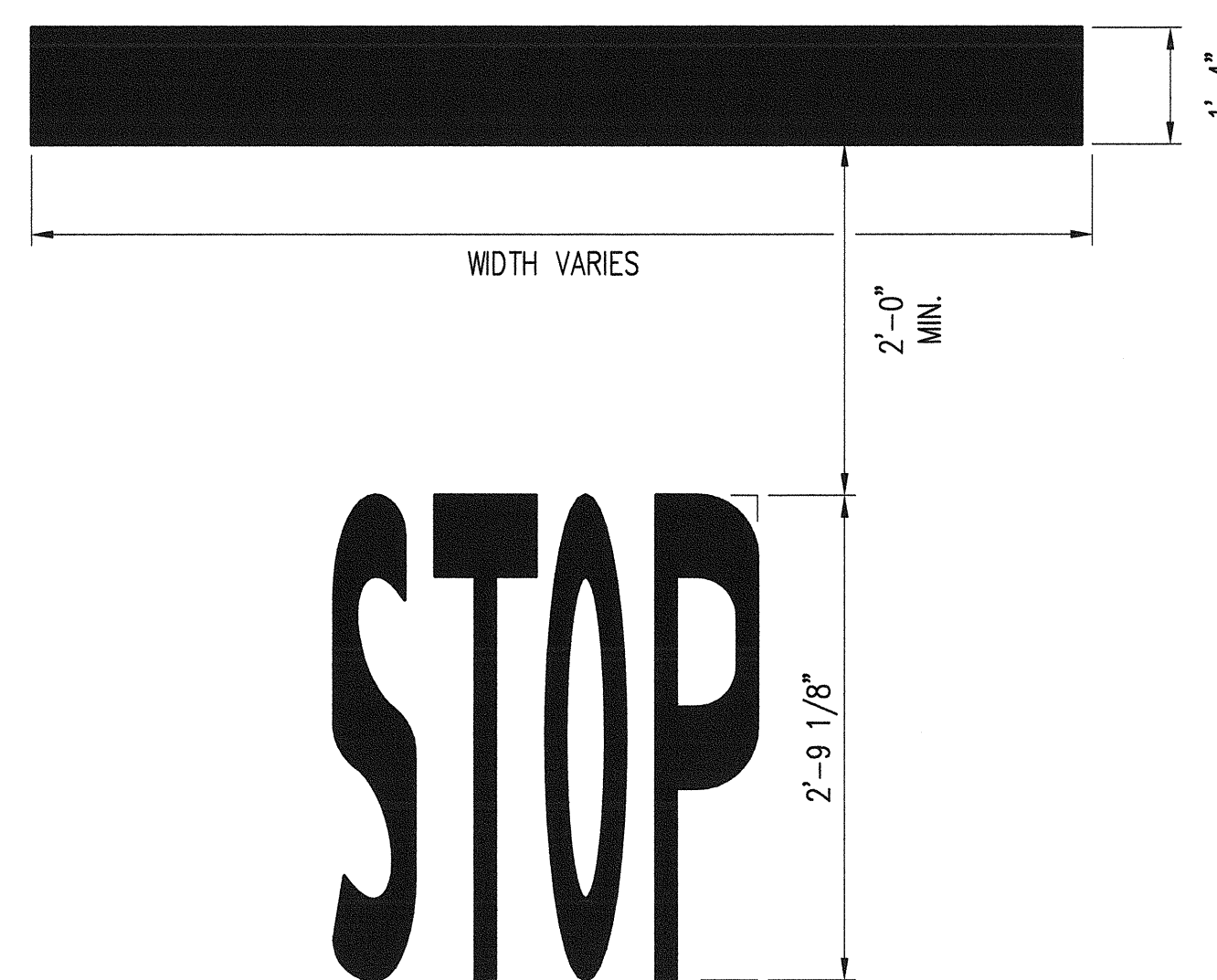

STOP BAR AND TEXT  
NTS

(11)

**kpff** Consulting Engineers

1201 Pacific Avenue, Suite 800  
Tacoma, Washington 98402  
(253) 396-0150 Fax (253) 396-0162

**GIFFIN • BOLTE • JURGENS** p.c.  
ARCHITECTS

815 S.W. SECOND AVENUE • PORTLAND, OREGON 97204  
(503) 223-0992 www.gb|arch.com FAX (503) 294-3961

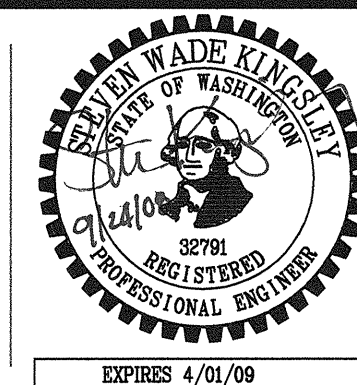

EXPIRES 4/01/09

**MultiCare**

EMERGENCY DEPARTMENT & CANCER CENTER EXPANSION

TACOMA, WASHINGTON

Date 09-26-2008  
Scale 1" = 10'  
Drawn By -  
Job No. 4034

PAVEMENT  
MARKING & SIGNAGE  
DETAILS

**C6**  
**04**