

1 2 3 4 5 6 7

A
B
C
D
E

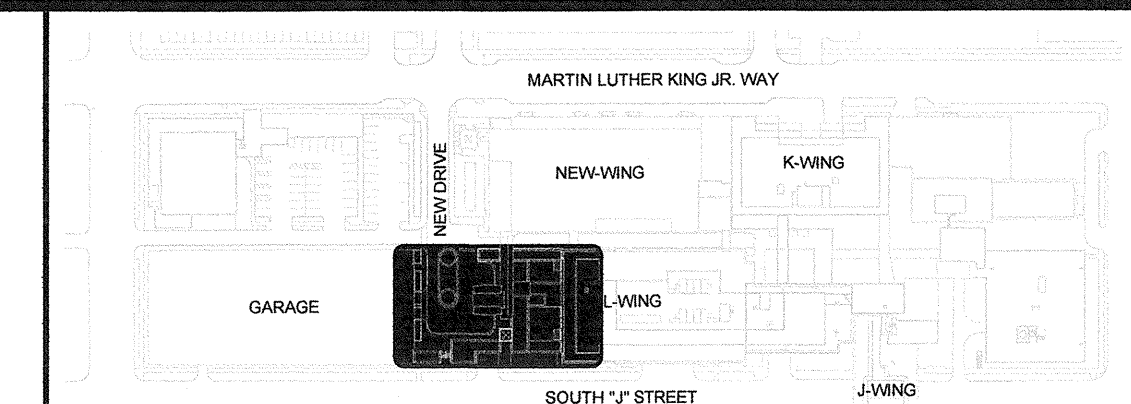
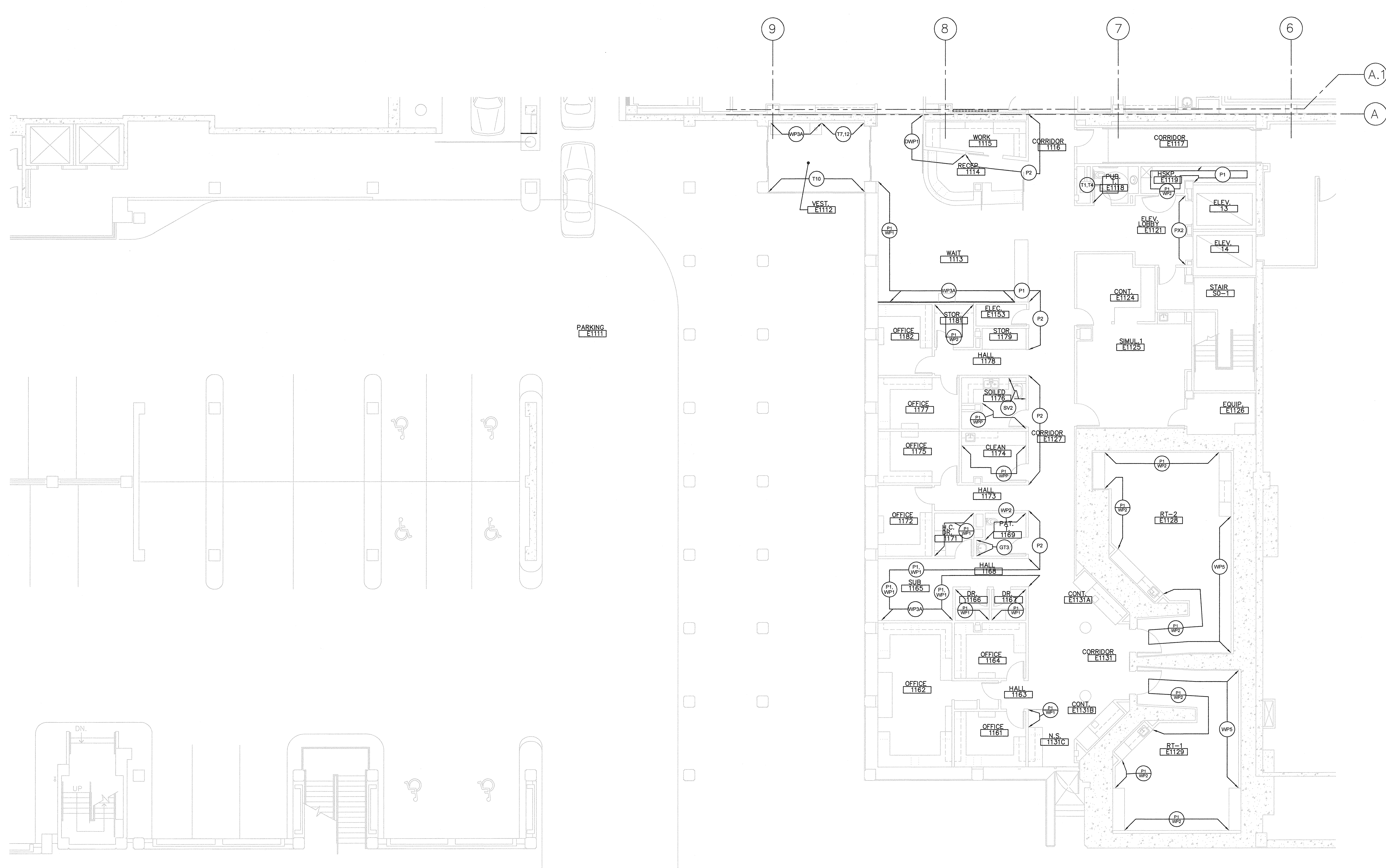

KEY PLAN

GENERAL NOTES:

- A. ALL SOFFITS TO BE PAINTED P-14 UNLESS OTHERWISE NOTED.
- B. SEE INTERIOR ELEVATIONS FOR EXTENT OF FINISHES
- C. SEE INTERIOR ELEVATIONS FOR ORIENTATION FO TYPICAL EXAM ROOM FINISHES.
- D. SEE INTERIOR ELEVATIONS FOR ALL WALL TILE PATTERNS.

KEYNOTES:

1. WP44 PANEL; SEE ELEVATIONS AND DETAILS FOR EXACT HEIGHT AND LOCATION.
2. PARTIAL HEIGHT PANEL; SEE ELEVATIONS AND DETAILS FOR EXACT HEIGHT AND LOCATION.
3. PAINT SOFFIT TO MATCH ADJACENT ACCENT WALL COLOR.
4. PAINT SOFFIT P-13.
5. PAINT SOFFIT P-14.
6. NOT USED
7. NURSE STATION 2125, PHYS 2127, NURSE STATION 3125 (GREEN) INCLUDES THE FOLLOWING MATERIALS: PL-6, TB-3, P-6. SEE ARCHITECTS ELEVATIONS AND RFS FOR LOCATIONS.
8. NURSE STATION 2116 (PURPLE) INCLUDES THE FOLLOWING MATERIALS: PL-7, TB-4, P-7. SEE ARCHITECT S ELEVATIONS AND RFS FOR LOCATIONS.
9. NURSE STATION 3136, PHYS. WORK 2113, PHYS. WORK 3136 (BLUE) INCLUDES THE FOLLOWING MATERIALS: PL-8, TB-5, P-8. SEE ARCHITECTS ELEVATIONS AND RFS FOR LOCATIONS.
10. NURSE STATION 2081, PHYS. WORK 2086, PHYS. WORK 3089, NURSE STATION 3072 (BLUE) INCLUDES THE FOLLOWING MATERIALS : PL-9, TB-6, P-9. SEE ARCHITECTS ELEVATIONS AND RFS FOR LOCATIONS.
11. NURSE STATION 2078, NURSE STATION 3079 (BROWN) INCLUDES THE FOLLOWING MATERIALS: PL-10, TB-7, P-10. SEE ARCHITECTS ELEVATIONS AND RFS FOR LOCATIONS.
12. NURSE STATION 2074, PHYS. WORK 2072 INCLUDES THE FOLLOWING MATERIALS, PL-11, TB-8, P-11. SEE ARCHITECTS ELEVATIONS AND RFS FOR LOCATIONS.
13. NOTE T-9 AT EXPOSED AREAS OF SOFFIT.
14. SEE ELEVATIONS AND DETAILS FOR TRIMS & DIMENSIONS.
15. AWT-2 WITH P-1 ABOVE LIGHT COVE -SEE INTERIOR ELEVATIONS FOR EXTENT.
16. NOT USED
17. AWT-2 WITH P-1 ABOVE LIGHT COVE- SEE INTERIOR ELEVATIONS FOR EXTENT.

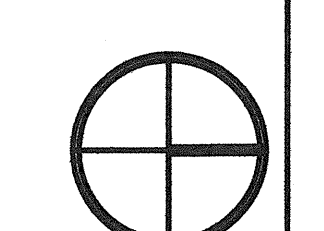

GIFFIN • BOLTE • JURGENS
ARCHITECTS

815 S.W. SECOND AVENUE • PORTLAND, OREGON 97204
(503) 223-0992 www.gbjarch.com FAX (503) 234-3961

c&e
921 S.W. WASHINGTON, #316
PORTLAND, OREGON 97206
TEL 503.242.0956
FAX 503.241.0648

MultiCare
EMERGENCY DEPARTMENT & CANCER CENTER EXPANSION
TACOMA, WASHINGTON

Date 01-21-2009
Scale 1/8"=1'-0"
Drawn By CJC
Job No. 4034

1st Floor
Wall Finishes Plan
L-wing

F2
31