

1 ELEVATION  
53.01 1/8" = 1'-0"

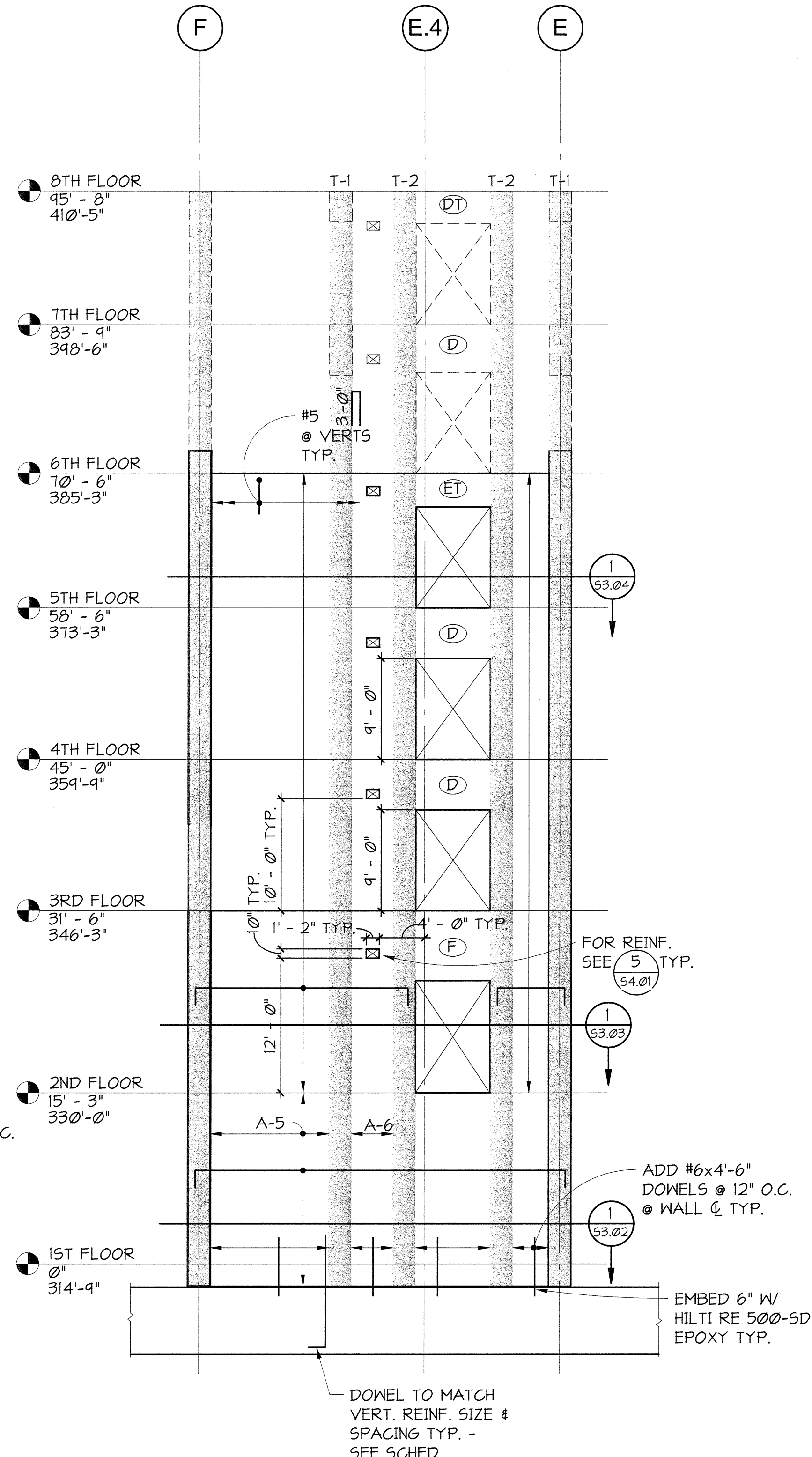

2 ELEVATION  
53.01 1/8" = 1'-0"

CORE WALL REINFORCEMENT SCHEDULE																
MARK LEVEL	A-4		A-5		A-6		A-7		A-8		T-1		T-2		T-3	
	VERTS	HORIZ.	VERTS	HORIZ.	VERTS	HORIZ.	VERTS	HORIZ.	VERTS	HORIZ.	VERTS	TIES	VERTS	TIES		TIES
8TH FLOOR (Future)																
7TH FLOOR (Future)																
6TH FLOOR																
5TH FLOOR																
4TH FLOOR											(6) #6	N.A.	(6) #6	N.A.		N.A.
3RD FLOOR												#4 @ 6" O.C.		#4 @ 6" O.C.		#4 @ 6" O.C.
2ND FLOOR												#4 @ 6" O.C.		#4 @ 6" O.C.		#4 @ 6" O.C.
1ST FLOOR	(34) #6	#7 @ 6" O.C.	(22) #6	#7 @ 6" O.C.	(6) #6	#7 @ 6" O.C.	(12) #6	#7 @ 6" O.C.	(6) #6	#7 @ 6" O.C.	(2) #6	#4 @ 6" O.C.	(2) #6	#4 @ 6" O.C.	(10) #6	#4 @ 6" O.C.
MAT FDN																

NOTES:  
1. WHEN REINF. IS NOT CALLED OUT USE REINF. FROM LEVEL BELOW.  
2. SPLICES ARE OPTIONAL, CONTRACTOR COORDINATE.  
3. DOWELS TO MATCH VERT. SIZE & SPACING - TYP.  
4. USE STANDARD HOOKS WHERE SHOWN IN ELEVATION.

3 CORE WALL REINFORCING SCHEDULE  
53.01 1/8" = 1'-0"

SHEAR WALL SPLICE SCHEDULE			
BAR SIZE	CONFINED VERT. REINF.	UNCONFINED VERT. REINF.	HORIZ. REINF.
#4	1'-7"	2'-6"	3'-4"
#5	1'-11"	3'-2"	4'-2"
#6	2'-4"	3'-9"	5'-0"
#7	3'-4"	5'-8"	7'-4"
#8	3'-11"	6'-6"	8'-4"
#9	4'-5"	7'-4"	9'-5"
#10	4'-11"	8'-2"	10'-8"
#11	5'-5"	9'-1"	11'-10"

- SPLICE SCHEDULE NOTES:  
1. SEE SECTION CUTS FOR REINFORCING LAYOUT.  
NOTES:  
1.  $f_c = 7,000$  psi.  
2. TOP OF WALL VARIES, SEE PLAN.  
3. CONCRETE WALL VERTICAL AND HORIZONTAL ALIGNMENT TOLERANCE SHALL BE +/- 1/4 INCH FROM THEORETICAL.  
4. SEE 8/54.50 FOR TYPICAL EMBED PLATE DETAILS.  
5. SEE 13/54.40 & 15/54.40 FOR TYPICAL WALL TO SLAB CONNECTION DETAILS.  
6. WHEN REINFORCEMENT IS NOT CALLED OUT USE REINFORCEMENT FROM LEVEL BELOW.  
7. VERTICAL BAR SPLICES ARE OPTIONAL, CONTRACTORS COORDINATE.  
8. "T-X" SHADING INDICATES AREA OF CORE WALL "TIED" ZONE REINFORCEMENT SEE SCHEDULE.  
9. "A-X" INDICATES AREA OF CORE WALL VERTICAL AND HORIZONTAL REINFORCEMENT SEE SCHEDULE.  
10. - INDICATES COUPLING BEAM DESIGNATION, SEE 54.30 & 54.31 FOR DETAILS.

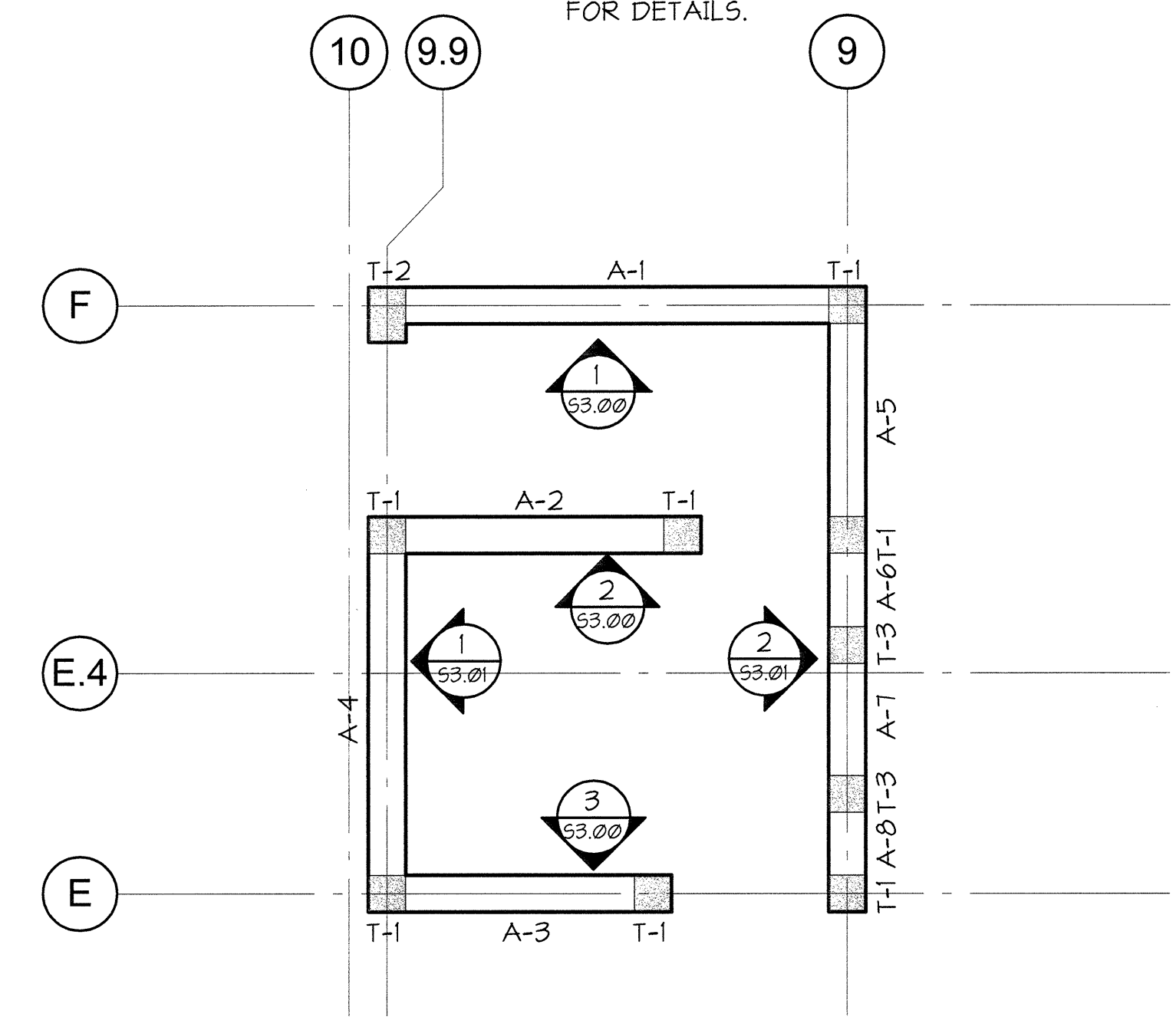

4 SOUTH CORE KEY PLAN  
53.01 1/8" = 1'-0"