

- GENERAL NOTES:**
- A. CONTRACTOR SHALL REVIEW RENOVATION PLANS FOR DEVICES AND EQUIPMENT TO REMAIN PRIOR TO DEMOLITION.
 - B. MAINTAIN CONTINUITY OF EXISTING CIRCUITS SERVING DEVICES AND EQUIPMENT TO REMAIN. EXISTING CIRCUITS OF EQUIPMENT SHALL REMAIN ENERGIZED. CIRCUITS WHICH ARE TO REMAIN BUT WERE DISTURBED DURING DEMOLITION SHALL HAVE WIRING AND POWER RESTORED BACK TO ORIGINAL CONDITION.
 - C. IT SHALL BE THE RESPONSIBILITY OF THE CONTRACTOR TO REMOVE AND LEGALLY DISPOSE OF DEMOLISHED MATERIALS.
 - D. THE OWNER RESERVES THE RIGHT TO INSPECT THE MATERIAL SCHEDULED FOR REMOVAL AND SALVAGE ANY ITEMS DEEMED USEABLE AS SPARE PARTS.
 - E. EXISTING CONDITIONS INDICATED ON THIS DRAWING ARE TAKEN FROM EXISTING DOCUMENTS AND FIELD INVESTIGATION. IT IS RECOMMENDED FOR CONTRACTOR TO VISIT PROJECT AREA AND VERIFY EXISTING CONDITIONS PRIOR TO DEMOLITION.
 - F. THE DEMOLITION PLAN IS NOT INCLUSIVE OF ALL ELECTRICAL DEVICES, FITTINGS, CONDUITS, ETC. IT IS INTENDED TO PROVIDE THE CONTRACTOR WITH A GENERAL KNOWLEDGE OF EXISTING CONDITIONS WITHIN THE PROJECT AREA.
 - G. EXISTING PANEL DIRECTORIES SHALL BE UPDATED TO REFLECT CURRENT CONDITIONS.
 - H. CONTRACTOR SHALL PATCH, PAINT, AND MATCH FINISH WITH EXISTING SURFACES TO REMAIN WHERE ELECTRICAL DEVICES ARE BEING REMOVED.

- KEY NOTES:**
- 1. EXISTING POLE MOUNTED SITE LIGHTING FIXTURES TO BE REMOVED. COORDINATE WITH CITY OF ST. PETERSBURG AND DUKE ENERGY FOR OWNERSHIP PRIOR TO DEMOLITION. VERIFY CIRCUIT SOURCE PRIOR TO DEMOLITION AND DISCONNECT POWER.
 - 2. DISCONNECT AND REMOVE ALL ELECTRICAL COMPONENTS SERVING COMPACTOR TO BE DEMOLISHED.

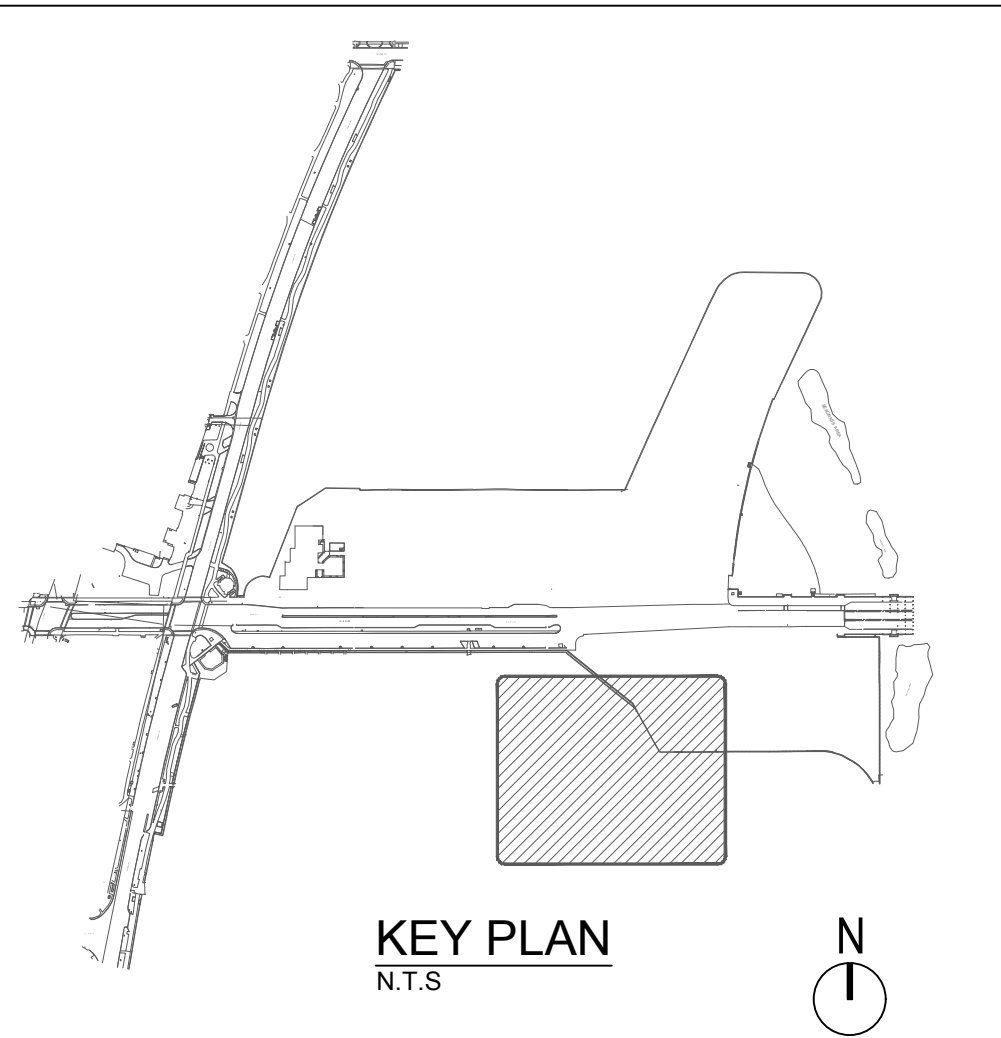

SCALE: 1" = 20'

0 10 20 40

N

