

3 TYP. REINFORCEMENT DETAIL @ CIP COLUMN
3/4" = 1'-0"

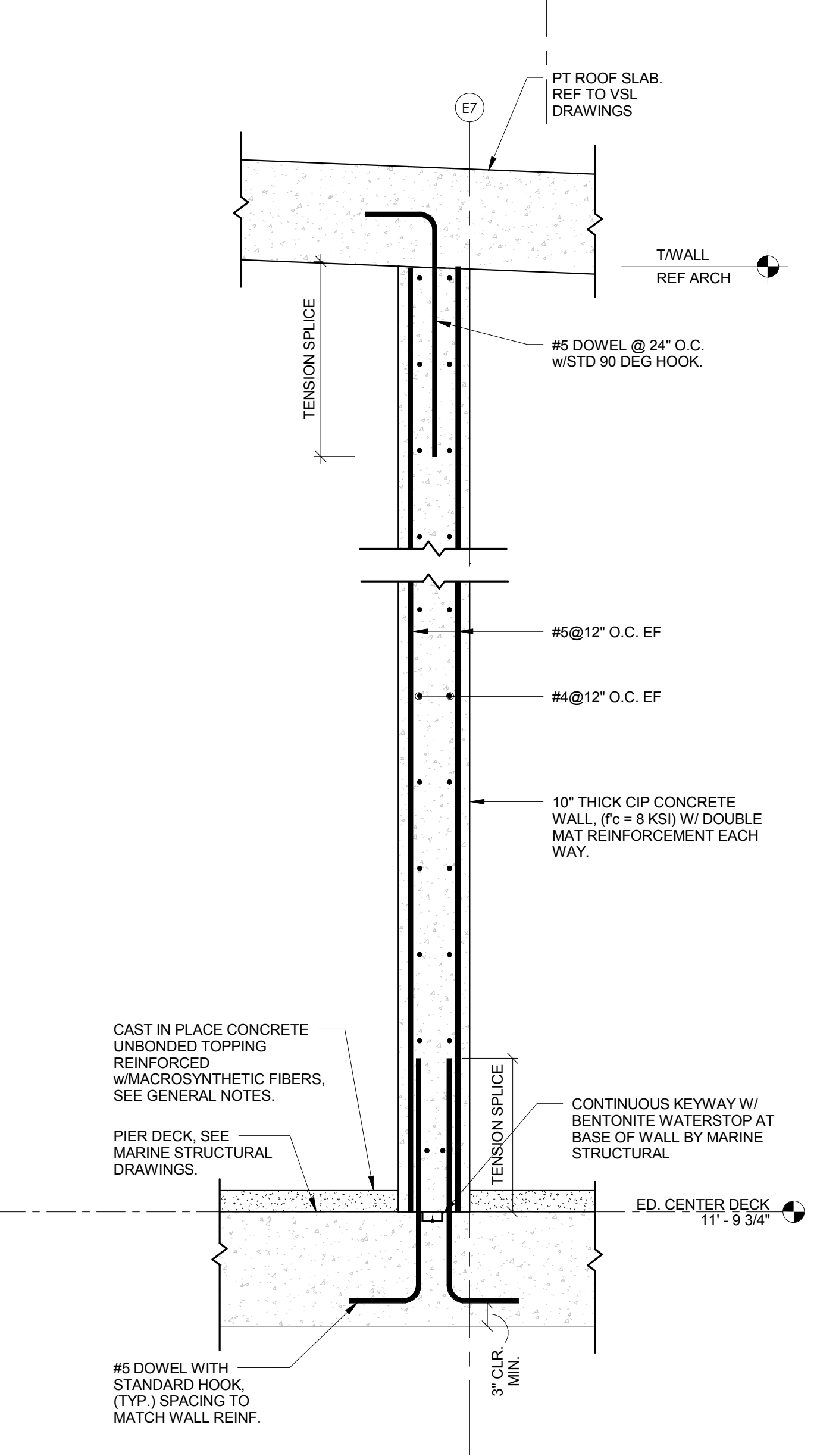

2 TYP. REINFORCEMENT DETAILS @ CONCRETE CORE WALLS
3/4" = 1'-0"

- FOUNDATION PLAN NOTES**
1. FOR DIMENSIONS NOT INDICATED ON THIS DRAWING REFER TO ARCHITECTURAL DRAWINGS.
 2. FOR BALANCE OF INFORMATION NOT INDICATED IN STRUCTURAL DRAWINGS, SEE ARCHITECTURAL AND CIVIL DRAWINGS.
 3. REFER TO CIVIL PLANS FOR SLAB DRAINAGE AND SPOT ELEVATIONS.
 4. CONTRACTOR IS RESPONSIBLE FOR THE MEANS AND METHODS OF ERECTION AND ENGINEERING OF ANY TEMPORARY SUPPORT OR LOADING CONDITIONS. CONTRACTOR TO SUBMIT ERECTION SEQUENCE PLAN FOR APPROVAL. DESIGN IS BASED ON SHORED CONSTRUCTION.
 5. REFER MARINE STRUCTURAL DECK REINFORCEMENT AND INFORMATION

COLUMN ID	WALL BASE LOADING			
	DL	LL+	WL+	WL-
E7-EC.3	145	15	65	-90
E7-EE	140	15	70	-95
E8-EC.3	135	10	70	-90
E8-EE	115	10	70	-90

COLUMN ID	BASE AXIAL FORCES (KIPS) AT COLUMNS			
	DL	LL+	WL+	WL-
E1-EF	70	10	20	-35
E2-EF	55	10	10	-20
E3-ED	150	20	30	-65
E4-EA	35	10	30	-45
E5-EE	100	15	25	-55
E6-EB	90	15	15	-40
E9-ED.1	50	10	20	-35
E10-EF	70	10	20	-40

Printed copies of this document are not considered signed and sealed and the signature must be verified on any electronic copies.

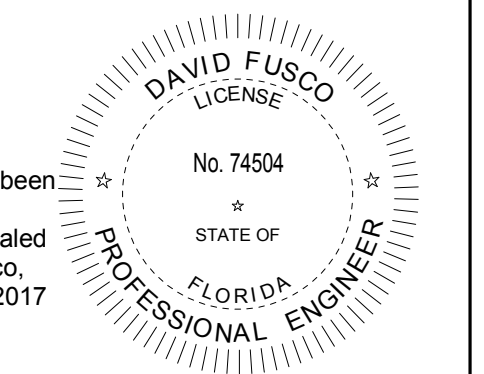

This item has been electronically signed and sealed by David Fusco, PE on 11-10-2017 using a Digital Signature.

TO THE BEST OF THE STRUCTURAL ENGINEER'S KNOWLEDGE, THE PLANS AND SPECIFICATIONS COMPLY WITH THE APPLICABLE MINIMUM CODES AS DETERMINED BY LOCAL AUTHORITY IN ACCORDANCE WITH CHAPTER 553, FLORIDA STATUTES.

1 ED. CENTER DECK
3/16" = 1'-0"

ASD SKY ROGERS PARTNERS
Architects+Urban Designers
100 Reade Street
New York, New York 10013
212-309-7570
www.rogersarchitects.com

WORKSHOP
KEN SMITH LANDSCAPE ARCHITECT
450 West 21st Street, 5th Fl., New York, NY 10011
212-791-3595
ken@smithworkshop.com

NO.	REVISIONS:	DATE:
1	PERMIT - CONSTRUCTION	11/17/2017

TLC
4880 W. Kennedy Blvd.
Suite 250
Tampa, Florida 33609
Phone: 813-637-0110
Fax: 813-637-0013
www.tlc-engineers.com
©Copyright 2017 TLC Engineering for Architecture, Inc.
COA 15 TLC NO. 714128

THE NEW ST PETERSBURG PIER
CITY OF ST PETERSBURG
CITY PROJECT NO. 09227-019

ENGINEERING AND CAPITAL
IMPROVEMENTS DEPARTMENT
CITY OF ST. PETERSBURG
APPROVED BY:

100% CONSTRUCTION DOCUMENTS
EDUCATION CENTER -
FOUNDATION PLAN

ISSUE DATE: 05-19-2017
DRAWN BY: [Signature] CHECKED BY: [Signature]
COPD DWF: 11083-
S3.01