

















## KEYNOTE

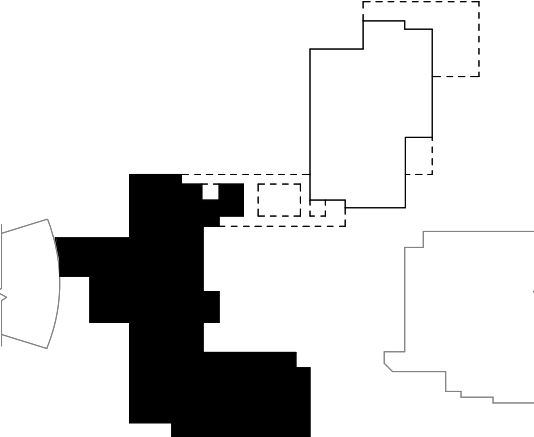

DATE \_\_\_\_\_ ISSU \_\_\_\_\_

| NO. | DATE       | REVISION |
|-----|------------|----------|
| 1   | 1/12/2024  | PR-24    |
| 4   | 04/09/2024 | PR-25    |
| 5   | 04/26/2024 | PR-17    |

DESIGN PARTNER  
BC  
PROJECT MANAGER  
JL  
PROJECT ARCHITECT  
CH  
PROJECT DESIGNER  
JW  
PROJECT TEAM MEMBERS  
SK, SB, KK  
CHECK  
KB

ARCHITECT SEAL

TITLE  
SIGN LOCATION PLAN -  
LEVEL 2 - ACADEMIC

PROJECT NO.  
**2122700**  
DATE  
**04/26/2024**

SHEET NUMBER  
**SG2.12A**

PROPOSAL REQUEST #17  
© 2024 MITHUN, INC.

### SIGN LEGEND

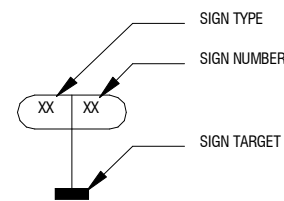

SIGN TARGETS INDICATE GENERAL  
SIGN LOCATIONS AND ARE KEYED  
TO THE SIGN MESSAGE SCHEDULE.

## SIGN TYPES

| Type | Description |
|------|-------------|
|------|-------------|

EXTERIOR

|    |                              |
|----|------------------------------|
| AA | Campus ID, Freestanding      |
| BB | Monument Sign                |
| CC | Pedestrian Directional Map   |
| DD | Pedestrian Directional       |
| EE | Playground Sign              |
| FF | Reclad Vehicular Directional |
| GG | Playground Letters           |
| HH | Playfield Panel on Fence     |

INTERIOR

|   |                               |
|---|-------------------------------|
| A | Building ID, Building Mounted |
| B | Vinyl Messages                |
| C | Room ID, Fixed Message        |
| D | Room ID, Changeable Message   |
| E | Room ID, Symbol               |
| F | Amenity Flag                  |
| G | Evacuation Map                |
| H | Information Sign              |
| J | Slat Wall Graphic             |
| K | Story Plaque                  |













---

---

---

---

---

---

BC  
PROJECT MANAGER  
JL  
PROJECT ARCHITECT  
CH  
PROJECT DESIGNER  
JW  
PROJECT TEAM MEMBERS  
SK, SB, KK  
CHECK  
KB

## TITLE

# SIGN DETAILS 1

SHEET NUMBER  
**SG5.01**

Proposal Request #24  
© 2022 MITHUN, INC.

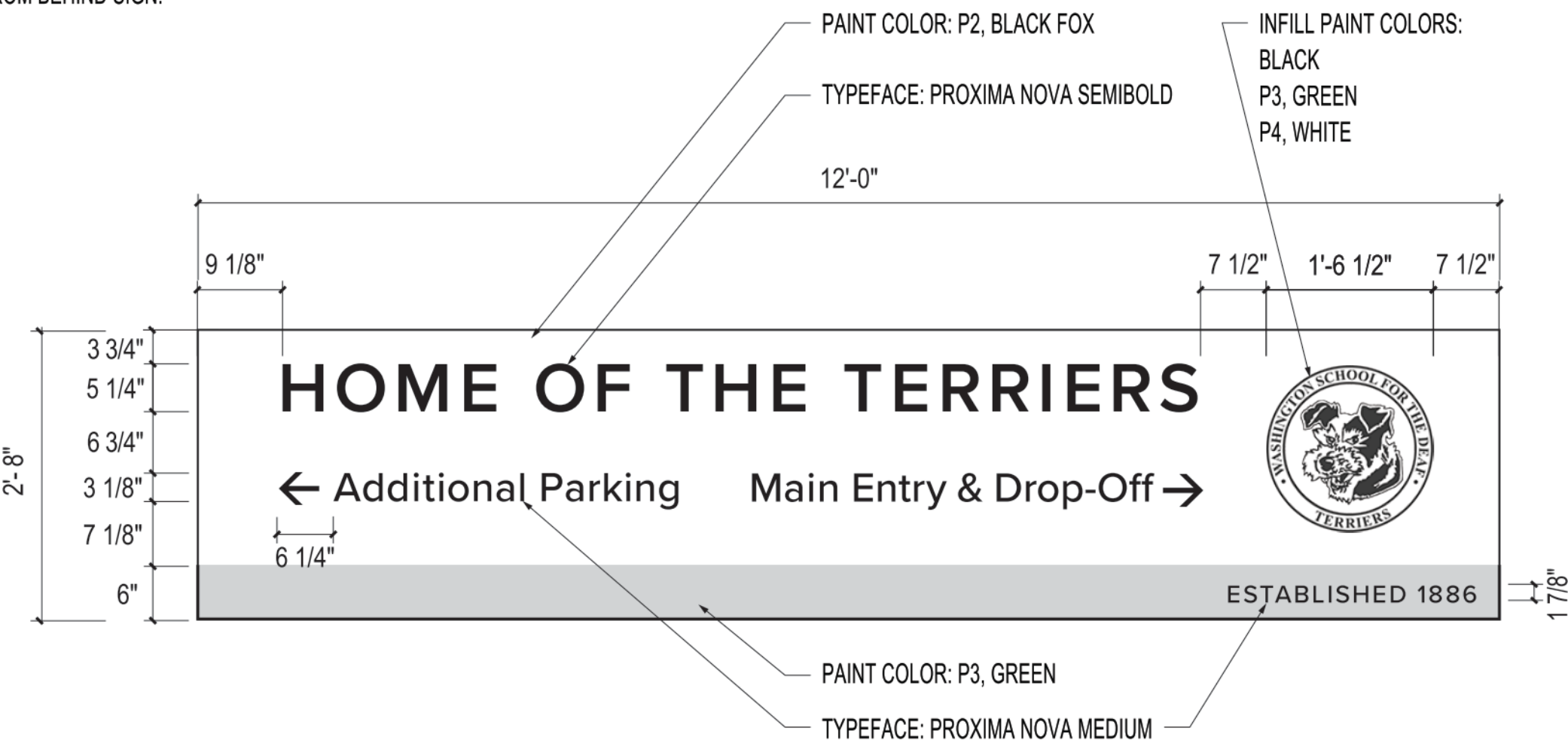
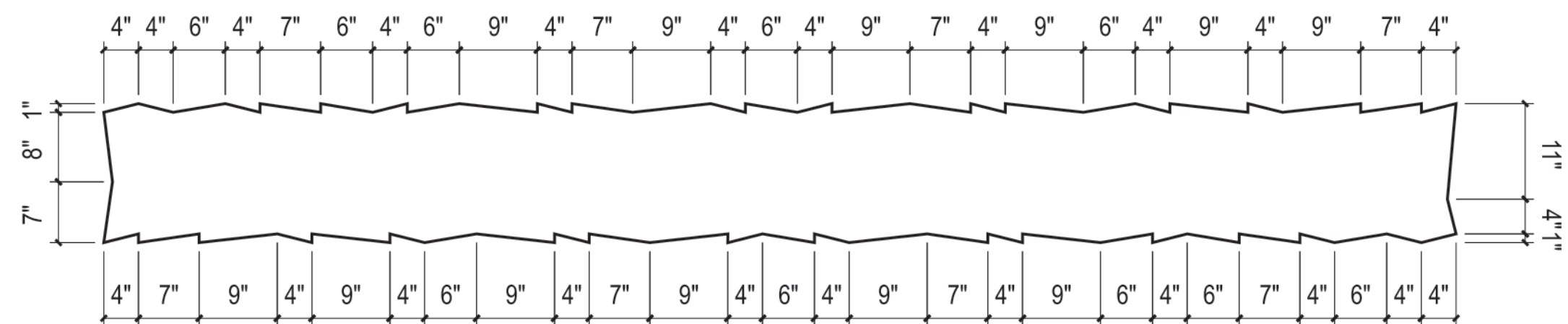
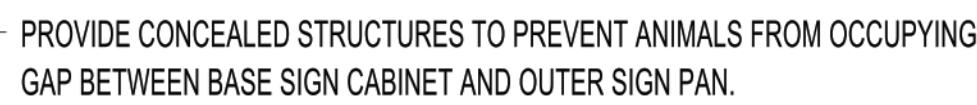
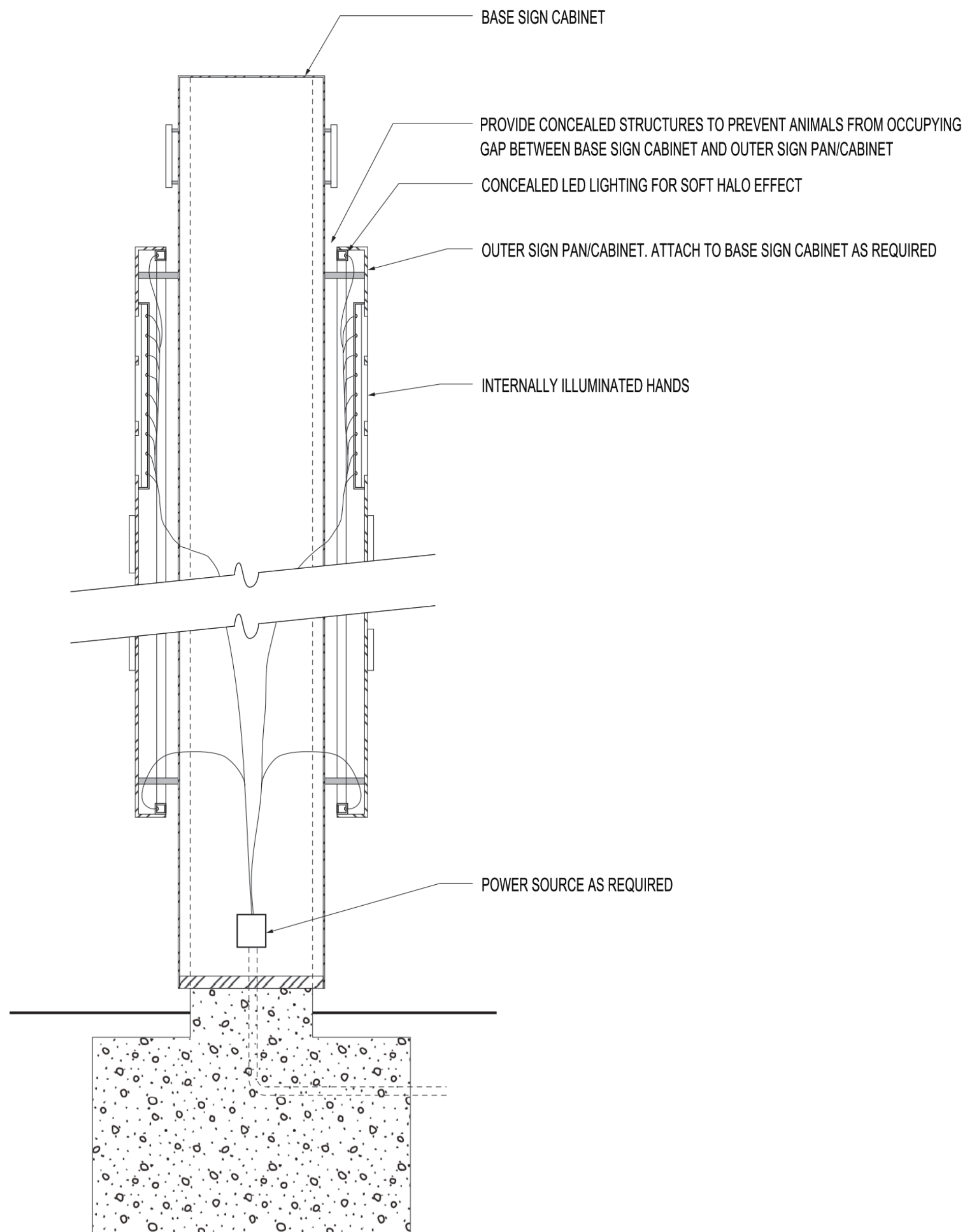
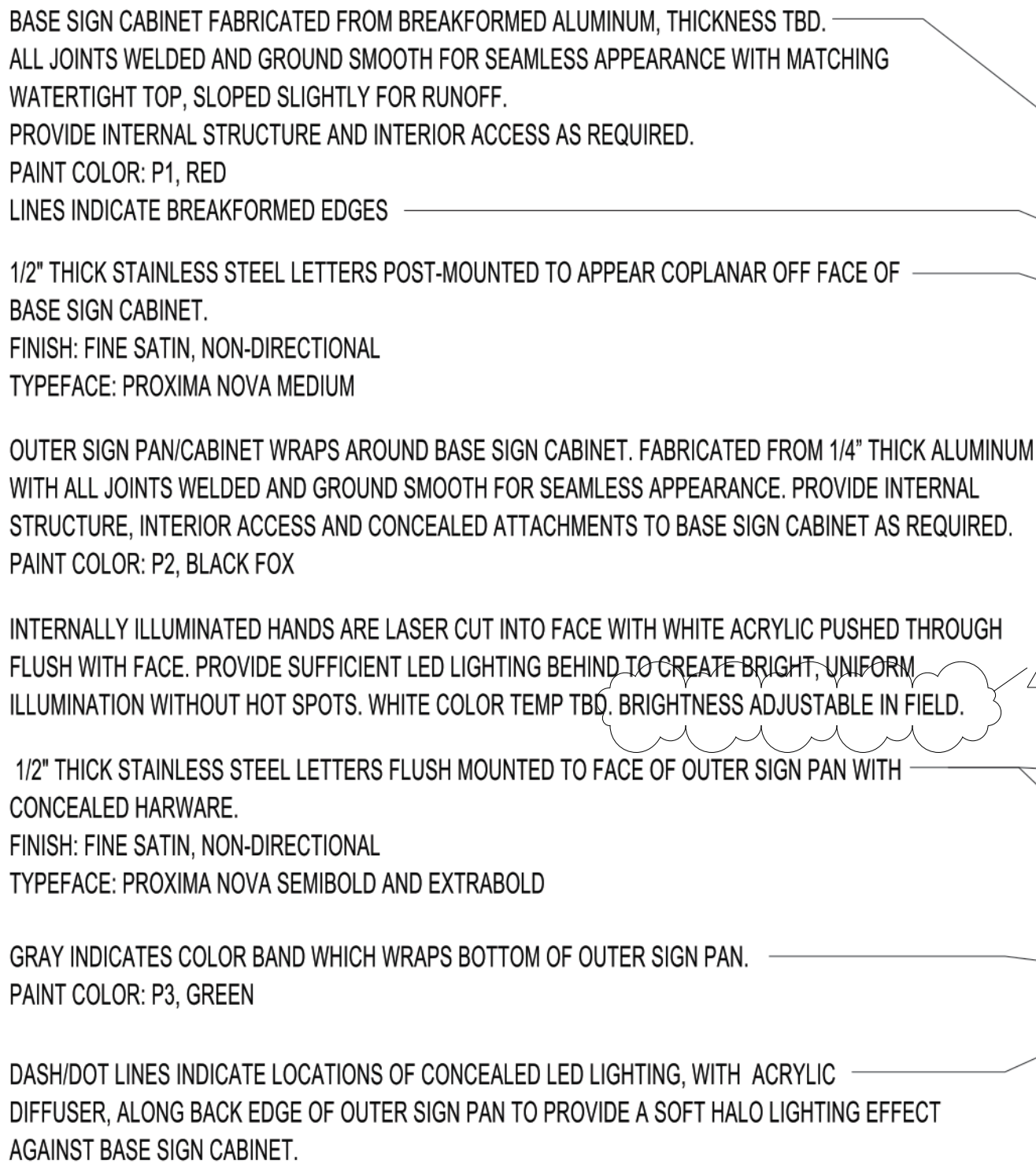





DESIGN PARTNER  
BC  
PROJECT MANAGER  
JL  
PROJECT ARCHITECT  
CH  
PROJECT DESIGNER  
JW  
PROJECT TEAM MEMBERS  
SK, SB, KK  
CHECK  
KB

ARCHITECT SEAL

PROJECT NO.  
**2122700**  
DATE  
**01/12/2024**

Proposal Request #24  
© 2022 MITHUN, INC.

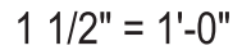
$$1\frac{1}{2}'' = 1'-0''$$

**4**       $1\frac{1}{2}" = 1'-0"$

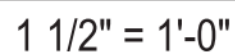

GENERAL NOTES:

1. PROVIDE SATIN FINISH CLEARCOAT OVER ALL PAINTED FINISHES AND CUT VINYL GRAPHICS

6" = 1'-0"

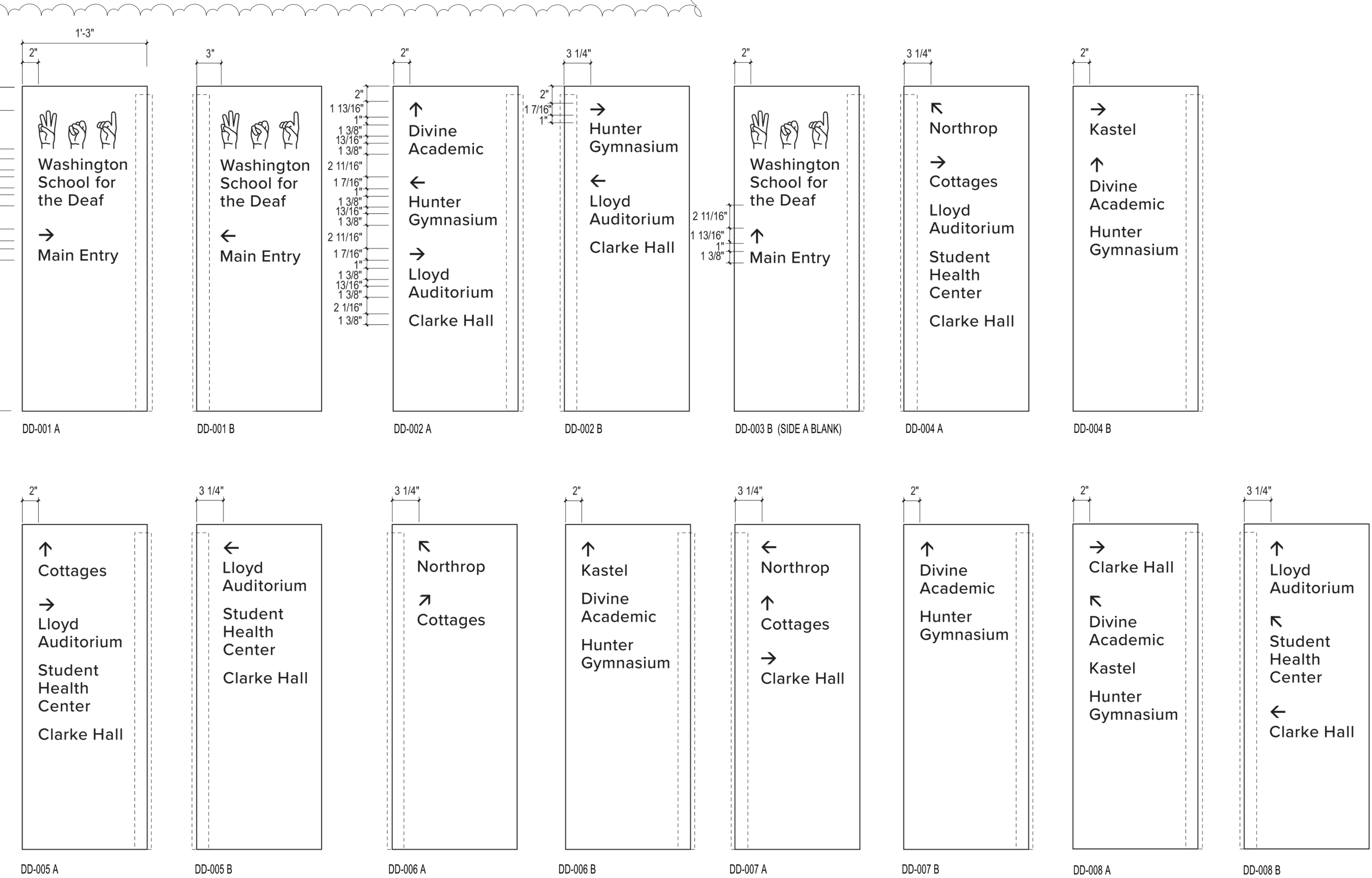

1 1/2" = 1'-0"

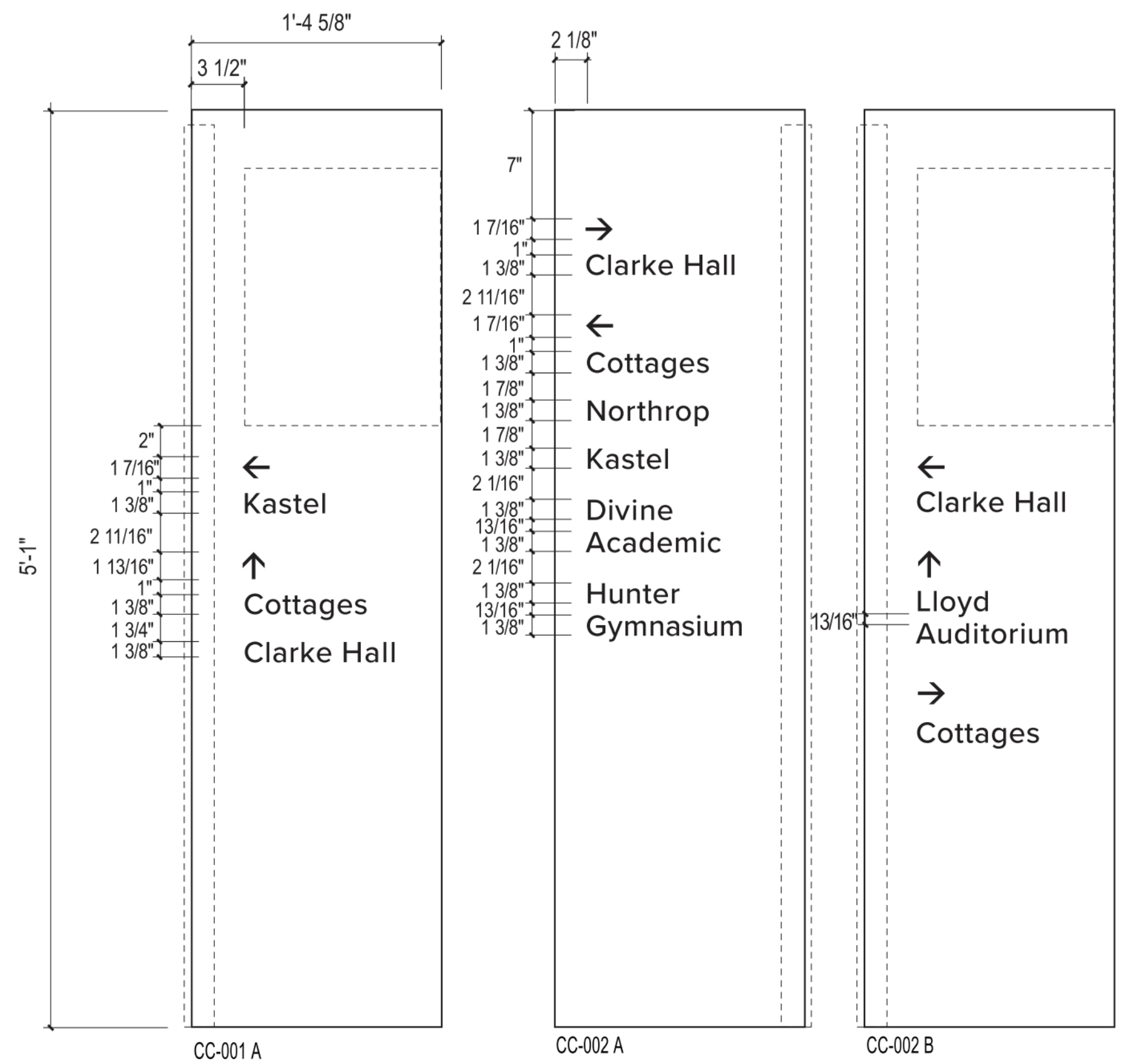

## 8

1 1/2" = 1'-0"

## 7







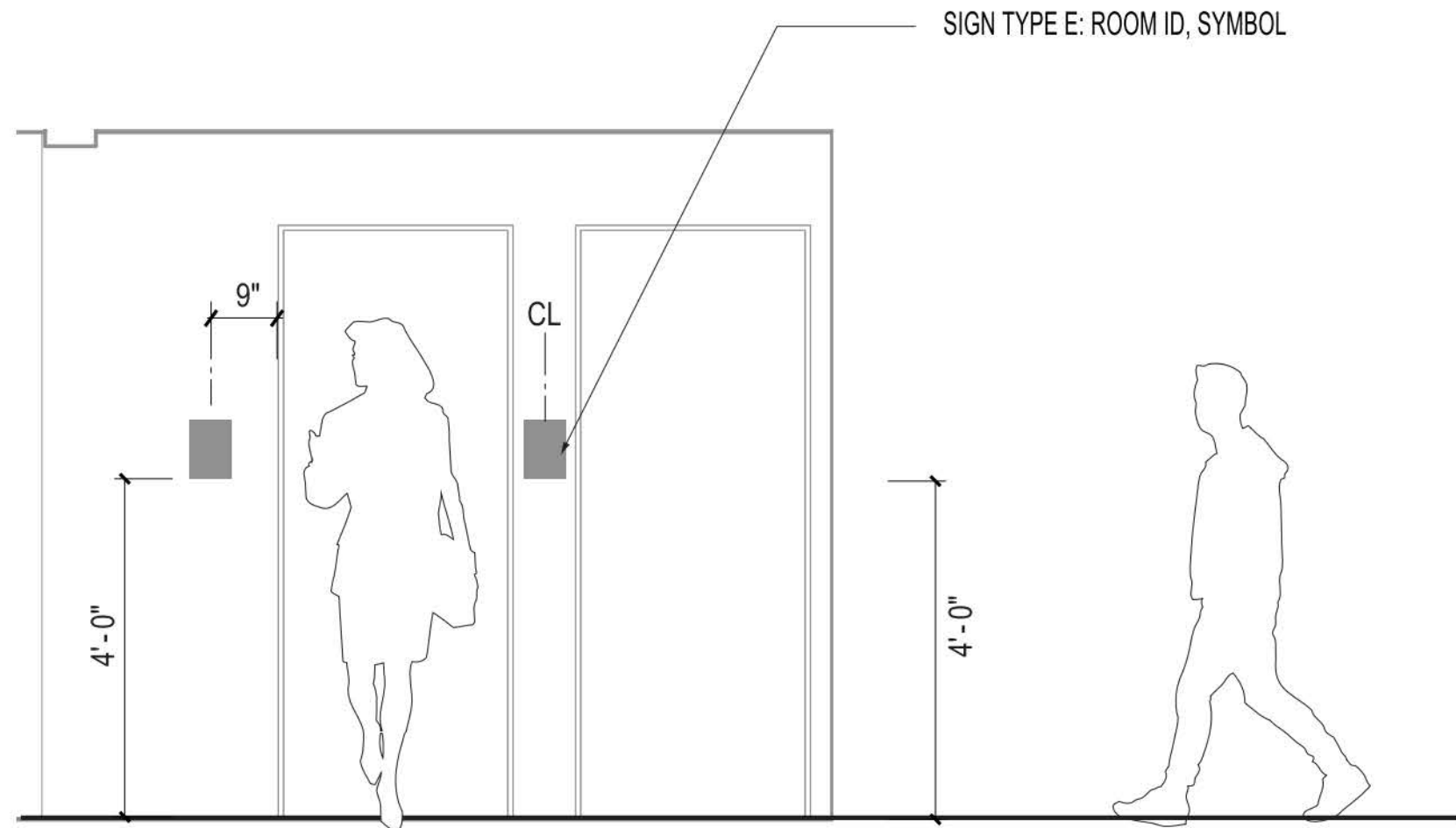

## 2 SIGN TYPE E - TYPICAL MOUNTING CONDITIONS

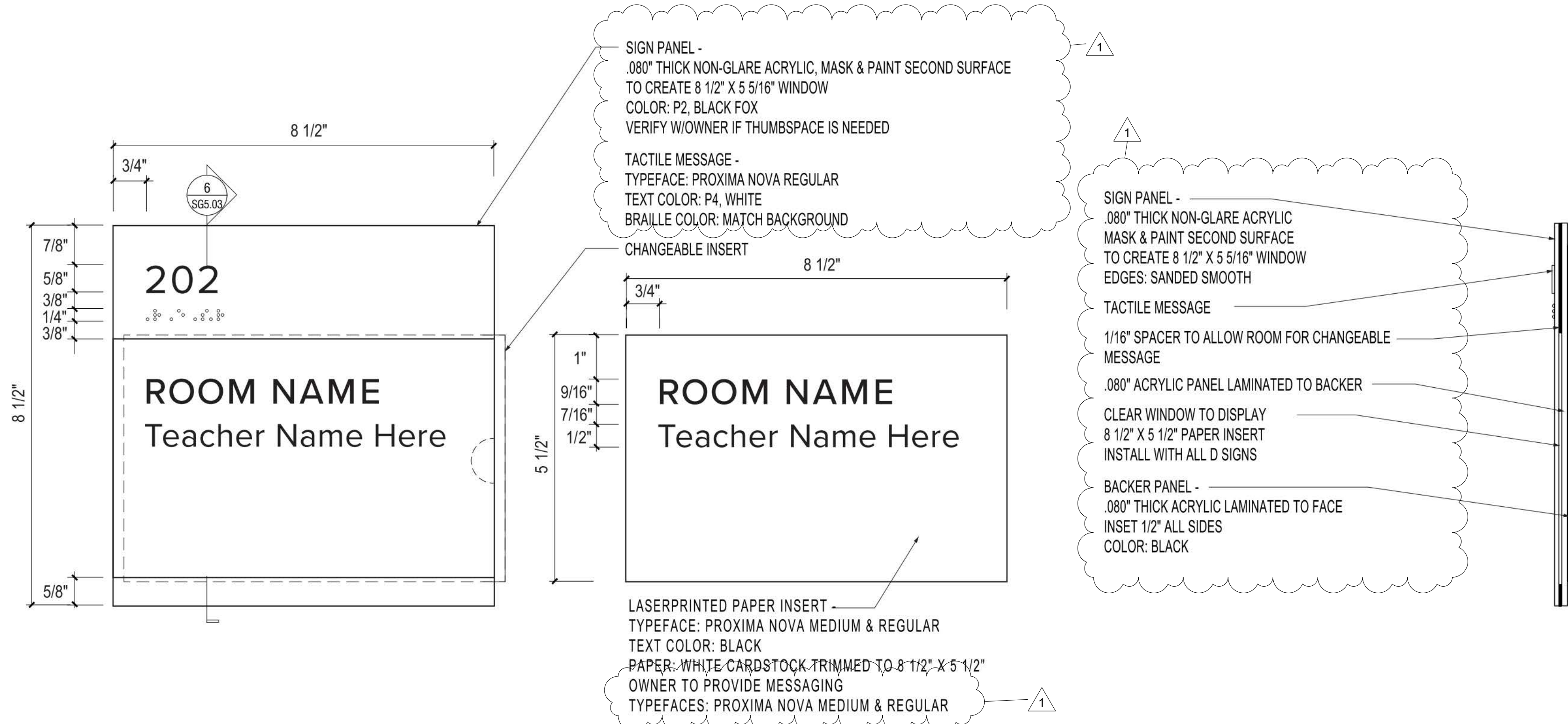

## 6 SIGN TYPE D - SECTION

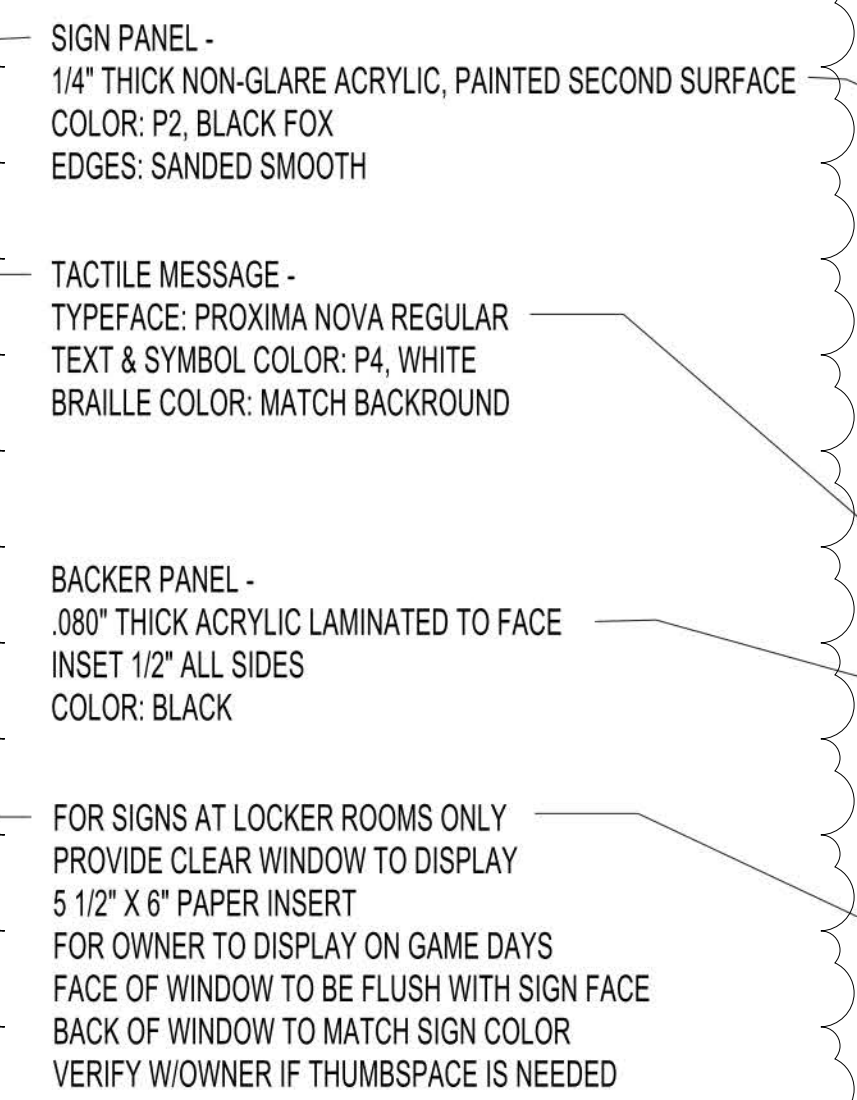

## 8 SIGN TYPE E - SECTION















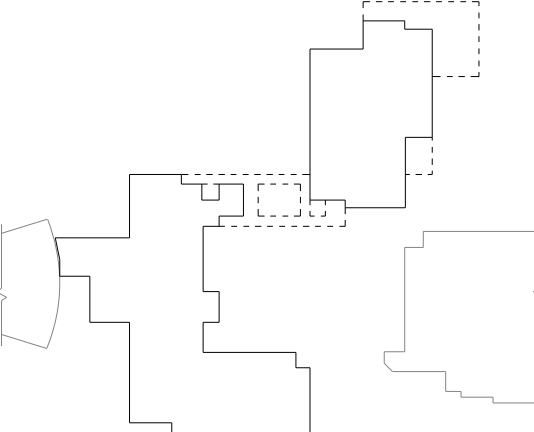

| NO. | DATE       | REVISION |
|-----|------------|----------|
| 4   | 04/09/2024 | PR-29    |

| DESIGN PARTNER       | BC         |
|----------------------|------------|
| PROJECT MANAGER      | JL         |
| PROJECT ARCHITECT    | CH         |
| PROJECT DESIGNER     | JW         |
| PROJECT TEAM MEMBERS | SK, SB, KK |
| CHECK                | KB         |
| ARCHITECT SEAL       |            |













FIELD VERIFY FINAL MOUNTING LOCATION WITH ARCHITECT BEFORE INSTALLATION  
ADJUSTMENTS MAY BE NECESSARY BASED ON PATCHES OR VISIBLE  
DISCOLORATIONS ON EXISTING WALL

INTENT IS FOR LETTERING TO STAY CLOSER TO TOP, RIGHT EDGE,  
BUT CONCERNED WALL DISCOLORATIONS MAY INTERFERE WITH LEGIBILITY

## 1 SIGN A-006: BUILDING ID - VIEW AT ADMIN WALL

10'- 5 3/8"

CDHY ADMINISTRATION

PRECISION CUT STAINLESS STEEL  
LETTERS: 3/4" THICK  
FINISH TO BE FINE SATIN, NON-DIRECTIONAL  
TYPEFACE: PROXIMA NOVA MEDIUM

ESTABLISHED 1886

7"

4 3/4"

4"

## 2 SIGN A-006: BUILDING ID - ELEVATION AT ADMIN WALL

3" = 1'-0"

MITHUN

SEATTLE / Pier 56, 1201 Alaskan Way, #200  
Seattle, WA 98101 / 206.623.3344

SAN FRANCISCO / 660 Market Street, #300  
San Francisco, CA 94104 / 415.396.0888

LOS ANGELES / 5037 Adams Blvd  
Culver City, CA 90232 / 323.837.2150

mithun.com

SKANSKA

PORTLAND / 1010 NW Flanders St., #500  
Portland, OR 97209 / 503.382.0900

usa.skanska.com

Mayer/Reed

Mayer/Reed, Inc.  
319 SW Washington St.  
Suite 820  
Portland, Oregon 97204  
503.223.5953

PROJECT

CDHY - ACADEMIC &  
PHYSICAL EDUCATION  
BUILDING

LOCATION

611 GRAND BLVD  
VANCOUVER, WA 98661

PREPARED FOR  
CENTER FOR DEAF AND  
HARD OF HEARING  
YOUTH (CDHY)

DSS PROJECT NO.  
2018-713



KEYMAP

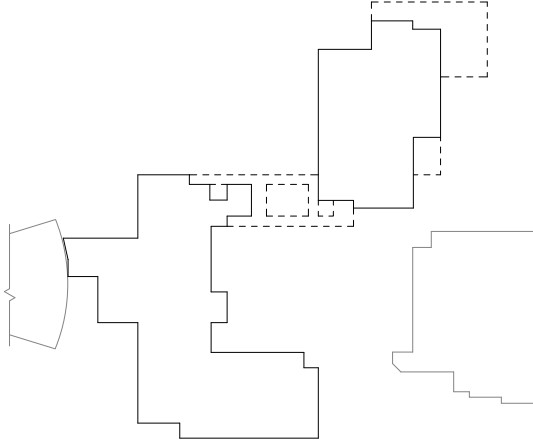

DATE

ISSUE

NO.

DATE

REVISION

6 05/17/2024

PR-34

DESIGN PARTNER

BC

PROJECT MANAGER

JL

PROJECT ARCHITECT

CH

PROJECT DESIGNER

JW

PROJECT TEAM MEMBERS

SK, SB, KK

CHECK

KB

ARCHITECT SEAL

TITLE

SIGNM DETAILS 11

PROJECT NO.

2122700

DATE

05/14/24

SHEET NUMBER

SG5.11

PROPOSAL REQUEST #34

© 2022 MITHUN, INC.



