

DEVICE LEGEND		
DEVICE	DESCRIPTION	QTY.
CR	CARD READER	4
DC	DOOR CONTACT	4
REX	REQUEST TO EXIT DEVICE W/ DOOR LOCKS	4
EL	ELECTRIFIED LOCK	4
PB	PANIC BUTTON	0
IC	INTERCOMS	0
FC	FIXED IP DOME COLOR CAMERA	5
PTZ	PTZ IP DOME COLOR CAMERA	0
ACP	ACCESS CONTROL PANEL	1
CCTV	CCTV HEAD END LOCATIONS	1
PS	PENETRATION SLEEVES	0

ACCESS CONTROL W/  
FIRE PROTECTION DOORS:

CARD READER #	DOOR #
CR-02	6.088.01
CR-03	6.116.03

DRAWING PREPARED BY:



1511 E. ORANGETHORPE BLVD.  
FULLERTON, CALIFORNIA 92831  
714-525-4350 - o; 714-525-4386 - f  
(c) Copyright 2012 KRATOS | HBE  
All Rights Reserved.

MUST BE SIGNED BY HBE  
TO AUTHENTICATE CONTENT(S).  
ALL DETAILS CHECKED FOR ACCURACY.

SIGNATURE \_\_\_\_\_ DATE \_\_\_\_\_

HBE JOB #

CONFIDENTIAL

THE INFORMATION CONTAINED HERIN MAY  
NOT BE USED OR REPRODUCED IN ANY  
MANNER WITHOUT WRITTEN PERMISSION OF  
KRATOS | HBE.

KEY PLAN

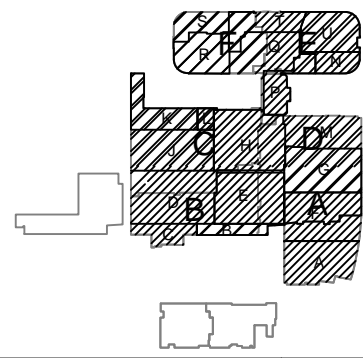

NO.	REV DESCRIPTION REV DATE	APPROVED BY
1.	AS BUILTS 08/15/2012	JOHN J. CHRISTIE

REV.	DESCRIPTION	APPROVED BY
------	-------------	-------------

CUSTOMER:



PROJECT:

CHOC CHILDREN'S  
HOSPITAL  
455 SOUTH MAIN ST.  
ORANGE, CA 92668

DRAWING TITLE:

SIXTH LEVEL  
SECURITY PLAN

DRN BY	DATE DRN	CHK BY	DATE CHK
JOSH G.	08/08/2012	JJC	
SCALE:	NTS		
DWG NO.	SE3.06		

ASBUILTS  
08/15/2012

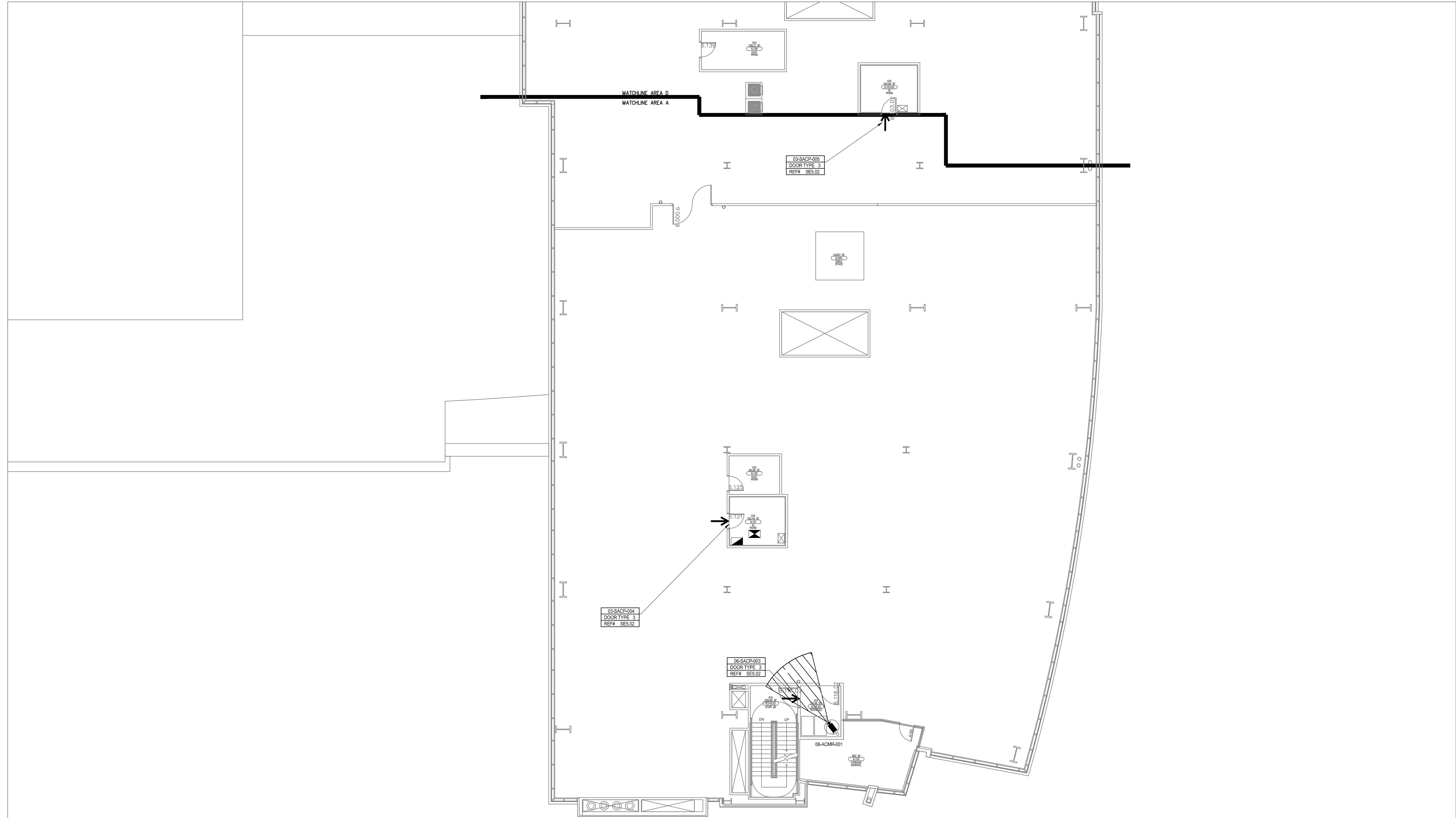

DEVICE LEGEND		
DEVICE	DESCRIPTION	QTY.
	CARD READER	3
	DOOR CONTACT	3
	REQUEST TO EXIT DEVICE W/ DOOR LOCKS	3
	ELECTRIFIED LOCK	3
	PANIC BUTTON	0
	INTERCOMS	0
	FIXED IP DOME COLOR CAMERA	1
	PTZ IP DOME COLOR CAMERA	0
	ACCESS CONTROL PANEL	1
	CCTV HEAD END LOCATIONS	1
	PENETRATION SLEEVES	0

ACCESS CONTROL W/  
FIRE PROTECTION DOORS:

CARD READER #	DOOR #
CR-02	6.088.01
CR-03	6.116.03

DRAWING PREPARED BY:



1511 E. ORANGETHORPE BLVD.  
FULLERTON, CALIFORNIA 92831  
714-525-4350 - o; 714-525-4386 - f  
(c) Copyright 2012 KRATOS | HBE  
All Rights Reserved.

MUST BE SIGNED BY HBE  
TO AUTHENTICATE CONTENT(S).  
ALL DETAILS CHECKED FOR ACCURACY.

SIGNATURE \_\_\_\_\_ DATE \_\_\_\_\_

HBE JOB #

CONFIDENTIAL

THE INFORMATION CONTAINED HERIN MAY  
NOT BE USED OR REPRODUCED IN ANY  
MANNER WITHOUT WRITTEN PERMISSION OF  
KRATOS | HBE.

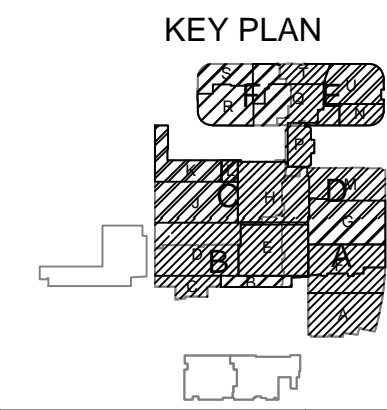

NO.	REV DESCRIPTION REV DATE	APPROVED BY
1.	AS BUILTS 08/15/2012	JOHN J. CHRISTIE

REV.	DESCRIPTION	APPROVED BY
------	-------------	-------------

CUSTOMER:



PROJECT:  
CHOC CHILDREN'S  
HOSPITAL  
455 SOUTH MAIN ST.  
ORANGE, CA 92668

DRAWING TITLE:  
SIXTH LEVEL  
SECURITY PLAN  
AREA A

DRN BY	DATE DRN	CHK BY	DATE CHK
JOSH G.	08/08/2012	JJC	
SCALE:	NTS		
DWG NO.	SE3.06A		

ASBUILTS  
08/15/2012

