

T1 LOWER LEVEL - TELECOM PLAN - OVERALL
1/16" = 1'-0"

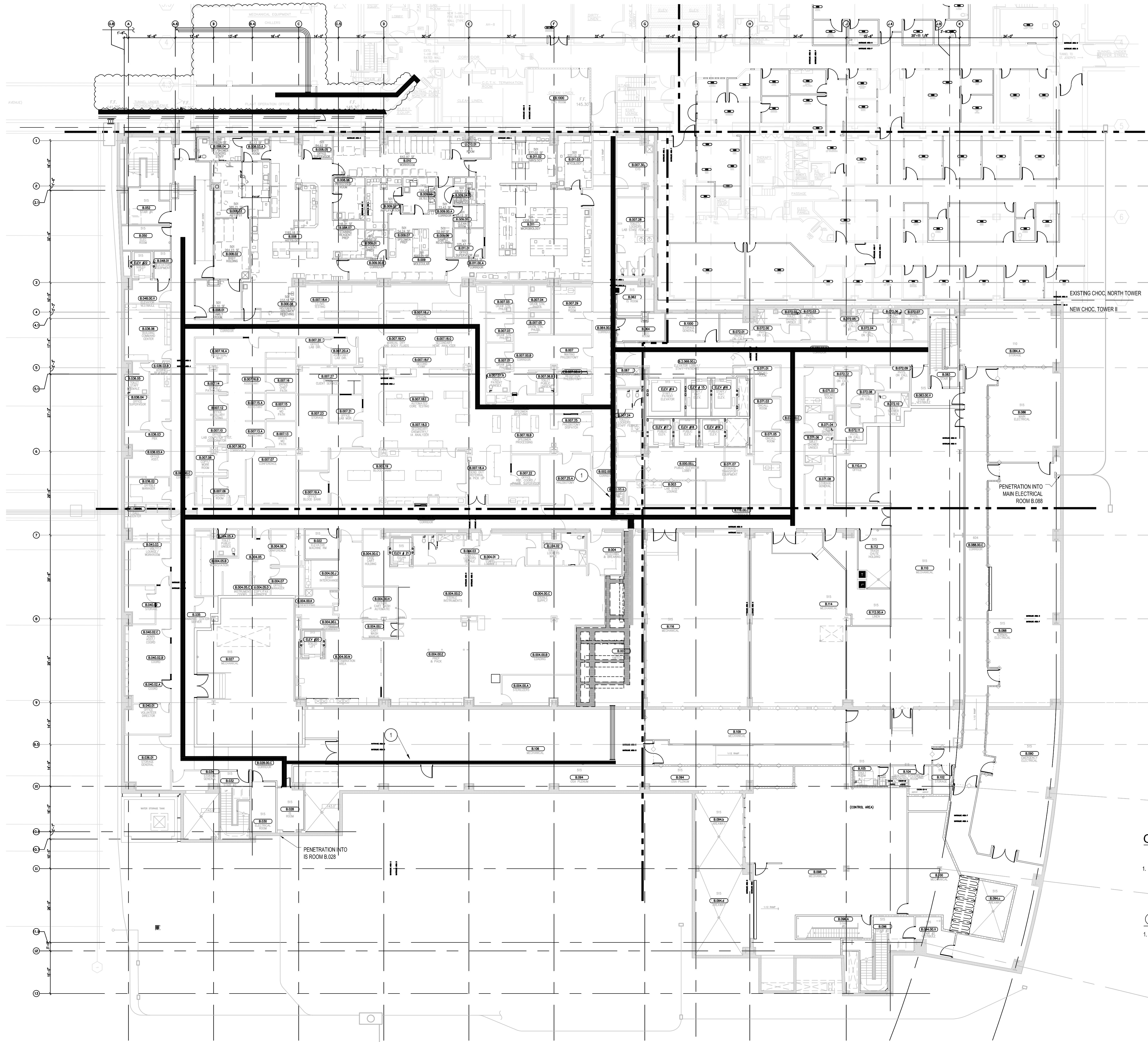

GENERAL SHEET NOTES

- THE DRAWINGS ARE DIAGRAMMATIC ONLY AND MAY NOT SHOW ALL COMPONENTS, MATERIALS, OFFSETS, BENDS, ELBOWS AND OTHER SPECIFIC ELEMENTS THAT MAY BE REQUIRED FOR A COMPLETE INSTALLATION. THE CONTRACTOR SHALL BE RESPONSIBLE FOR PROVIDING ALL MATERIALS NEEDED FOR A COMPLETE AND FUNCTIONAL INSTALLATION.

SHEET KEYNOTES

- SUPPORT CABLE RUNWAY AS REQUIRED TO SUPPORT 100 LBS/FT OF CABLE RUNWAY CONTENTS.

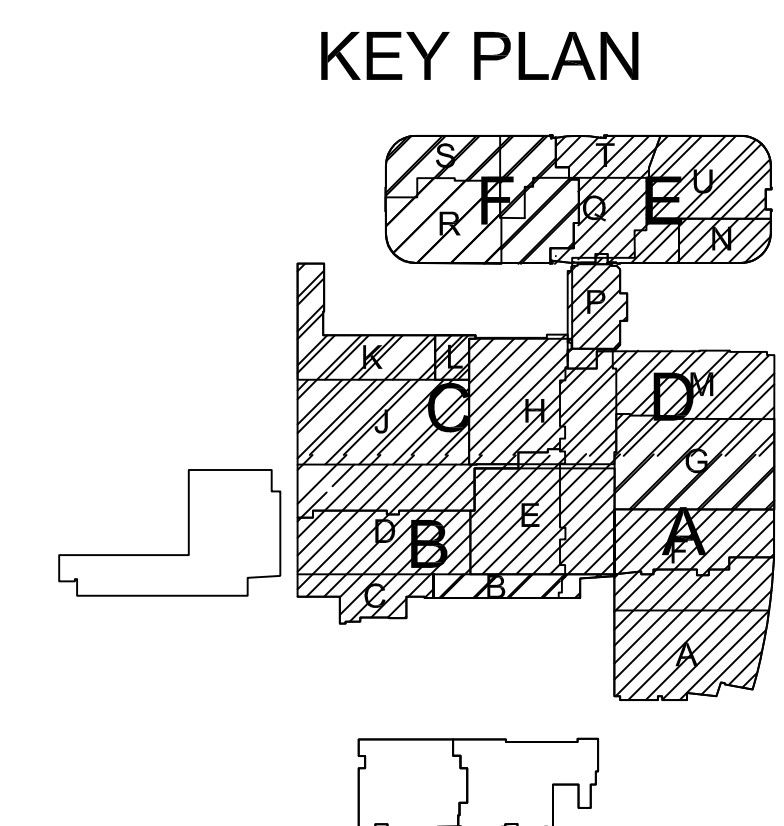

PROJECT: CHILDREN'S HOSPITAL
OF ORANGE COUNTY - TOWER II

ADDRESS: 455 South Main Street
Orange, CA 92668-3874

W.O. NO.: 12684

PROPRIETARY STATEMENT
THESE DRAWINGS AND DOCUMENTS HEREIN ATTACHED ARE THE PROPERTY OF BERGELECTRIC CORPORATION. ANY REUSE OR REPRODUCTION OF THESE DOCUMENTS WITHOUT WRITTEN PERMISSION OF BERGELECTRIC CORPORATION IS STRICTLY FORBIDDEN. ALL RIGHTS RESERVED.

DRAWN BY:
J. RAMIREZ

DESIGN SUPERVISOR:

INSTALL SUPERVISOR:

Scott Adams
Tel Data Systems
Bergelectric Corporation
650 Upper Street
Escondido, CA 92029

REVISION:

05-30-12 RECORD DRAWINGS

SHEET TITLE:

TELECOM
FLOOR PLAN
LOWER LEVEL
OVERALL

SCALE:

1/16"=1'-0"

DRAWING NO.:

T3.0
RECORD
DRAWING

Bergelectric Corp.
Contractors & Engineers

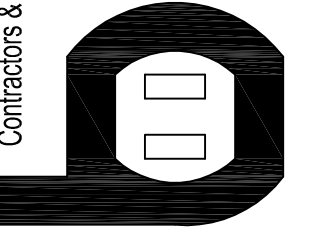

HC10-485046
650 UPPER ST.
ESCONDIDO, CA 92029
(760) 745-1033
FAX (760) 745-4619

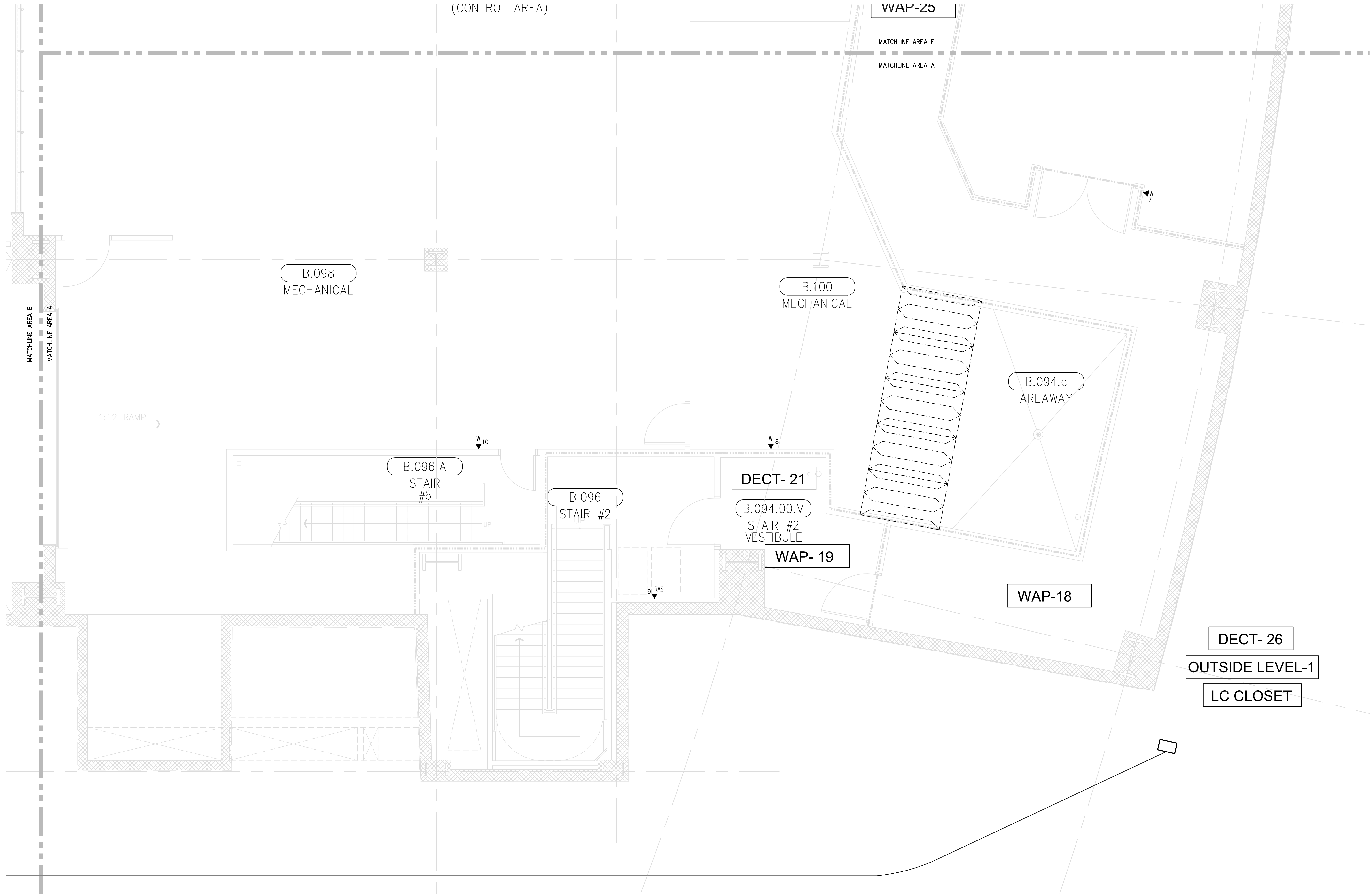

SHEET KEYNOTES

- 12"W X 6"H CABLE RUNWAY
- 24"W X 6"H CABLE RUNWAY
- 18"W X 6"H CABLE RUNWAY
- 1" EMT
- SURFACE MOUNT BACKBOX ONTO WALL/CEILING

GENERAL SHEET NOTES

- THE DRAWINGS ARE DIAGRAMMATIC ONLY AND MAY NOT SHOW ALL COMPONENTS, MATERIALS, OFFSETS, BENDS, ELBOWS AND OTHER SPECIFIC ELEMENTS THAT MAY BE REQUIRED FOR A COMPLETE INSTALLATION. THE CONTRACTOR SHALL BE RESPONSIBLE FOR PROVIDING ALL MATERIALS NEEDED FOR A COMPLETE AND FUNCTIONAL INSTALLATION.
- ELECTRIC EQUIPMENT AND DEVICES (E.G. PBX, NETWORK SWITCHES) ARE SHOWN FOR REFERENCE ONLY.
- REFER TO ARCHITECTURAL DETAIL PLANS FOR FINAL PATIENT ROOM DEVICE LOCATIONS. REFER TO ARCHITECTURAL DETAILS FOR OVERCOUNTER WAO HEIGHTS. REFER TO ARCHITECTURAL DETAILS FOR WALL-MOUNT WAO HEIGHTS.
- HORIZONTAL DATA/VOICE/VIDEO CABLE SHALL TERMINATE IN THE TECHNOLOGY ROOM ON THE SAME FLOOR AS THE WORK AREA OUTLETS.
- WORK AREA OUTLETS SHALL CONSIST OF SINGLE PLASTER REDUCING RINGS INSTALLED ON OVERSIZE DOUBLE GANG BACKBOXES, UNLESS OTHERWISE NOTED.
- TV COAX CABLES SHALL BE COILED IN THE RESPECTIVE TECHNOLOGY ROOMS WITH A 20' SERVICE LOOP PRIOR TO TERMINATIONS. COILS SHALL BE SECURED TO THE AUDIOVISUAL WALL FIELD FOR AV CONTRACTOR.
- COMMON LOW VOLTAGE CABLE RUNWAY IS 24" W X 6" HIGH. PROVIDE ALL MATERIALS AS NEEDED FOR A COMPLETE, MANUFACTURER-APPROVED SYSTEM USING CABLE TRAY MANUFACTURERS MATERIALS AND PARTS WHEN AVAILABLE FROM THE MANUFACTURER AND AS INTENDED. REFER TO DRAWING T4.01 FOR DETAILS. ALL CHANGES IN DIRECTION AND INTERSECTIONS SHALL USE PRE-MANUFACTURED OR FIELD-INSTALLED SWEEPS AND TEES. ALL SWEEPS AND TEES SHALL MAINTAIN A 1 FOOT MINIMUM RADIUS IN CHANGES OF DIRECTION.
- CABLE TRAY SHALL NOT PENETRATE WALLS. PROVIDE TRANSITION FROM CABLE TRAY TO LISTED FIRESTOP ASSEMBLIES IN ORDER TO PENETRATE FIRE/SMOKE WALLS. TRANSITION TO 4" CONDUITS/SLEEVES FOR NON-RATED WALLS. PROVIDE SUFFICIENT CONDUITS/SLEEVES TO ACCOMMODATE 100% VISUAL CABLE TRAY LOAD AT 50% VISUAL CONDUIT FILL.
- REFER TO ELECTRICAL DRAWINGS & SPECIFICATIONS FOR SHARED FLOOR BOXES & LOW VOLTAGE CONDUIT.
- PROVIDE BRACING TO MEET OSHPD SEISMIC REQUIREMENTS. REFER TO SHEET T4.02 FOR MORE INFORMATION.
- PROVIDE ALL OUTLET CONDUITS FROM WORK AREA OUTLETS, DEVICES OR PULL BOXES TO NEAREST CABLE TRAY.
- INSTALL CABLE TRAY @ 6" ABOVE CEILING.

KEY PLAN

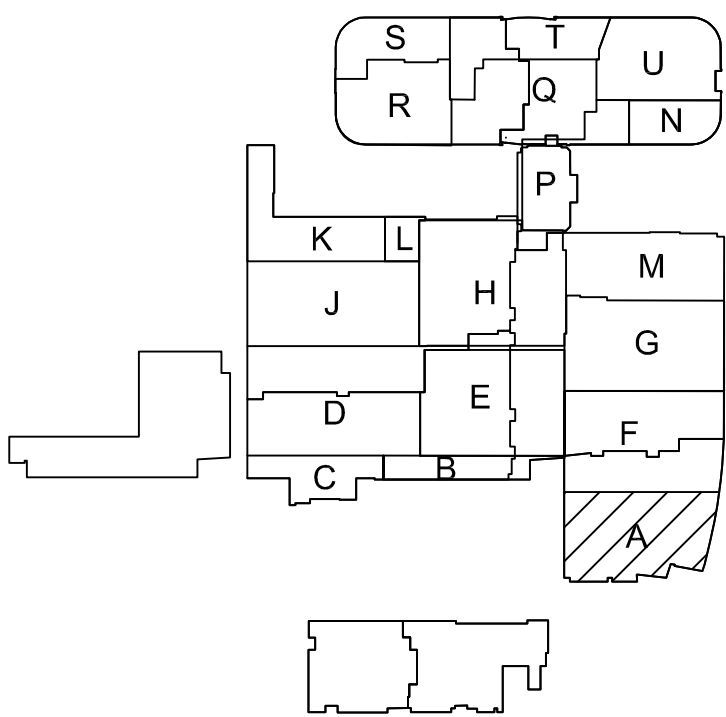

T3 LOWER LEVEL - TELECOM PLAN - AREA - A
1/4" = 1'-0"

Bergelectric Corp.
Contractors & Engineers

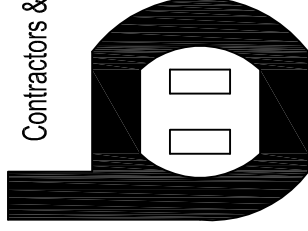

#C10-485048
650 UPPER ST.
ESCONDIDO, CA 92029
(760) 746-1033
FAX (760) 746-4619

PROJECT: **CHILDREN'S HOSPITAL
OF ORANGE COUNTY - TOWER II**

ADDRESS: 455 South Main Street
Orange, CA 92668-3874
W.O. NO.: 12684

PROPRIETARY STATEMENT
THESE DRAWINGS AND DOCUMENTS HEREON ATTACHED ARE THE
PROPERTY OF BERGELECTRIC CORPORATION. ANY REUSE OR
REPRODUCTION OF THESE DOCUMENTS WITHOUT WRITTEN
PERMISSION OF BERGELECTRIC CORPORATION IS STRICTLY
FORBIDDEN. ALL RIGHTS RESERVED.

DRAWN BY:
J. RAMIREZ

DESIGN SUPERVISOR:

INSTALL SUPERVISOR:

Scott Adams
Tel Data Systems
Bergelectric Corporation
650 Upper Street
Escondido, CA 92029

REVISIONS:

05-30-12 RECORD DRAWINGS

SHEET TITLE:

TELECOM
FLOOR PLAN
LOWER LEVEL
AREA-A

SCALE:

1/4"=1'0"

DRAWING NO.:

T3.0A
RECORD
DRAWING

Bergelectric Corp.
Contractors & Engineers

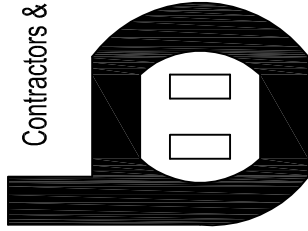

HC10-485048
650 UPPER ST.
ESCONDIDO, CA 92029
(760) 742-1033
FAX (760) 742-4619

PROJECT: **CHILDREN'S HOSPITAL
OF ORANGE COUNTY - TOWER II**

ADDRESS: 455 South Main Street
Orange, CA 92668-3874
W.O. NO.: 12684

PROPRIETARY STATEMENT
THESE DRAWINGS AND DOCUMENTS HEREON ATTACHED ARE THE
PROPERTY OF BERGELECTRIC CORPORATION ANY REUSE OR
REPRODUCTION OF THESE DOCUMENTS WITHOUT WRITTEN
PERMISSION OF BERGELECTRIC CORPORATION IS STRICTLY
FORBIDDEN. ALL RIGHTS RESERVED.

DRAWN BY:
J.RAMIREZ

DESIGN SUPERVISOR:

INSTALL SUPERVISOR:
Scott Adams
Tel Data Systems
Bergelectric Corporation
650 Upper Street
Escondido, CA 92029

REVISION:
05-30-12 RECORD DRAWINGS

SHEET TITLE:

**TELECOM
FLOOR PLAN
LOWER LEVEL
AREA-B**

SCALE:
1/4"=1'0"

DRAWING NO.:

**T3.0B
RECORD
DRAWING**

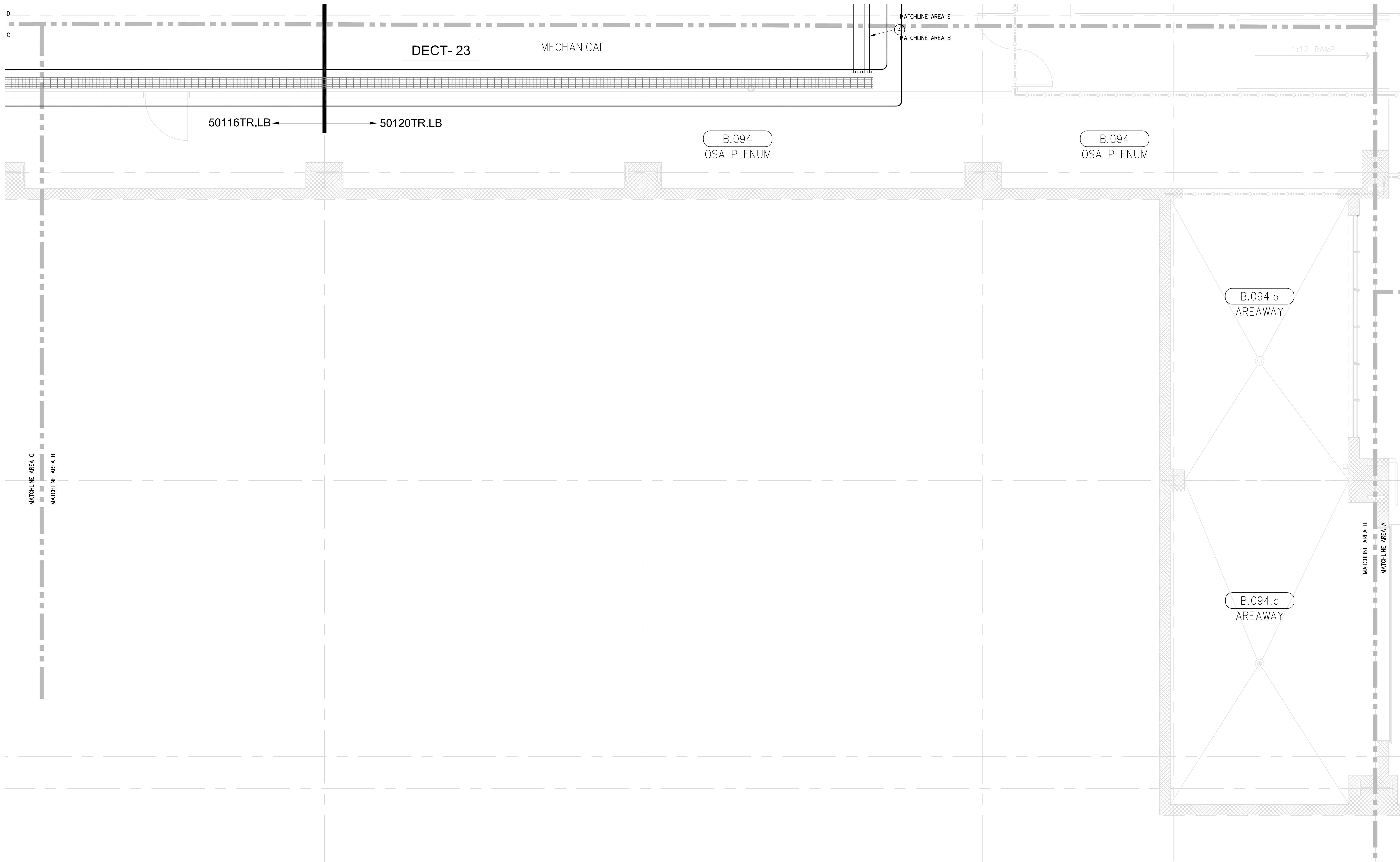

SHEET KEYNOTES

- 12"W X 6"H CABLE RUNWAY
- 24"W X 6"H CABLE RUNWAY
- 18"W X 6"H CABLE RUNWAY
- TWELVE (12) 4" CONDUITS AT 10" O.C. A.F.F. OR AS COORDINATED WITH OTHER TRADES.
- MOUNT OUTLET TO SIDE OF TRAY AND WIRELESS DECT ACCESS POINT TO BOTTOM OF TRAY. SEE DETAIL 101 T4.03

GENERAL SHEET NOTES

- THE DRAWINGS ARE DIAGRAMMATIC ONLY AND MAY NOT SHOW ALL COMPONENTS, MATERIALS, OFFSETS, BENDS, ELBOWS AND OTHER SPECIFIC ELEMENTS THAT MAY BE REQUIRED FOR A COMPLETE INSTALLATION. THE CONTRACTOR SHALL BE RESPONSIBLE FOR PROVIDING ALL MATERIALS NEEDED FOR A COMPLETE AND FUNCTIONAL INSTALLATION.
- ELECTRIC EQUIPMENT AND DEVICES (E.G. PBX, NETWORK SWITCHES) ARE SHOWN FOR REFERENCE ONLY.
- REFER TO ARCHITECTURAL DETAIL PLANS FOR FINAL PATIENT ROOM DEVICE LOCATIONS. REFER TO ARCHITECTURAL DETAILS FOR OVERCOUNTER WAO HEIGHTS. REFER TO ARCHITECTURAL DETAILS FOR WALL-MOUNT WAO HEIGHTS.
- HORIZONTAL DATA/VOICE/VIDEO CABLE SHALL TERMINATE IN THE TECHNOLOGY ROOM ON THE SAME FLOOR AS THE WORK AREA OUTLETS.
- WORK AREA OUTLETS SHALL CONSIST OF SINGLE PLASTER REDUCING RINGS INSTALLED ON OVERSIZE DOUBLE GANG BACKBOXES, UNLESS OTHERWISE NOTED.
- TV COAX CABLES SHALL BE COILED IN THE RESPECTIVE TECHNOLOGY ROOMS WITH A 20' SERVICE LOOP PRIOR TO TERMINATIONS. COILS SHALL BE SECURED TO THE AUDIOVISUAL WALL FIELD FOR AV CONTRACTOR.
- COMMON LOW VOLTAGE CABLE RUNWAY IS 24" W X 6" HIGH. PROVIDE ALL MATERIALS AS NEEDED FOR A COMPLETE, MANUFACTURER-APPROVED SYSTEM USING CABLE TRAY MANUFACTURERS' MATERIALS AND PARTS WHEN AVAILABLE FROM THE MANUFACTURER AND AS INTENDED. REFER TO DRAWING T4.01 FOR DETAILS. ALL CHANGES IN DIRECTION AND INTERSECTIONS SHALL USE PRE-MANUFACTURED OR FIELD-INSTALLED SWEEPS AND TEES. ALL SWEEPS AND TEES SHALL MAINTAIN A 1 FOOT MINIMUM RADIUS IN CHANGES OF DIRECTION.
- CABLE TRAY SHALL NOT PENETRATE WALLS. PROVIDE TRANSITION FROM CABLE TRAY TO LISTED FIRESTOP ASSEMBLIES IN ORDER TO PENETRATE FIRE-SMOKE WALLS. TRANSITION TO 4" CONDUITS/SLEEVES FOR NON-RATED WALLS. PROVIDE SUFFICIENT CONDUITS/SLEEVES TO ACCOMMODATE 100% VISUAL CABLE TRAY LOAD AT 50% VISUAL CONDUIT FILL.
- REFER TO ELECTRICAL DRAWINGS & SPECIFICATIONS FOR SHARED FLOOR BOXES & LOW VOLTAGE CONDUIT.
- PROVIDE BRACING TO MEET OSHPD SEISMIC REQUIREMENTS. REFER TO SHEET T4.02 FOR MORE INFORMATION.
- PROVIDE ALL OUTLET CONDUITS FROM WORK AREA OUTLETS, DEVICES OR PULL BOXES TO NEAREST CABLE TRAY.
- INSTALL CABLE TRAY @ 8" ABOVE CEILING.

KEY PLAN

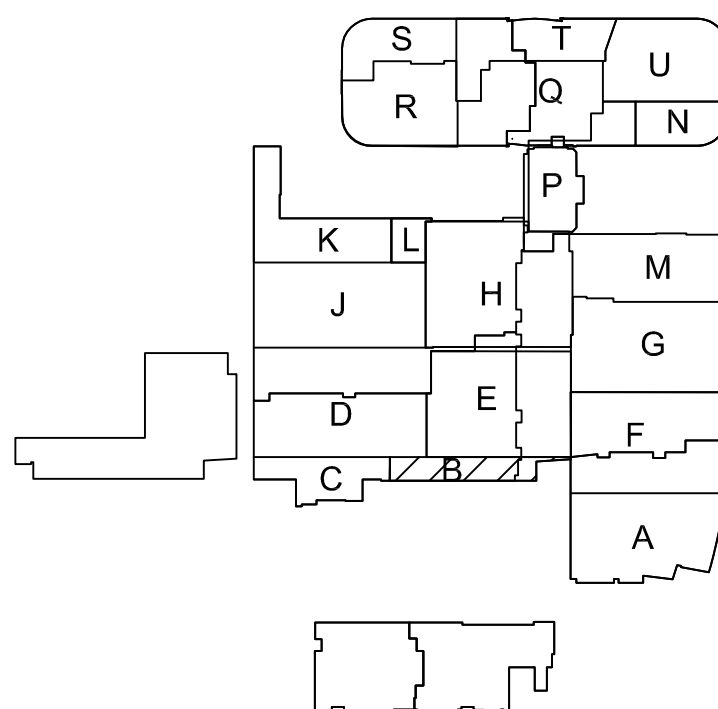

T3 LOWER LEVEL - TELECOM PLAN - AREA-B

1/4" = 1'0"

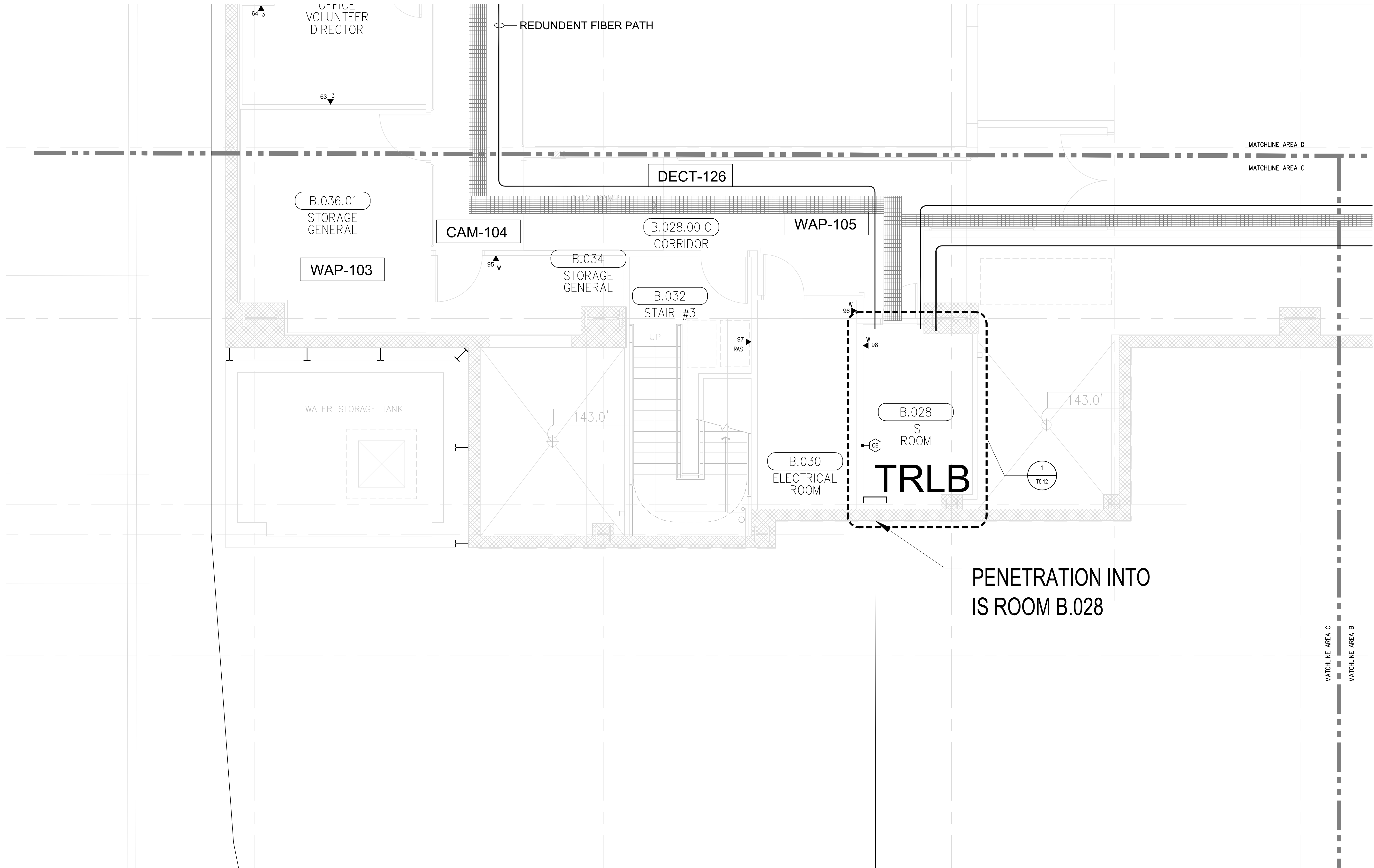

SHEET KEYNOTES

- 12"W X 6"H CABLE RUNWAY
- 24"W X 6"H CABLE RUNWAY
- 18"W X 6"H CABLE RUNWAY
- COORDINATE LOCATION, ELEVATION, AND SLEEVE COUNT WITH DRAWING T1.10.

GENERAL SHEET NOTES

- THE DRAWINGS ARE DIAGRAMMATIC ONLY AND MAY NOT SHOW ALL COMPONENTS, MATERIALS, OFFSETS, BENDS, ELBOWS AND OTHER SPECIFIC ELEMENTS THAT MAY BE REQUIRED FOR A COMPLETE INSTALLATION. THE CONTRACTOR SHALL BE RESPONSIBLE FOR PROVIDING ALL MATERIALS NEEDED FOR A COMPLETE AND FUNCTIONAL INSTALLATION.
- ELECTRIC EQUIPMENT AND DEVICES (E.G. PBX, NETWORK SWITCHES) ARE SHOWN FOR REFERENCE ONLY.
- REFER TO ARCHITECTURAL DETAIL PLANS FOR FINAL PATIENT ROOM DEVICE LOCATIONS. REFER TO ARCHITECTURAL DETAILS FOR OVERCOUNTER WAO HEIGHTS. REFER TO ARCHITECTURAL DETAILS FOR WALL-MOUNT WAO HEIGHTS.
- HORIZONTAL DATA/VOICE/VIDEO CABLE SHALL TERMINATE IN THE TECHNOLOGY ROOM ON THE SAME FLOOR AS THE WORK AREA OUTLETS.
- WORK AREA OUTLETS SHALL CONSIST OF SINGLE PLASTER REDUCING RINGS INSTALLED ON OVERSIZE DOUBLE GANG BACKBOXES, UNLESS OTHERWISE NOTED.
- TV COAX CABLES SHALL BE COILED IN THE RESPECTIVE TECHNOLOGY ROOMS WITH A 20' SERVICE LOOP PRIOR TO TERMINATIONS. COILS SHALL BE SECURED TO THE AUDIOVISUAL WALL FIELD FOR AV CONTRACTOR.
- COMMON LOW VOLTAGE CABLE RUNWAY IS 24" W X 6" HIGH. PROVIDE ALL MATERIALS AS NEEDED FOR A COMPLETE, MANUFACTURER-APPROVED SYSTEM USING CABLE TRAY MANUFACTURERS' MATERIALS AND PARTS WHEN AVAILABLE FROM THE MANUFACTURER AND AS INTENDED. REFER TO DRAWING T4.01 FOR DETAILS. ALL CHANGES IN DIRECTION AND INTERSECTIONS SHALL USE PRE-MANUFACTURED OR FIELD-INSTALLED SWEEPS AND TEES. ALL SWEEPS AND TEES SHALL MAINTAIN A 1' FOOT MINIMUM RADIUS IN CHANGES OF DIRECTION.
- CABLE TRAY SHALL NOT PENETRATE WALLS. PROVIDE TRANSITION FROM CABLE TRAY TO LISTED FIRESTOP ASSEMBLIES IN ORDER TO PENETRATE FIRE/SMOKE WALLS. TRANSITION TO 4" CONDUITS/SLEEVES FOR NON-RATED WALLS. PROVIDE SUFFICIENT CONDUITS/SLEEVES TO ACCOMMODATE 100% VISUAL CABLE TRAY LOAD AT 60% VISUAL CONDUIT FILL.
- REFER TO ELECTRICAL DRAWINGS & SPECIFICATIONS FOR SHARED FLOOR BOXES & LOW VOLTAGE CONDUIT.
- PROVIDE BRACING TO MEET OSHPD SEISMIC REQUIREMENTS. REFER TO SHEET T4.02 FOR MORE INFORMATION.
- PROVIDE ALL OUTLET CONDUITS FROM WORK AREA OUTLETS, DEVICES OR PULL BOXES TO NEAREST CABLE TRAY.
- INSTALL CABLE TRAY @ 8' ABOVE CEILING.

KEY PLAN

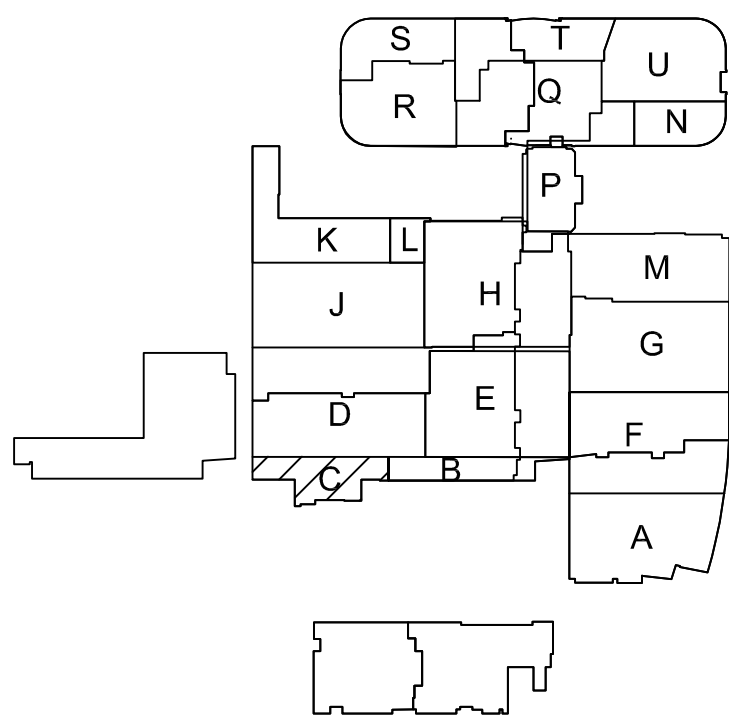

T3 LOWER LEVEL - TELECOM PLAN - AREA-C
1/4" = 1'-0"

Bergelectric Corp.
Contractors & Engineers

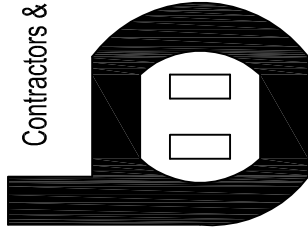

#C10-485048
650 OPPER ST.
ESCONDIDO, CA 92029
(760) 746-1033
FAX (760) 746-4619

PROJECT: CHILDREN'S HOSPITAL
OF ORANGE COUNTY - TOWER II

ADDRESS: 455 South Main Street
Orange, CA 92668-3874

W.O. NO.: 12684

PROPRIETARY STATEMENT
THESE DRAWINGS AND DOCUMENTS HEREON ATTACHED ARE THE
PROPERTY OF BERGELECTRIC CORPORATION ANY REUSE OR
REPRODUCTION OF THESE DOCUMENTS WITHOUT WRITTEN
PERMISSION OF BERGELECTRIC CORPORATION IS STRICTLY
FORBIDDEN. ALL RIGHTS RESERVED.

DRAWN BY:
J. RAMIREZ

DESIGN SUPERVISOR:

INSTALL SUPERVISOR:

Scott Adams
Tel Data Systems
Bergelectric Corporation
650 Oppen Street
Escondido, CA 92029

REVISIONS:

05-30-12 RECORD DRAWINGS

SHEET TITLE:

**TELECOM
FLOOR PLAN
LOWER LEVEL
AREA-C**

SCALE:

1/4"=1'0"

DRAWING NO.:

**T3.0C
RECORD
DRAWING**

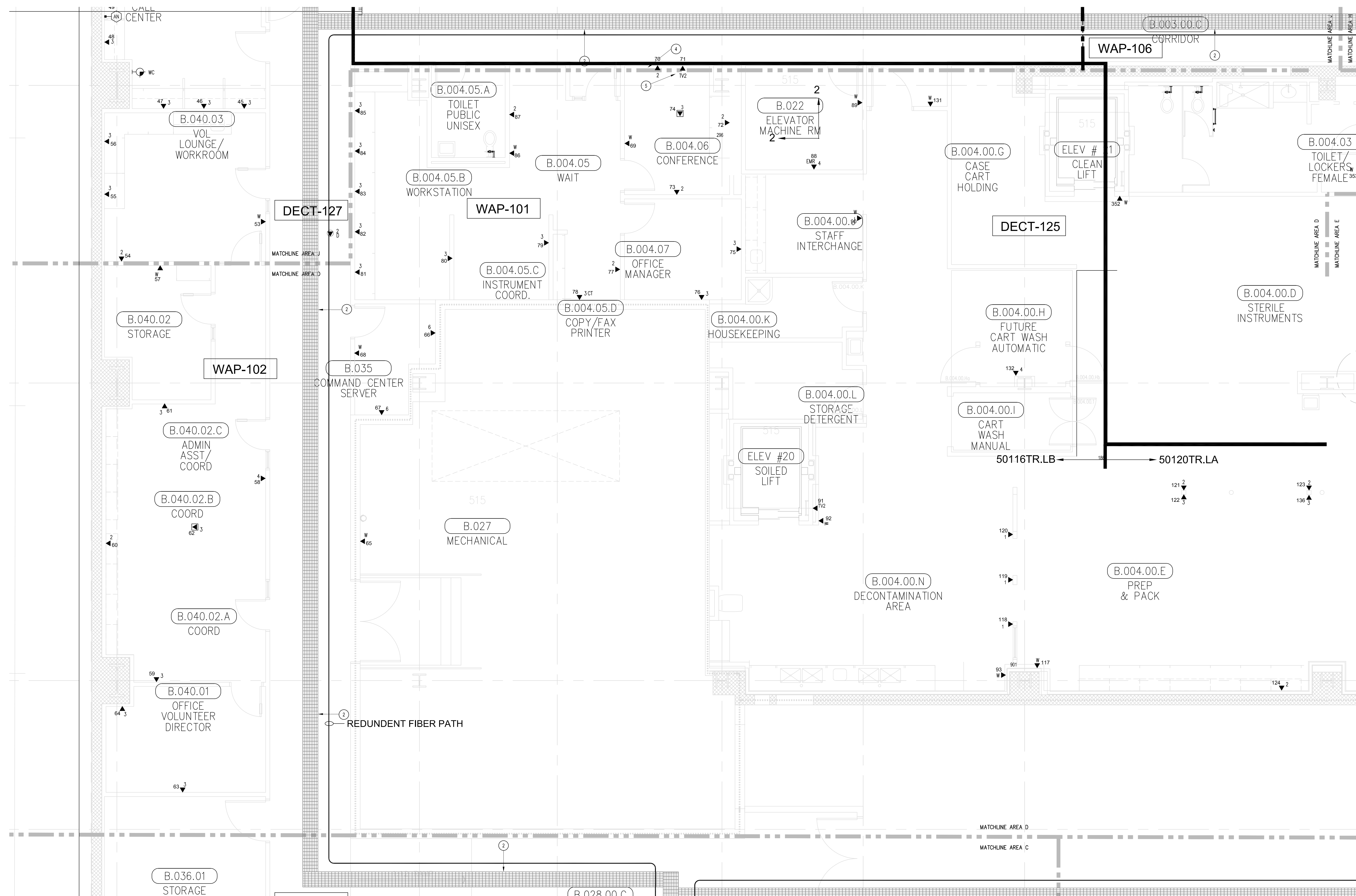

SHEET KEYNOTES

- 12"W X 6"H CABLE RUNWAY
- 24"W X 6"H CABLE RUNWAY
- 18"W X 6"H CABLE RUNWAY
- MOUNT WAD IN DOUBLE GANG BACKBOX; STUB ONE (1) 1" EMT TO ACCESSIBLE CEILING. COORDINATE CABLEING AND BACKBOX INSTALLATION WITH AUDIOVISUAL REQUIREMENTS AS DESCRIBED ON AV SHEET TA3.0B. COORDINATE WITH DETAIL 2 ON AV SHEET TA3.01 FOR MOUNTING HEIGHT.
- COORDINATE FLOOR BOX INSTALLATION WITH AV SHEET TA3.0B.

GENERAL SHEET NOTES

- THE DRAWINGS ARE DIAGRAMMATIC ONLY AND MAY NOT SHOW ALL COMPONENTS, MATERIALS, OFFSETS, BENDS, ELBOWS AND OTHER SPECIFIC ELEMENTS THAT MAY BE REQUIRED FOR A COMPLETE INSTALLATION. THE CONTRACTOR SHALL BE RESPONSIBLE FOR PROVIDING ALL MATERIALS NEEDED FOR A COMPLETE AND FUNCTIONAL INSTALLATION.
- ELECTRIC EQUIPMENT AND DEVICES (E.G. PBX, NETWORK SWITCHES) ARE SHOWN FOR REFERENCE ONLY.
- REFER TO ARCHITECTURAL DETAIL PLANS FOR FINAL PATIENT ROOM DEVICE LOCATIONS. REFER TO ARCHITECTURAL DETAILS FOR OVERCOUNTER WAD HEIGHTS. REFER TO ARCHITECTURAL DETAILS FOR WALL MOUNT WAD HEIGHTS.
- HORIZONTAL DATA/VOICE/VIDEO CABLE SHALL TERMINATE IN THE TECHNOLOGY ROOM ON THE SAME FLOOR AS THE WORK AREA OUTLETS.
- WORK AREA OUTLETS SHALL CONSIST OF SINGLE PLASTER REDUCING RINGS INSTALLED ON OVERSIZE DOUBLE GANG BACKBOXES, UNLESS OTHERWISE NOTED.
- TV COAX CABLES SHALL BE COILED IN THE RESPECTIVE TECHNOLOGY ROOMS WITH A 20' SERVICE LOOP PRIOR TO TERMINATIONS. COILS SHALL BE SECURED TO THE AUDIOVISUAL WALL FIELD FOR AV CONTRACTOR.
- COMMON LOW VOLTAGE CABLE TRAY IS SIZED AS INDICATED ON THE DRAWINGS. PROVIDE ALL MATERIALS AS NEEDED FOR A COMPLETE, MANUFACTURER-APPROVED SYSTEM USING CABLE TRAY MANUFACTURERS' MATERIALS AND PARTS WHEN AVAILABLE FROM THE MANUFACTURER AND AS INTENDED. REFER TO DRAWING TA.01 FOR DETAILS. ALL CHANGES IN DIRECTION AND INTERSECTIONS SHALL USE PREMANUFACTURED OR FIELD-INSTALLED SWEEPS AND TEES. ALL SWEEPS AND TEES SHALL MAINTAIN A 1 FOOT MINIMUM RADIUS IN CHANGES OF DIRECTION.
- CABLE TRAY SHALL NOT PENETRATE WALLS. PROVIDE TRANSITION FROM CABLE TRAY TO LISTED FIRESTOP ASSEMBLIES IN ORDER TO PENETRATE FIRESTOPPED WALLS. TRANSITION TO 4" CONDUITS/SLEEVES FOR NON-PENETRATED WALLS. PROVIDE SUFFICIENT CONDUITS/SLEEVES TO ACCOMMODATE 100% VISUAL CABLE TRAY LOAD AT 50% VISUAL CONDUIT FILL.
- REFER TO ELECTRICAL DRAWINGS & SPECIFICATIONS FOR SHARED FLOOR BOXES & LOW VOLTAGE CONDUIT.
- PROVIDE BRACING TO MEET OSHPD SEISMIC REQUIREMENTS. REFER TO SHEET TA.02 FOR MORE INFORMATION.
- PROVIDE ALL OUTLET CONDUITS FROM WORK AREA OUTLETS, DEVICES OR PULL BOXES TO NEAREST CABLE TRAY.
- INSTALL CABLE TRAY @ 6" ABOVE CEILING.

KEY PLAN

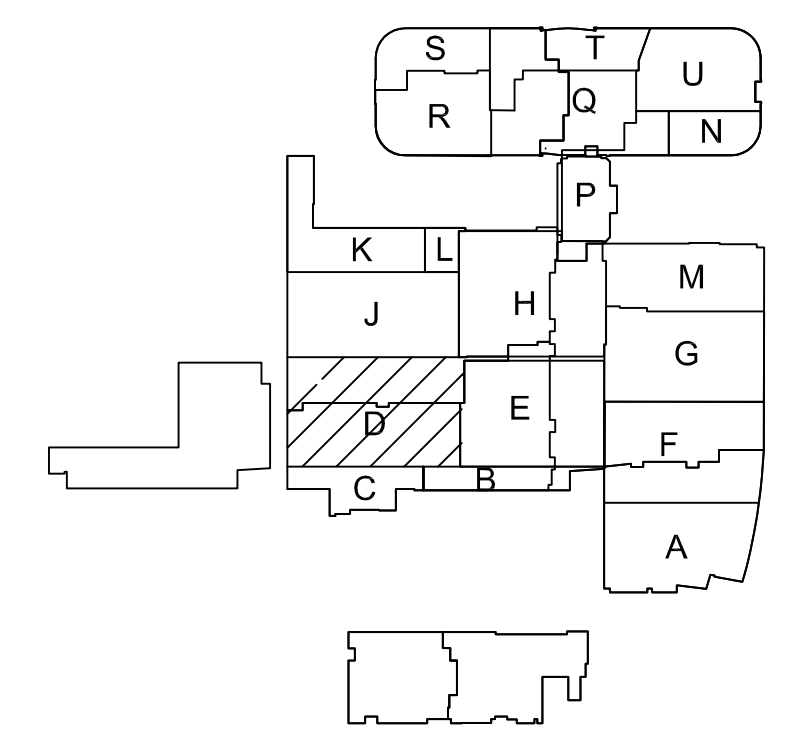

PROJECT: CHILDREN'S HOSPITAL
OF ORANGE COUNTY - TOWER II

ADDRESS: 455 South Main Street
Orange, CA 92668-3874

W.O. NO.: 12684

PROPRIETARY STATEMENT
THESE DRAWINGS AND DOCUMENTS HEREIN ARE THE PROPERTY OF BERGELECTRIC CORPORATION. ANY REUSE OR REPRODUCTION OF THESE DOCUMENTS WITHOUT WRITTEN PERMISSION OF BERGELECTRIC CORPORATION IS STRICTLY FORBIDDEN. ALL RIGHTS RESERVED.

DRAWN BY:
J. RAMIREZ

DESIGN SUPERVISOR:

INSTALL SUPERVISOR:
Scott Adams
Tel Data Systems
Bergelectric Corporation
850 Oppen Street
Escondido, CA 92029

REVISION:
05-30-12 RECORD DRAWINGS

SHEET TITLE:
TELECOM
FLOOR PLAN
LOWER LEVEL
AREA-D

SCALE:
1/4"=1'0"

DRAWING NO.:
T3.0D
RECORD
DRAWING

Contractors & Engineers
Bergelectric Corp.
#C10-485048
650 OPPEN ST.
ESCONDIDO, CA 92029
(760) 742-1033
FAX (760) 742-4619

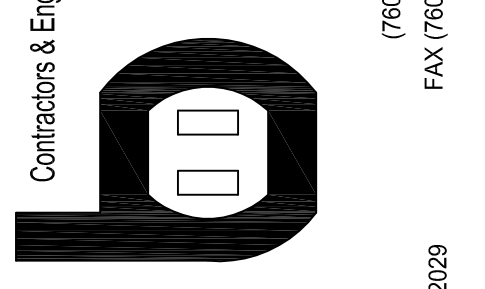

T3 LOWER LEVEL - TELECOM PLAN - AERA-D
1/4"=1'0"

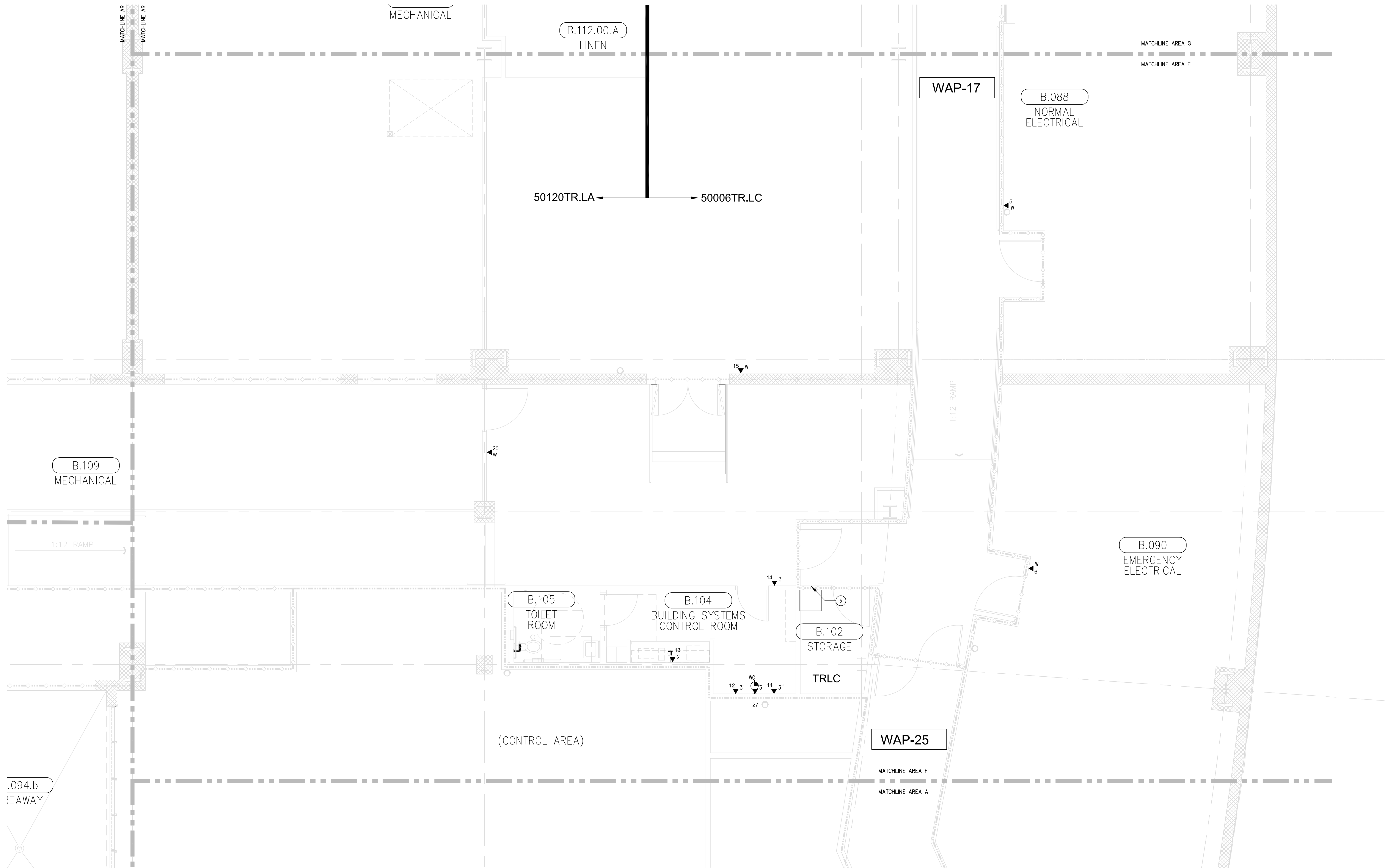

SHEET KEYNOTES

- 12"W X 6"H CABLE RUNWAY
- 24"W X 6"H CABLE RUNWAY
- 18"W X 6"H CABLE RUNWAY
- 1" EMT
- WALL MOUNTED TELECOM RACK 24"H X 24"W X 25"D, BOTTOM OF RACK AT 80" AFF.

GENERAL SHEET NOTES

- THE DRAWINGS ARE DIAGRAMMATIC ONLY AND MAY NOT SHOW ALL COMPONENTS, MATERIALS, OFFSETS, BENDS, ELBOWS AND OTHER SPECIFIC ELEMENTS THAT MAY BE REQUIRED FOR A COMPLETE INSTALLATION. THE CONTRACTOR SHALL BE RESPONSIBLE FOR PROVIDING ALL MATERIALS NEEDED FOR A COMPLETE AND FUNCTIONAL INSTALLATION.
- ELECTRIC EQUIPMENT AND DEVICES (E.G. PBX, NETWORK SWITCHES) ARE SHOWN FOR REFERENCE ONLY.
- REFER TO ARCHITECTURAL DETAIL PLANS FOR FINAL PATIENT ROOM DEVICE LOCATIONS. REFER TO ARCHITECTURAL DETAILS FOR OVERCOUNTER WAO HEIGHTS. REFER TO ARCHITECTURAL DETAILS FOR WALL-MOUNT WAO HEIGHTS.
- HORIZONTAL DATA/VOICE/VIDEO CABLE SHALL TERMINATE IN THE TECHNOLOGY ROOM ON THE SAME FLOOR AS THE WORK AREA OUTLETS.
- WORK AREA OUTLETS SHALL CONSIST OF SINGLE PLASTER REDUCING RINGS INSTALLED ON OVERSIZE DOUBLE GANG BACKBOXES, UNLESS OTHERWISE NOTED.
- TV COAX CABLES SHALL BE COILED IN THE RESPECTIVE TECHNOLOGY ROOMS WITH A 20' SERVICE LOOP PRIOR TO TERMINATIONS. COILS SHALL BE SECURED TO THE AUDIOVISUAL WALL FIELD FOR AV CONTRACTOR.
- COMMON LOW VOLTAGE CABLE RUNWAY IS 24" W X 6" HIGH. PROVIDE ALL MATERIALS AS NEEDED FOR A COMPLETE, MANUFACTURER-APPROVED SYSTEM USING CABLE TRAY MANUFACTURERS' MATERIALS AND PARTS WHEN AVAILABLE FROM THE MANUFACTURER AND AS INTENDED. REFER TO DRAWING T4.01 FOR DETAILS. ALL CHANGES IN DIRECTION AND INTERSECTIONS SHALL USE PRE-MANUFACTURED OR FIELD-INSTALLED SWEEPS AND TEES. ALL SWEEPS AND TEES SHALL MAINTAIN A 1 FOOT MINIMUM RADIUS IN CHANGES OF DIRECTION.
- CABLE TRAY SHALL NOT PENETRATE WALLS. PROVIDE TRANSITION FROM CABLE TRAY TO LISTED FIRESTOP ASSEMBLIES IN ORDER TO PENETRATE FIRE/SMOKE WALLS. TRANSITION TO 4" CONDUITS/SLEEVES FOR NON-RATED WALLS. PROVIDE SUFFICIENT CONDUITS/SLEEVES TO ACCOMMODATE 100% VISUAL CABLE TRAY LOAD AT 50% VISUAL CONDUIT FILL.
- REFER TO ELECTRICAL DRAWINGS & SPECIFICATIONS FOR SHARED FLOOR BOXES & LOW VOLTAGE CONDUIT.
- PROVIDE BRACING TO MEET OSHPD SEISMIC REQUIREMENTS. REFER TO SHEET T4.02 FOR MORE INFORMATION.
- PROVIDE ALL OUTLET CONDUITS FROM WORK AREA OUTLETS, DEVICES OR PULL BOXES TO NEAREST CABLE TRAY.
- INSTALL CABLE TRAY @ 6" ABOVE CEILING.

KEY PLAN

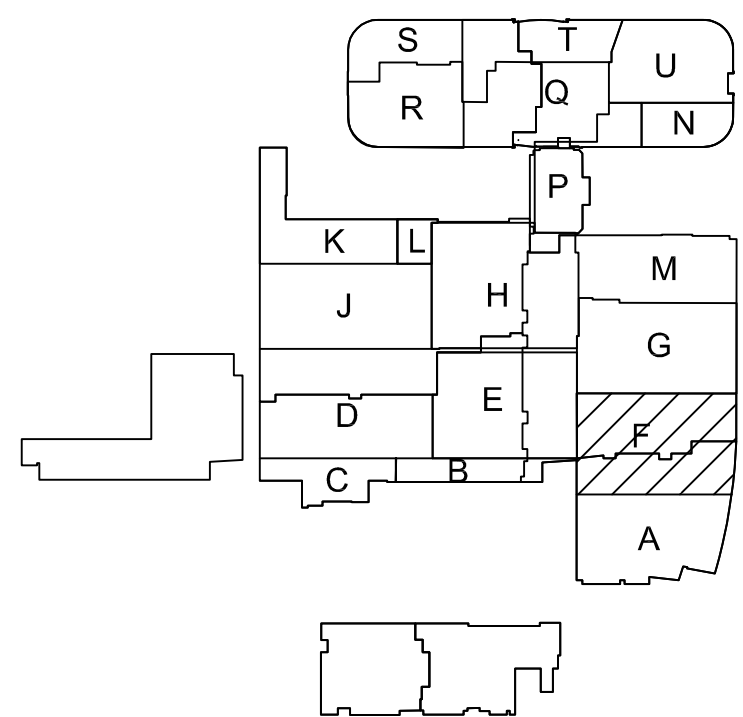

T3 LOWER LEVEL - TELECOM PLAN - AREA-F
1/4" = 1'-0"

PROJECT: CHILDREN'S HOSPITAL
OF ORANGE COUNTY - TOWER II
ADDRESS: 455 South Main Street
Orange, CA 92668-3874
W.O. NO.: 12684

PROPRIETARY STATEMENT
THESE DRAWINGS/DOCUMENTS HEREON ATTACHED ARE THE PROPERTY OF BERGELECTRIC CORPORATION. ANY REUSE OR REPRODUCTION OF THESE DOCUMENTS WITHOUT WRITTEN PERMISSION OF BERGELECTRIC CORPORATION IS STRICTLY FORBIDDEN. ALL RIGHTS RESERVED.

DRAWN BY:
J. RAMIREZ

DESIGN SUPERVISOR:

INSTALL SUPERVISOR:
Scott Adams
Tel Data Systems
Bergelectric Corporation
650 Upper Street
Escondido, CA 92029

REVISION:
05-30-12 RECORD DRAWINGS

SHEET TITLE:
TELECOM
FLOOR PLAN
LOWER LEVEL
AREA-F

SCALE:
1/4"=1'0"

DRAWING NO.:
T3.0F
**RECORD
DRAWING**

PROJECT:
**CHILDREN'S HOSPITAL
OF ORANGE COUNTY - TOWER II**

ADDRESS:
455 South Main Street
Orange, CA 92668-3874

W.O. NO.:
12684

PROPRIETARY STATEMENT
THESE DRAWINGS AND DOCUMENTS HEREIN ATTACHED ARE THE
PROPERTY OF BERGELECTRIC CORPORATION. ANY REUSE OR
REPRODUCTION OF THESE DOCUMENTS WITHOUT WRITTEN
PERMISSION OF BERGELECTRIC CORPORATION IS STRICTLY
FORBIDDEN. ALL RIGHTS RESERVED.

DRAWN BY:
J. RAMIREZ

DESIGN SUPERVISOR:

INSTALL SUPERVISOR:
Scott Adams
Tel Data Systems
Bergelectric Corporation
650 Upper Street
Escondido, CA 92029

REVISION:
05-30-12 RECORD DRAWINGS

SHEET TITLE:

TELECOM
FLOOR PLAN
LOWER LEVEL
AREA-G

SCALE:
1/4"=1'0"

DRAWING NO.:

T3.0G
RECORD
DRAWING

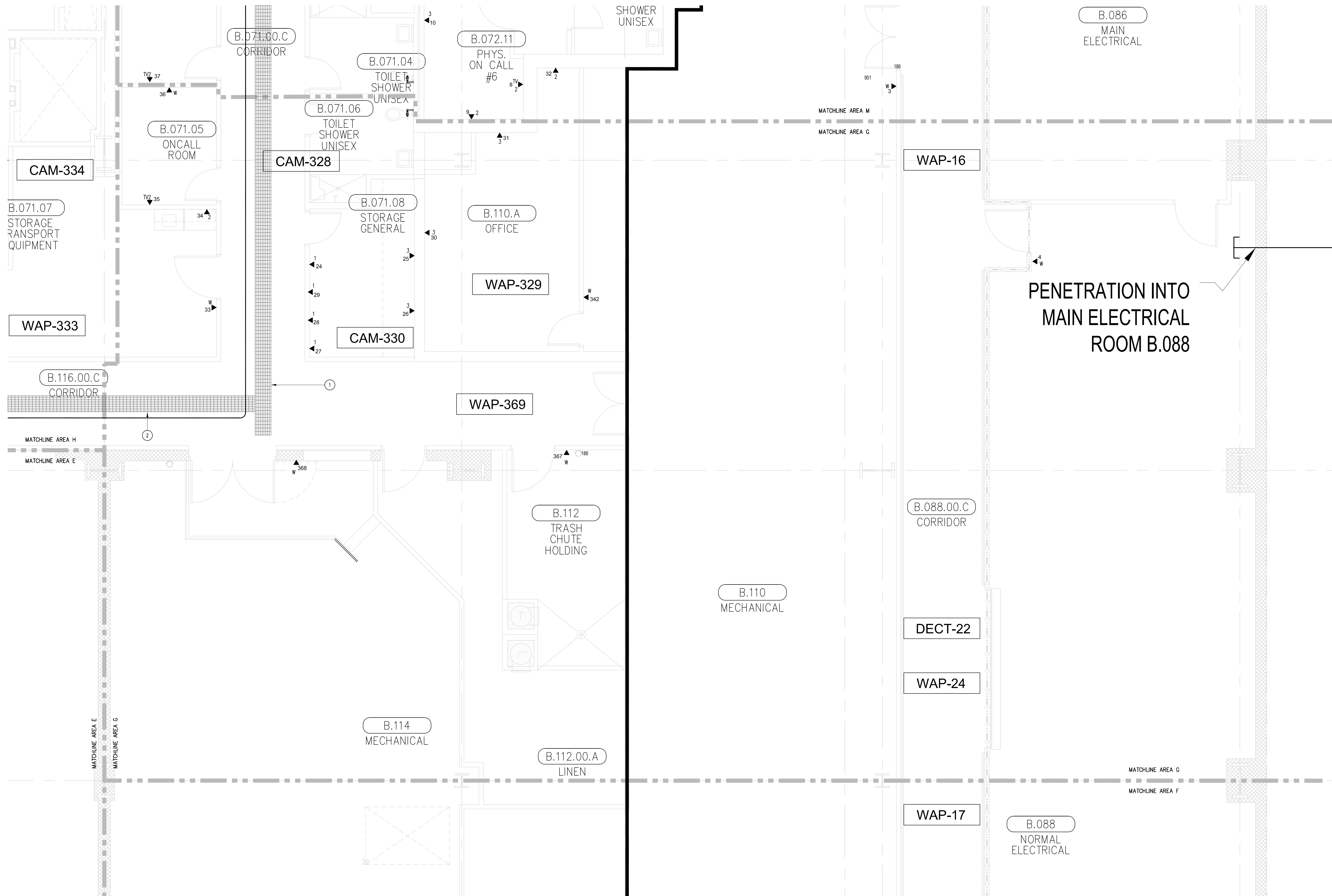

SHEET KEYNOTES

- 12"W X 6"H CABLE RUNWAY
- 24"W X 6"H CABLE RUNWAY
- 18"W X 6"H CABLE RUNWAY

GENERAL SHEET NOTES

- THE DRAWINGS ARE DIAGRAMMATIC ONLY AND MAY NOT SHOW ALL COMPONENTS, MATERIALS, OFFSETS, BENDS, ELBOWS AND OTHER SPECIFIC ELEMENTS THAT MAY BE REQUIRED FOR A COMPLETE INSTALLATION. THE CONTRACTOR SHALL BE RESPONSIBLE FOR PROVIDING ALL MATERIALS NEEDED FOR A COMPLETE AND FUNCTIONAL INSTALLATION.
- ELECTRIC EQUIPMENT AND DEVICES (E.G. PBX, NETWORK SWITCHES) ARE SHOWN FOR REFERENCE ONLY.
- REFER TO ARCHITECTURAL DETAIL PLANS FOR FINAL PATIENT ROOM DEVICE LOCATIONS. REFER TO ARCHITECTURAL DETAILS FOR OVERCOUNTER WAO HEIGHTS. REFER TO ARCHITECTURAL DETAILS FOR WALL-MOUNT WAO HEIGHTS.
- HORIZONTAL DATA/VOICE/VIDEO CABLE SHALL TERMINATE IN THE TECHNOLOGY ROOM ON THE SAME FLOOR AS THE WORK AREA OUTLETS.
- WORK AREA OUTLETS SHALL CONSIST OF SINGLE PLASTER REDUCING RINGS INSTALLED ON OVERSIZE DOUBLE GANG BACKBOXES, UNLESS OTHERWISE NOTED.
- TV COAX CABLES SHALL BE COILED IN THE RESPECTIVE TECHNOLOGY ROOMS WITH A 20' SERVICE LOOP PRIOR TO TERMINATIONS. COILS SHALL BE SECURED TO THE AUDIOVISUAL WALL FIELD FOR AV CONTRACTOR.
- COMMON LOW VOLTAGE CABLE RUNWAY IS 24" W X 6" HIGH. PROVIDE ALL MATERIALS AS NEEDED FOR A COMPLETE, MANUFACTURER-APPROVED SYSTEM USING CABLE TRAY MANUFACTURERS' MATERIALS AND PARTS WHEN AVAILABLE FROM THE MANUFACTURER AND AS INTENDED. REFER TO DRAWING T4.01 FOR DETAILS. ALL CHANGES IN DIRECTION AND INTERSECTIONS SHALL USE PRE-MANUFACTURED OR FIELD-INSTALLED SWEEPS AND TEES. ALL SWEEPS AND TEES SHALL MAINTAIN A 1-FOOT MINIMUM RADIUS IN CHANGES OF DIRECTION.
- CABLE TRAY SHALL NOT PENETRATE WALLS. PROVIDE TRANSITION FROM CABLE TRAY TO LISTED FIRESTOP ASSEMBLIES IN ORDER TO PENETRATE FIRE/SMOKE WALLS. TRANSITION TO 4" CONDUITS/SLEEVES FOR NON-RATED WALLS. PROVIDE SUFFICIENT CONDUITS/SLEEVES TO ACCOMMODATE 100% VISUAL CABLE TRAY LOAD AT 50% VISUAL CONDUIT FILL.
- REFER TO ELECTRICAL DRAWINGS & SPECIFICATIONS FOR SHARED FLOOR BOXES & LOW VOLTAGE CONDUIT.
- PROVIDE BRACING TO MEET OSHPD SEISMIC REQUIREMENTS. REFER TO SHEET T4.02 FOR MORE INFORMATION.
- PROVIDE ALL OUTLET CONDUITS FROM WORK AREA OUTLETS, DEVICES OR PULL BOXES TO NEAREST CABLE TRAY.
- INSTALL CABLE TRAY @ 6" ABOVE CEILING.

KEY PLAN

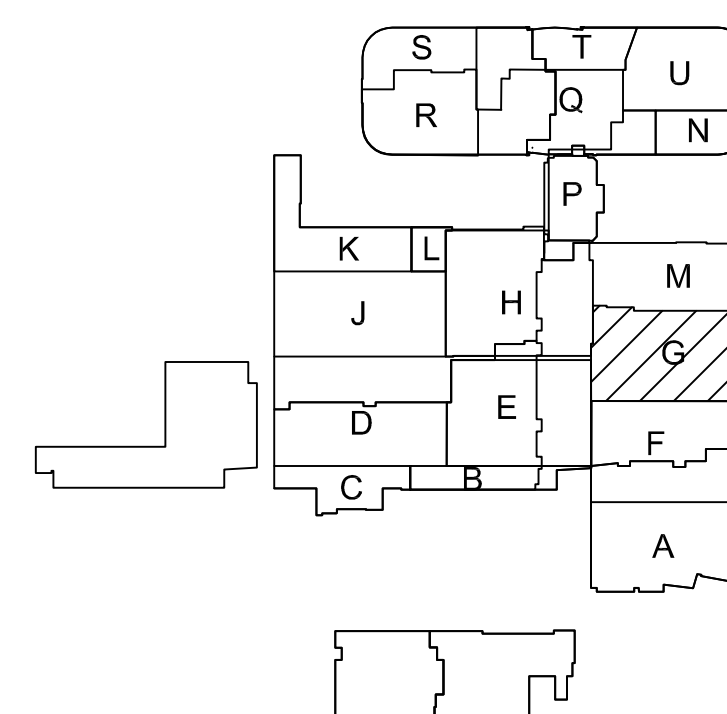



T3.0K
RECORD
DRAWING

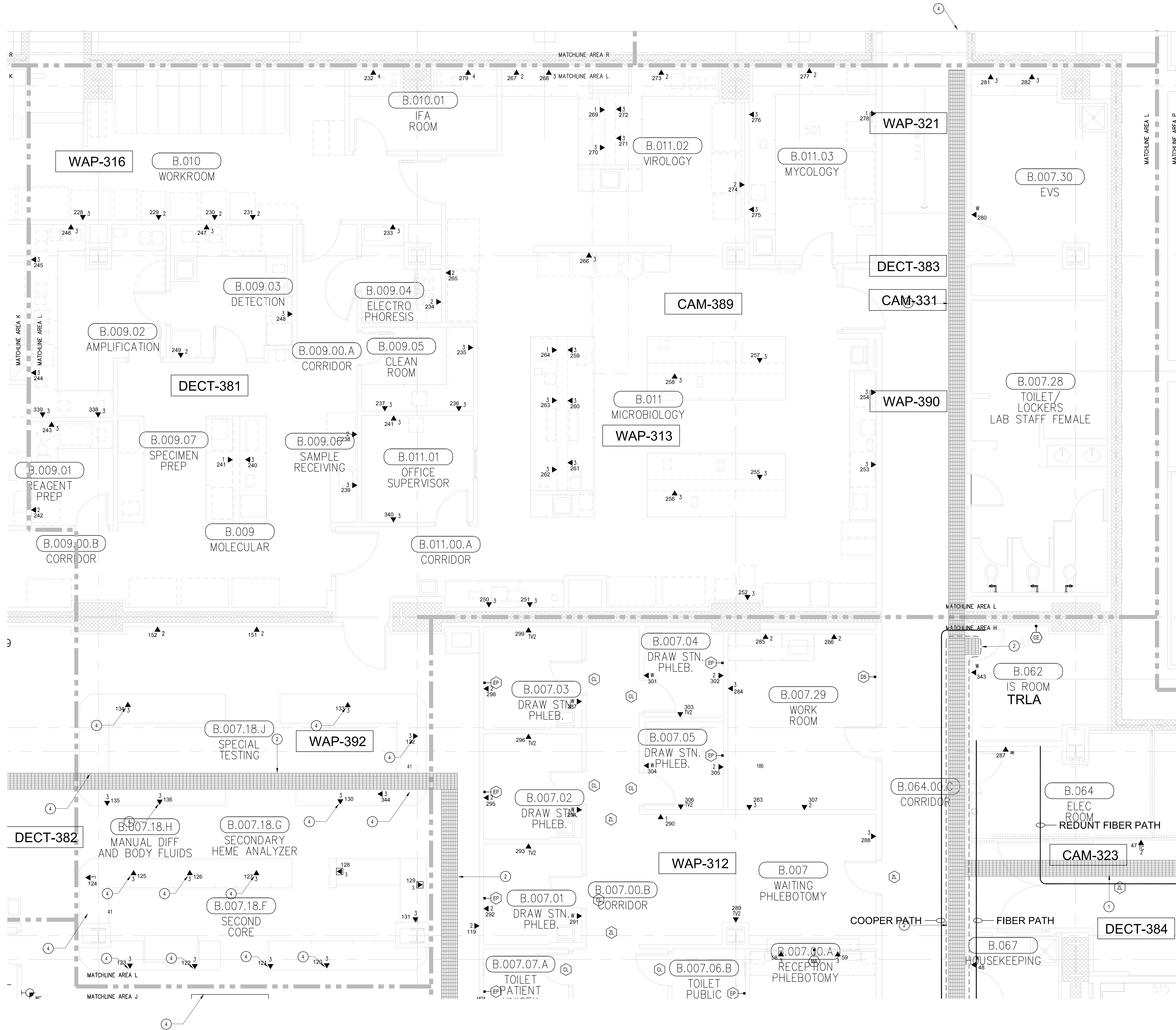

T3 LOWER LEVEL - TELECOM PLAN - AREA-L
1/4" = 1'-0"

SHEET KEYNOTES

- 12"W X 8"H CABLE RUNWAY
- 24"W X 8"H CABLE RUNWAY
- 18"W X 8"H CABLE RUNWAY
- OUTLETS ARE TO BE FED VIA WALL FROM ABOVE CEILING SPACE. PROVIDE TWO (2) 1-1/4" CONDUITS FROM CABLE RUNWAY TO MILLWORK. TERMINATE CONDUITS AT 24" A.F.F. AND EXTEND ONTO MILLWORK USING NON-METALLIC SURFACE RACEWAYS WITH MINIMUM OF 15" INTERNAL AREA TO EACH OUTLET.
- OUTLETS TO BE FED FROM FLOORBOX.

GENERAL SHEET NOTES

- THE DRAWINGS ARE DIAGRAMMATIC ONLY AND MAY NOT SHOW ALL COMPONENTS, MATERIALS, OFFSETS, BENDS, ELBOWS AND OTHER SPECIFIC ELEMENTS THAT MAY BE REQUIRED FOR A COMPLETE INSTALLATION. THE CONTRACTOR SHALL BE RESPONSIBLE FOR PROVIDING ALL MATERIALS NEEDED FOR A COMPLETE AND FUNCTIONAL INSTALLATION.
- ELECTRIC EQUIPMENT AND DEVICES (E.G. PBX, NETWORK SWITCHES) ARE SHOWN FOR REFERENCE ONLY.
- REFER TO ARCHITECTURAL DETAIL PLANS FOR FINAL PATIENT ROOM DEVICE LOCATIONS. REFER TO ARCHITECTURAL DETAILS FOR OVERCOUNTER WAO HEIGHTS. REFER TO ARCHITECTURAL DETAILS FOR WALL-MOUNT WAO HEIGHTS.
- HORIZONTAL DATA/VOICE/VIDEO CABLE SHALL TERMINATE IN THE TECHNOLOGY ROOM ON THE SAME FLOOR AS THE WORK AREA OUTLETS.
- WORK AREA OUTLETS SHALL CONSIST OF SINGLE PLASTER REDUCING RINGS INSTALLED ON OVERSIZE DOUBLE GANG BACKBOXES, UNLESS OTHERWISE NOTED.
- TV COAX CABLES SHALL BE COILED IN THE RESPECTIVE TECHNOLOGY ROOMS WITH A 20' SERVICE LOOP PRIOR TO TERMINATIONS. COILS SHALL BE SECURED TO THE AUDIOVISUAL WALL FIELD FOR AV CONTRACTOR.
- COMMON LOW VOLTAGE CABLE RUNWAY IS 24" W X 6" HIGH. PROVIDE ALL MATERIALS AS NEEDED FOR A COMPLETE MANUFACTURER-APPROVED SYSTEM USING CABLE TRAY MANUFACTURERS MATERIALS AND PARTS WHEN AVAILABLE FROM THE MANUFACTURER AND AS INTENDED. REFER TO DRAWING T4.01 FOR DETAILS. ALL CHANGES IN DIRECTION AND INTERSECTIONS SHALL USE PRE-MANUFACTURED OR FIELD-INSTALLED SWEEPS AND TEES. ALL SWEEPS AND TEES SHALL MAINTAIN A 1 FOOT MINIMUM RADIUS IN CHANGES OF DIRECTION.
- CABLE TRAY SHALL NOT PENETRATE WALLS. PROVIDE TRANSITION FROM CABLE TRAY TO LISTED FIRESTOP ASSEMBLIES IN ORDER TO PENETRATE FIRE-SMOKE WALLS. TRANSITION TO 4" CONDUITS/SLEEVES FOR NON-RATED WALLS. PROVIDE SUFFICIENT CONDUITS/SLEEVES TO ACCOMMODATE 100% VISUAL CABLE TRAY LOAD AT 50% VISUAL CONDUIT FILL.
- REFER TO ELECTRICAL DRAWINGS & SPECIFICATIONS FOR SHARED FLOOR BOXES & LOW VOLTAGE CONDUIT.
- PROVIDE BRACING TO MEET OSHPD SEISMIC REQUIREMENTS. REFER TO SHEET T4.02 FOR MORE INFORMATION.
- PROVIDE ALL OUTLET CONDUITS FROM WORK AREA OUTLETS, DEVICES OR PULL BOXES TO NEAREST CABLE TRAY.
- INSTALL CABLE TRAY @ 6" ABOVE CEILING.

KEY PLAN

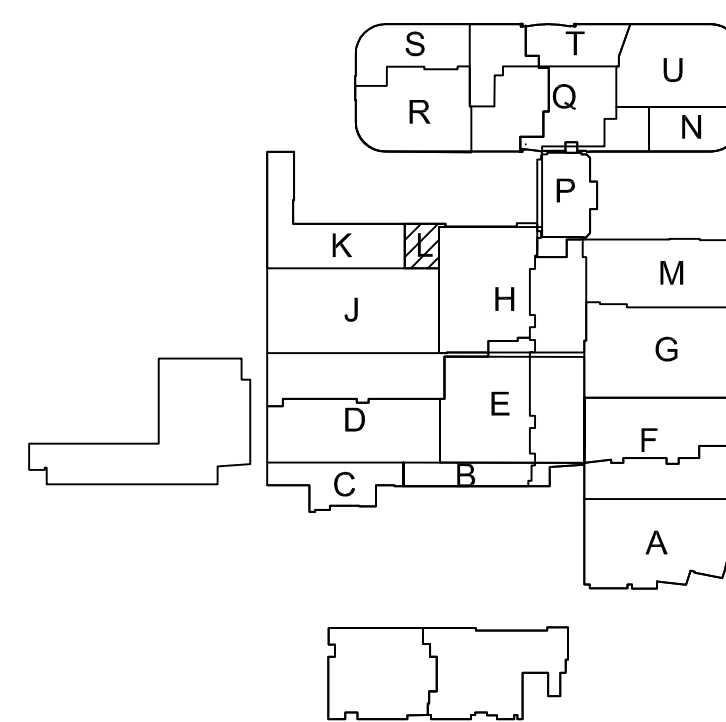

CHILDREN'S HOSPITAL OF ORANGE COUNTY - TOWER II

PROJECT:
ADDRESS:
W.O. NO.:

PROPRIETARY STATEMENT
THESE DRAWINGS AND DOCUMENTS ARE THE PROPERTY OF BERGELECTRIC CORPORATION AND MAY BE REPRODUCED OR TRANSMITTED IN ANY FORM OR BY ANY MEANS, ELECTRONIC OR MECHANICAL, WITHOUT PERMISSION OF BERGELECTRIC CORPORATION IS STRICTLY FORBIDDEN. ALL RIGHTS RESERVED.

DRAWN BY:
J. RAMIREZ

DESIGN SUPERVISOR:

INSTALL SUPERVISOR:
Scott Adams
Tel Data Systems
Bergelectric Corporation
650 Oppen Street
Escondido, CA 92029

REVISIONS:
05-30-12 RECORD DRAWINGS

SHEET TITLE:

TELECOM
FLOOR PLAN
LOWER LEVEL
AREA-L

SCALE:
1/4"=1'0"

DRAWING NO.:
T3.0L
RECORD
DRAWING

Bergelectric Corp.
Contractors & Engineers

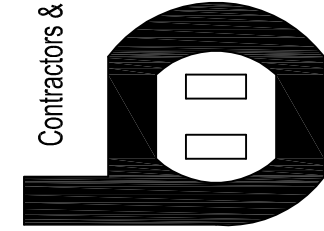

650 OPPEN ST.
ESCONDIDO, CA 92029
TEL: (760) 746-1033
FAX: (760) 746-4619

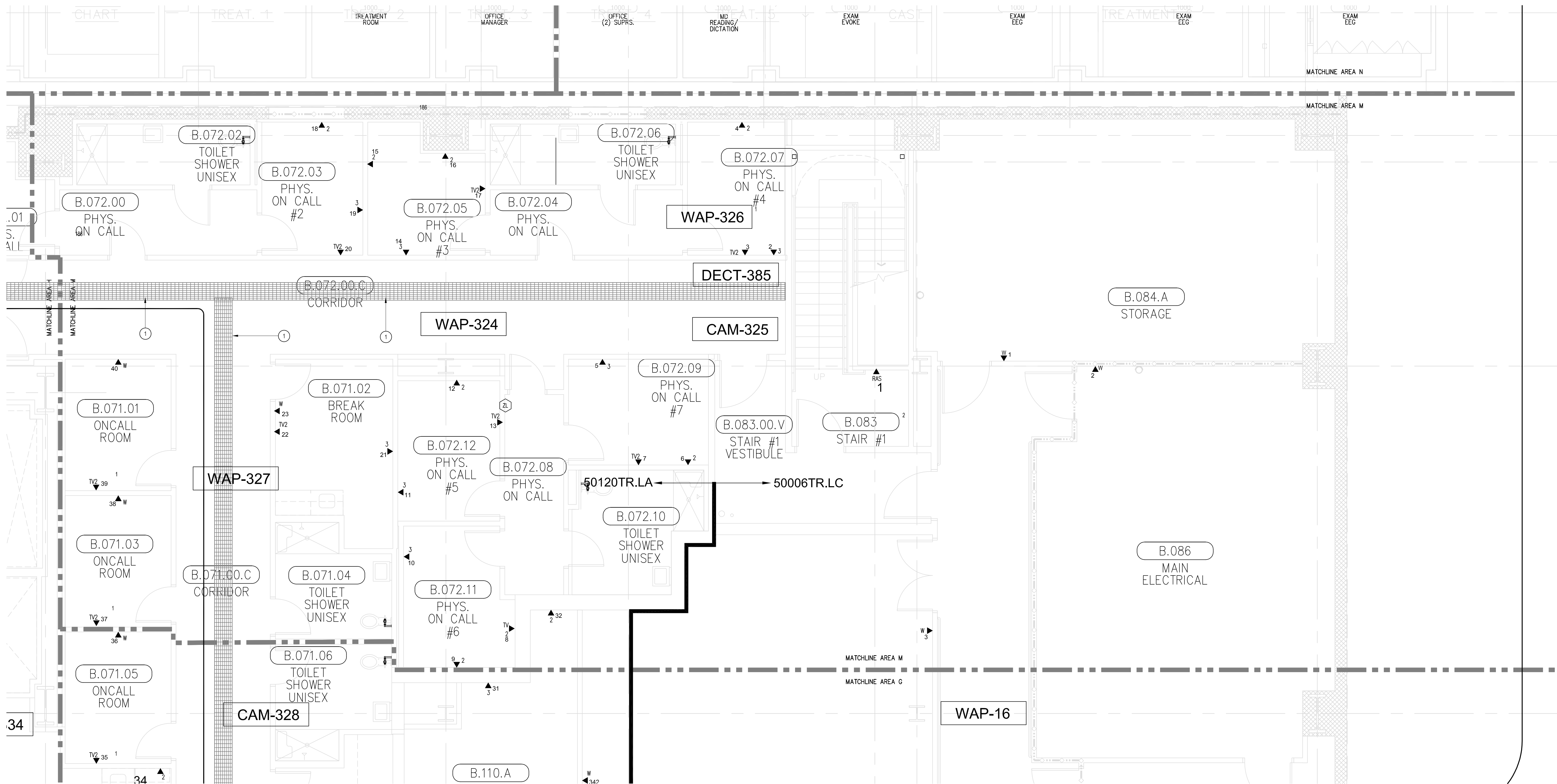

SHEET KEYNOTES

- 12" W X 6" H CABLE RUNWAY
- 24" W X 6" H CABLE RUNWAY
- 18" W X 6" H CABLE RUNWAY

GENERAL SHEET NOTES

- THE DRAWINGS ARE DIAGRAMMATIC ONLY AND MAY NOT SHOW ALL COMPONENTS, MATERIALS, OFFSETS, BENDS, ELBOWS AND OTHER SPECIFIC ELEMENTS THAT MAY BE REQUIRED FOR A COMPLETE INSTALLATION. THE CONTRACTOR SHALL BE RESPONSIBLE FOR PROVIDING ALL MATERIALS NEEDED FOR A COMPLETE AND FUNCTIONAL INSTALLATION.
- ELECTRIC EQUIPMENT AND DEVICES (E.G. PBX, NETWORK SWITCHES) ARE SHOWN FOR REFERENCE ONLY.
- REFER TO ARCHITECTURAL DETAIL PLANS FOR FINAL PATIENT ROOM DEVICE LOCATIONS. REFER TO ARCHITECTURAL DETAILS FOR OVERCOUNTER WAO HEIGHTS. REFER TO ARCHITECTURAL DETAILS FOR WALL-MOUNT WAO HEIGHTS.
- HORIZONTAL DATA/VOICE/VIDEO CABLE SHALL TERMINATE IN THE TECHNOLOGY ROOM ON THE SAME FLOOR AS THE WORK AREA OUTLETS.
- WORK AREA OUTLETS SHALL CONSIST OF SINGLE PLASTER REDUCING RINGS INSTALLED ON OVERSIZE DOUBLE GANG BACKBOXES, UNLESS OTHERWISE NOTED.
- TV COAX CABLES SHALL BE COILED IN THE RESPECTIVE TECHNOLOGY ROOMS WITH A 20' SERVICE LOOP PRIOR TO TERMINATIONS. COILS SHALL BE SECURED TO THE AUDIOVISUAL WALL FIELD FOR AV CONTRACTOR.
- COMMON LOW VOLTAGE CABLE TRAY IS SIZED AS INDICATED ON THE DRAWINGS. PROVIDE ALL MATERIALS AS NEEDED FOR A COMPLETE, MANUFACTURER-APPROVED SYSTEM USING CABLE TRAY MANUFACTURERS' MATERIALS AND PARTS WHEN AVAILABLE FROM THE MANUFACTURER AND AS INTENDED. REFER TO DRAWING T4.01 FOR DETAILS. ALL CHANGES IN DIRECTION AND INTERSECTIONS SHALL USE PRE-MANUFACTURED OR FIELD-INSTALLED SWEEPS AND TEES. ALL SWEEPS AND TEES SHALL MAINTAIN A 1 FOOT MINIMUM RADIUS IN CHANGES OF DIRECTION.
- CABLE TRAY SHALL NOT PENETRATE WALLS. PROVIDE TRANSITION FROM CABLE TRAY TO LISTED FIRESTOP ASSEMBLIES IN ORDER TO PENETRATE FIRE/SMOKE WALLS. TRANSITION TO 4" CONDUITS/SLEEVES FOR NON-RATED WALLS. PROVIDE SUFFICIENT CONDUITS/SLEEVES TO ACCOMMODATE 100% VISUAL CABLE TRAY LOAD AT 50% VISUAL CONDUIT FILL.
- REFER TO ELECTRICAL DRAWINGS & SPECIFICATIONS FOR SHARED FLOOR BOXES & LOW VOLTAGE CONDUIT.
- PROVIDE BRACING TO MEET OSHPD SEISMIC REQUIREMENTS. REFER TO SHEET T4.02 FOR MORE INFORMATION.
- PROVIDE ALL OUTLET CONDUITS FROM WORK AREA OUTLETS, DEVICES OR PULL BOXES TO NEAREST CABLE TRAY.
- INSTALL CABLE TRAY @ 8" ABOVE CEILING.

T3 LOWER LEVEL - TELECOM PLAN - AREA-M

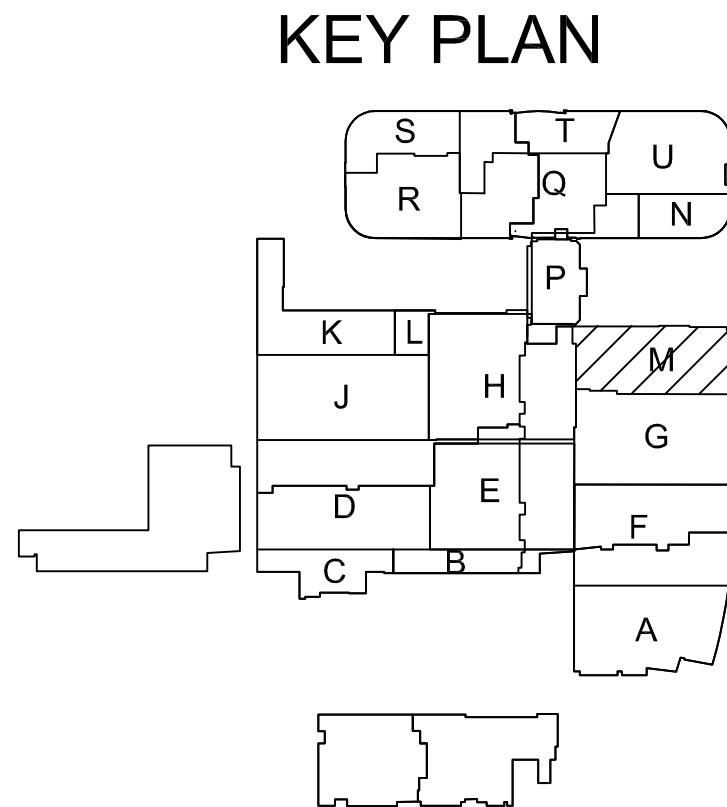

CHILDREN'S HOSPITAL
OF ORANGE COUNTY - TOWER II

PROJECT:
ADDRESS:
W.O. NO.:

PROPRIETARY STATEMENT
THESE DRAWINGS AND DOCUMENTS HEREIN ATTACHED ARE THE PROPERTY OF BERGELECTRIC CORPORATION. ANY REUSE OR REPRODUCTION OF THESE DOCUMENTS WITHOUT WRITTEN PERMISSION OF BERGELECTRIC CORPORATION IS STRICTLY FORBIDDEN. ALL RIGHTS RESERVED.

DRAWN BY:
J. RAMIREZ

DESIGN SUPERVISOR:

INSTALL SUPERVISOR:
Scott Adams
Tel Data Systems
Bergelectric Corporation
650 Oppen Street
Escondido, CA 92029

REVISION:
05-30-12 RECORD DRAWINGS

SHEET TITLE:

TELECOM
FLOOR PLAN
LOWER LEVEL
AREA-M

SCALE:
1/4"=1'0"

DRAWING NO.:

T3.0M
RECORD
DRAWING

Bergelectric Corp.
Contractors & Engineers

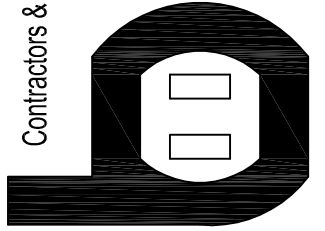

HC10-485046
650 OPPEN ST.
ESCONDIDO, CA 92029
(760) 742-1033
FAX (760) 742-4619

