

FKP Architects

ARCHITECT OF RECORD

Paul C. Gloriot



Changes on these drawings do not consist of  
materially altering changes to approved drawings  
and don't require a change order.  
OSHPO review ACO  
OSHPO review FLSO  
OSHPO review DSE

REVISIONS

4A	05/28/10	ASI #08
3A	12/01/10	ASI #48
2A	02/13/11	CO #300
1A	06/27/12	CO #383

APPROVAL

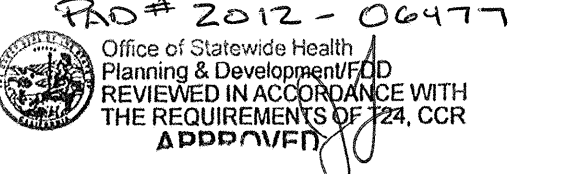

CHANGE ORDER # 383  
INSTRUCTION BULLETIN  
DEFERRED APPROVAL  
ADDENDUM

PROJECT NAME

CHILDREN'S HOSPITAL  
OF ORANGE COUNTY

455 S. Main St.  
Orange, CA 92668-3874

TOWER II



PROJECT NUMBER

12011.00  
Increment #7

OSHPO - PROJECT NUMBER

IL 072072-30

ISSUE

OSHPO PERMIT

DATE

01/27/2010

SCALE

1/4" = 1' - 0"

DRAWING TITLE

LEVEL 4 ENLARGED PLAN  
AREA - E

DRAWING NUMBER

A3.4E

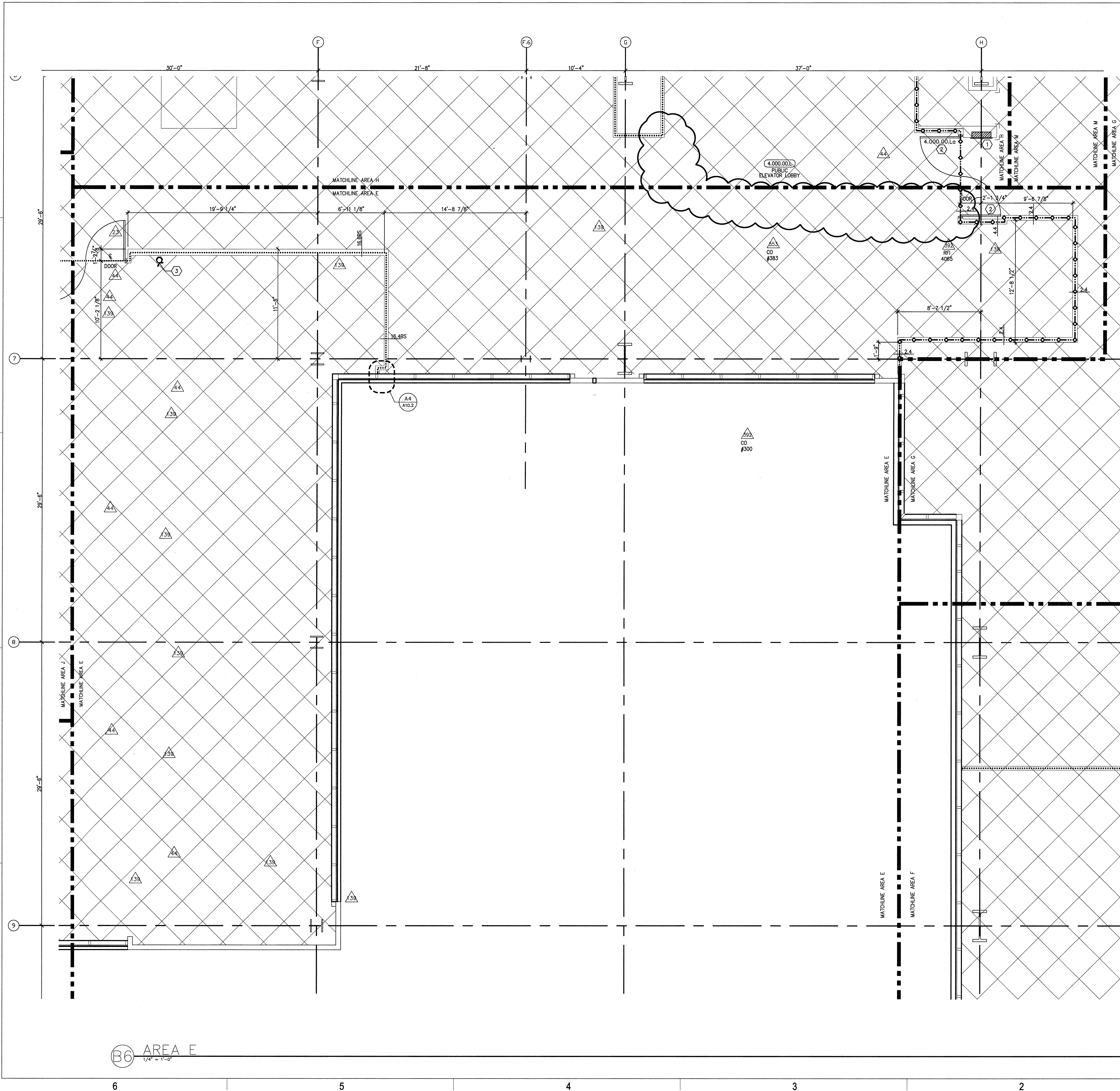

1. Fire valve cabinet, wall recessed, paint to match adjacent wall, typical. See A2 or B2/ A11.8.
2. Integrated double egress door, wall recessed.
3. Wall-mounted fire extinguisher.

A6 NOTES TO SHEET

- A. Information shown or referenced on enlarged and/or 1/4" scale drawings will generally not be shown on the smaller scale drawings.
- B. Partition types are scheduled on plans by number. See the "General Notes to Partition Types" on B2/A11.3 and Partition Types on Sheet A11.3, A11.3.1, and A11.3.2 for the definition of partition type references.
- C. Field coordinate of field routed pipe, conduit runs, etc., with locations of recessed accessories and equipment. In the event of a conflict, accessory locations take precedence.
- D. Close all joints between plumbing fixtures/accessories and dissimilar materials w/sealant (i.e. between sinks and countertops, toilet fixtures and accessories to wall, etc.).
- E. Cabinet numbers noted on enlarged plans refer to Cabinet component numbers, fixtures, accessories, etc. that are defined or elevated on Sheet A9.0 unless specific detail references are keyed.
- F. Plan dimensions - refer to B2/A11.3 (General Notes).
- G. For vertical mounting heights of shower accessories, see Detail D6/A11.7.
- H. For vertical mounting heights of typical toilet stall accessories, see Detail A4/A11.7.
- I. For vertical mounting heights of accessible toilet stall accessories, see Detail A5/A11.7.
- J. For vertical mounting heights of typical restroom accessories, see Detail B6/A11.7.
- K. For vertical mounting heights of accessible accessories at restrooms, see Detail A6/A11.7.
- L. For equipment not identified on plan, see Equipment drawings and workbook-Increment #7, Vol. 2E.
- M. For partial enlarged plan at janitor closets, see Detail A3/A11.7.
- N. Public/handicapped restroom graphics will be furnished and installed by the Owner's graphics supplier.
- O. Standard equipment wall mounting heights, see detail A2/A11.9.
- P. Medical equipment wall mounting heights, see details A4/A11.9, D3/A11.9 & D0.02-Increment #7, Vol. 2E.
- Q. Fire Protection equipment wall mounting heights, see detail D2/A11.9.
- R. Communication equipment wall mounting heights, see detail A3/A11.9.
- S. Equipment mounting heights at Countertops, see detail D3/A11.9.
- T. Equipment mounting heights at Desks, see detail A4/A11.9.
- U. A minimum head clearance of 6'-8" must be maintained at all points in stairways including stair and landing framing.
- V. For all dashed in equipment not identified, refer to EQ drawing series-Increment #7, Vol. 2E, and Equipment workbook. Specific items requiring structural support are cross referenced to structural support details via matrix shown on the Equipment drawings-Increment #7, Vol. 2E.
- W. All elevator hoist way entrance frames to have an embossed stainless steel graphic plaque with the floor landing number and Standard Braille markings for the blind. Conform to governing Accessibility codes and standards.
- X. All stair floor landings to receive etched pointed, semi-gloss enamel floor landing numerals 12" high adjacent to the door at 5'-0" AFF in a contrasting color to the scheduled wall color unless a graphic plaque is specifically detailed or noted.
- Y. Elevator Equipment Wall Mounting Heights, see detail A6/A11.9 and B3/A11.9.
- Z. Doors, Frames, Sidelites and Windows: (See Door Schedule). See A11 sheet series.
- AA. Provide wall blocking/backing for items weighting 20lbs or less. See A6/A11.3.1.
- BB. For person effects storage unit types and sizes see A4/A11.8.
- CC. For typical equipment blocking support, see A4/A11.1-Increment #5.
- DD. For boundaries of alternates and phasing, see the AP drawing series.
- EE. Provide 3" grommet, unless otherwise noted at 5'-0" O.C. maximum, field located at all electrical components at Nurses stations and Reception desks.
- FF. For vertical mounting heights of service accessories, see Detail A3/A11.
- GG. Provide access panels below the Patient Room countertops to serve as inspection ports for the Patient Room bathrooms.

A4 GENERAL NOTES

A1 KEY PLAN

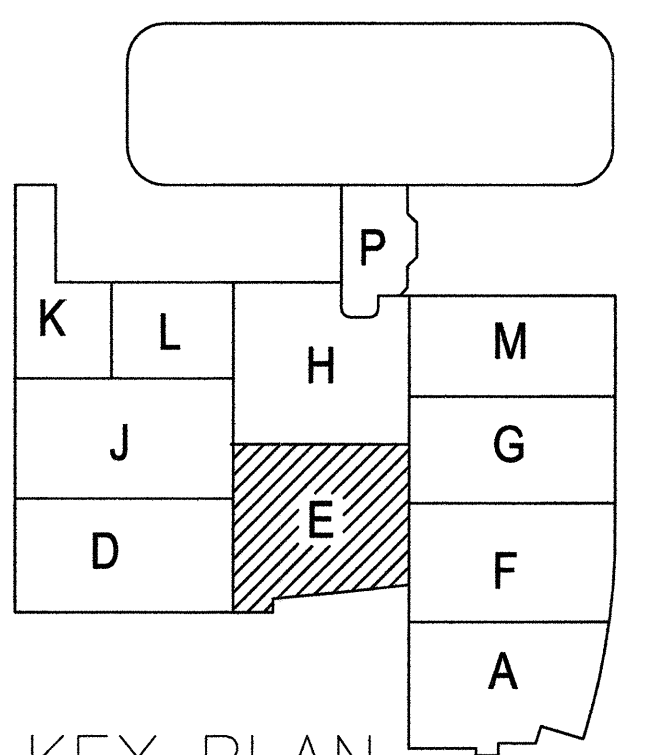

B6 AREA E

1/4" = 1' - 0"

6 5 4 3 2 1