

RFI 4107
Screw types and spacing
for FR backer behind 5th
floor headwalls in patient
rooms.

RFI 3655
Change wall type
and provide sound
attenuation blanket
at ceiling

Test 1 Hyperlinking relative path
using same sequence as drawing
was opened

Test 2 Hyperlinking relative path
using dif sequence as drawing
was opened

RFI 4165 Install
TV2

RFI 3044
5 Tier Lockers

RFI #5602

RFI 526.1
See Sched.
A11.0.7

RFI 1824
Ref for finish
type

RFI 2241
Partition
16.4s
1'-7 1/2"

RFI 3475
PES enclosure wall
type, 12.4AS
custom, typ.

RFI 4415
Millwork/Counter top
Door Frame Conflict

RFI 4415
Millwork/Counter top
Door Frame Conflict

RFI 4036
Ref RFI for installation
method of mop sink.

1. PC monitor, wall mounted. See Equipment drawings and workbook
2. For construction requirements this area, see Increment 6, Vol. 2A & 2B.
3. See room 5.124 on Sheet A3.5M for typical note designations.
4. See enlarged plan A3/A3.5A for typical note designations.
5. Window treatment, manual roller window shades, typical oil exterior glazing.
6. Microwave, see Equipment drawings and workbook.
7. Sill wall, 2'-10" A.F.F., typical. See C5/A10.1 for detail.
8. Align finish face of partitions.
9. Fire extinguisher cabinet, wall recessed, point to match adjacent wall, typical. See A2 or B2/A11.8 for detail.
10. Corner guard, high impact plastic, typical. See B4/A11.8 for detail.
11. Flat panel monitor bracket, see Equipment drawings and workbook and A5/S3.5.
12. See room 5.122 in Sheet A3.5A for typical note designations.
13. 14" deep shelf above, wall mounted with standards and brackets
14. Not used.
15. Not used.
16. Personal effects storage units.
17. Handrail/corralrail. See detail B4/A11.8.
18. Lockboard, 48"W x 48"H, wall mounted. Mount bottom at 36" A.F.F. See A6/A11.3.1.
19. Dialysis drain, see Plumbing drawings. Please locate center-line of DB-1 with center-line of tub wall in room behind.
20. Housekeeping mop sink. See B2/11.7.1 for details.
21. Modified countertop to 25 1/2" deep for entire cabinet length. Detail C5/A11.4.
22. Coordinated equipment, see RTKL low voltage drawings for model info. A5/S3.5.
23. For wall attachment detail refer to structural drawings del. A4/S3.3 - inc #7.
24. Patient board, 18.5"W x 12.5"H, wall mounted with Adhesive material - no backing is needed.
25. Cabinet mounted monitor, backing to be provided.

D1 NOTES TO SHEET

- A. Information shown or referenced on enlarged and/or 1/4" scale drawings will generally not be shown on the smaller scale drawings.
- B. Partition types are scheduled on plans by number. See the "General Notes to Partition Types" on B2/A11.3 and Partition Types on Sheet A11.3.1, A11.3.1, and A11.3.2 for the definition of partition type references.
- C. Field coordinate all field routed pipe, conduit runs, etc., with locations of recessed accessories and equipment. In the event of a conflict, accessory locations take precedence.
- D. Close all joints between plumbing fixtures/accessories and dissimilar materials w/sealant (i.e. between sinks and countertops, toilet fixtures and accessories to wall, etc.).
- E. Cabinet numbers noted on enlarged plans refer to Cabinet component numbers, fixtures, accessories, etc. that are defined or elevated on Sheet A9.0 unless specific detail references are keyed.
- F. Plan dimensions - refer to B2/A11.3 (General Notes).
- G. For vertical mounting heights of shower accessories, see Detail D6/A11.7.
- H. For vertical mounting heights of typical toilet stall accessories, see Detail A4/A11.7.
- I. For vertical mounting heights of accessible toilet stall accessories, see Detail A5/A11.7.
- J. For vertical mounting heights of typical restroom accessories, see Detail B6/A11.7.
- K. For vertical mounting heights of accessible accessories at restrooms, see Detail A6/A11.7.
- L. For equipment not identified on plan, see Equipment drawings and workbook-Increment #7, Vol. 2E.
- M. For partial enlarged plan at janitor closets, see Detail A3/A11.7.
- N. Public/handicapped restroom graphics will be furnished and installed by the Owner's graphics supplier.
- O. Standard equipment wall mounting heights, see detail A2/A11.9.
- P. Medical equipment wall mounting heights, see details A4/A11.9, D3/A11.9 & D0.02-Increment #7, Vol. 2E.
- Q. Fire Protection equipment wall mounting heights, see detail D2/A11.9.
- R. Communication equipment wall mounting heights, see detail A3/A11.9.
- S. Equipment mounting heights at Countertops, see detail D3/A11.9.
- T. Equipment mounting heights at Desks, see detail A4/A11.9.
- U. A minimum head clearance of 6'-8" must be maintained at all points in stairways including stair and landing framing.
- V. For all closed in equipment not identified, refer to EQ drawing series-Increment #7, Vol. 2E and Equipment workbook. Specific items requiring structural support are cross referenced to structural support details via matrix shown on the Equipment drawings-Increment #7, Vol. 2E.
- W. All elevator hoist way entrance frames to have an embossed stainless steel graphic plaque with the floor landing number and Standard Braille markings for the blind. Conform to governing Accessibility codes and standards.
- X. All stair floor landings to receive stencil pointed, semi-gloss enamel floor landing numerals 12" high adjacent to the door at 5'-0" AFF in a contrasting color to the scheduled wall color unless a graphic plaque is specifically detailed or noted.
- Y. Elevator Equipment Wall Mounting Heights, see detail A6/A11.9 and B3/A11.9.
- Z. Doors, Frames, Sillplates and Windows (See Door Schedule). See A11 sheet series.
- AA. Provide wall blocking/backing for items weighing 20lbs or less. See A5/A11.3.1.
- BB. For personal effects storage unit types and sizes see A4/A11.8.
- CC. For typical equipment backing support, see A4/S1.1-Increment #5.
- DD. For boundaries of alternates and phasing, see the A9 drawing series.
- EE. Provide 3" grommet, unless otherwise noted at 3'-0" O.C. maximum, field located at all electrical components at Nurses stations and Reception desks.
- FF. For vertical mounting heights of service accessories, see Detail A3/A11.
- GG. Provide access panels below the Patient Room countertops to serve as inspection ports for the Patient Room bathbaths.

Note: RFI 318
Changed WC-4 to WC-3 at Non-ADA
toilets. Locate WC-3 15" from wall.

RFI 2324
Panels to be 1'-3" AFF
14"x14"

B1 GENERAL NOTES

ROOM 5.116 TYPICAL
WALL AREA:
Section A 3'-0" x 8'-0" = 24 SQ.FT.
Section B 3'-0" x 8'-0" = 24 SQ.FT.
Section C 11'-9" x 8'-3" = 75 SQ.FT.
Total = 123 SQ.FT.
Less Door Opening 4'-0" x 7'-0" = 28 SQ.FT.
Total Corridor Wall = 95 SQ.FT.
95 SQ.FT. X 25% = 23.75 SQ.FT. Allowable Glazed Area
ACTUAL GLAZING AREA (2 1/2" FRAME):
Section A 2'-2" x 3'-6" = 7.6 SQ.FT.
Section B 2'-3" x 3'-6" = 7.9 SQ.FT.
Total = 15.5 SQ.FT.

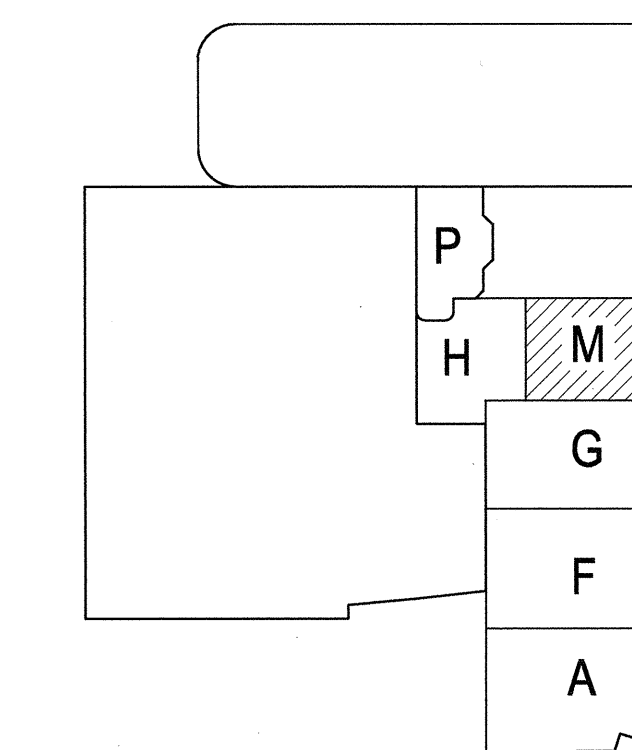

A1 KEY PLAN

A3 GLAZING AREA TABULATION

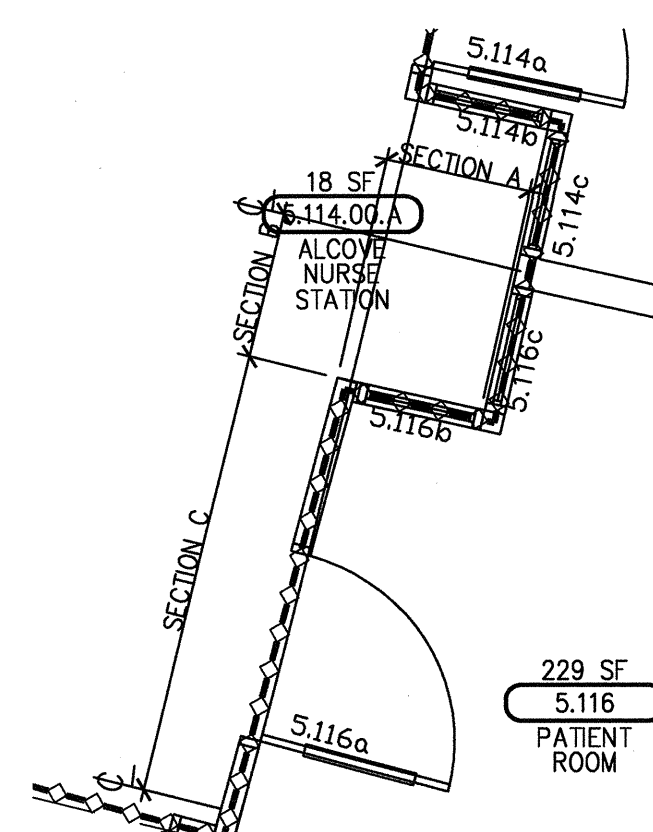

ARCHITECT OF RECORD
Paul C. Gloriot

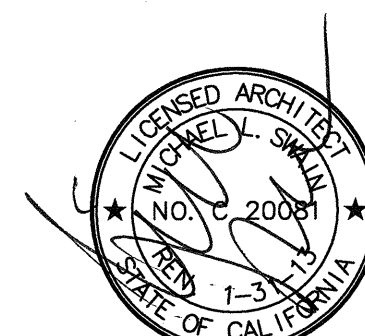

Changes on these drawings do not consist of
materially altered changes to approved drawings
and don't require a change order.
OSHPD review ACO
OSHPD review FLSO
OSHPD review DSE

REVISIONS

| NO. | DATE | DESCRIPTION |
|-----|----------|-------------|
| 44 | 05/28/10 | ASI #08 |
| 39 | 12/01/10 | ASI #48 |
| 19 | 05/09/11 | CO #170 |
| 48 | 05/29/11 | ASI #84 |
| 57 | 11/02/11 | CO#264 |

PAD-2011-02522

APPROVAL

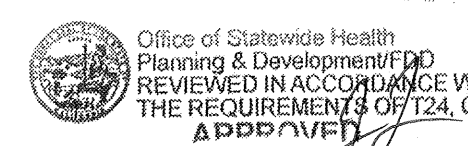

CHANGE ORDER 364
INSTRUCTION BULLETIN
DEFERRED APPROVAL
ADDENDUM

PROJECT NAME

CHILDREN'S HOSPITAL
OF ORANGE COUNTY

455 S. Main St.
Orange, CA 92668-3874

TOWER II



PROJECT NUMBER

12011.00
Increment #7

OSHPD - PROJECT NUMBER
IL 072072-30

ISSUE
OSHPD PERMIT

DATE
01/27/2010

SCALE

1/4" = 1' - 0"

DRAWING TITLE

LEVEL 5 ENLARGED PLAN
AHEAD - M

DRAWING NUMBER

A3.5M