

1/22/2008 4:52:10 PM  
File Path  
\\sfs\shared\projects\200725\200725.dwg

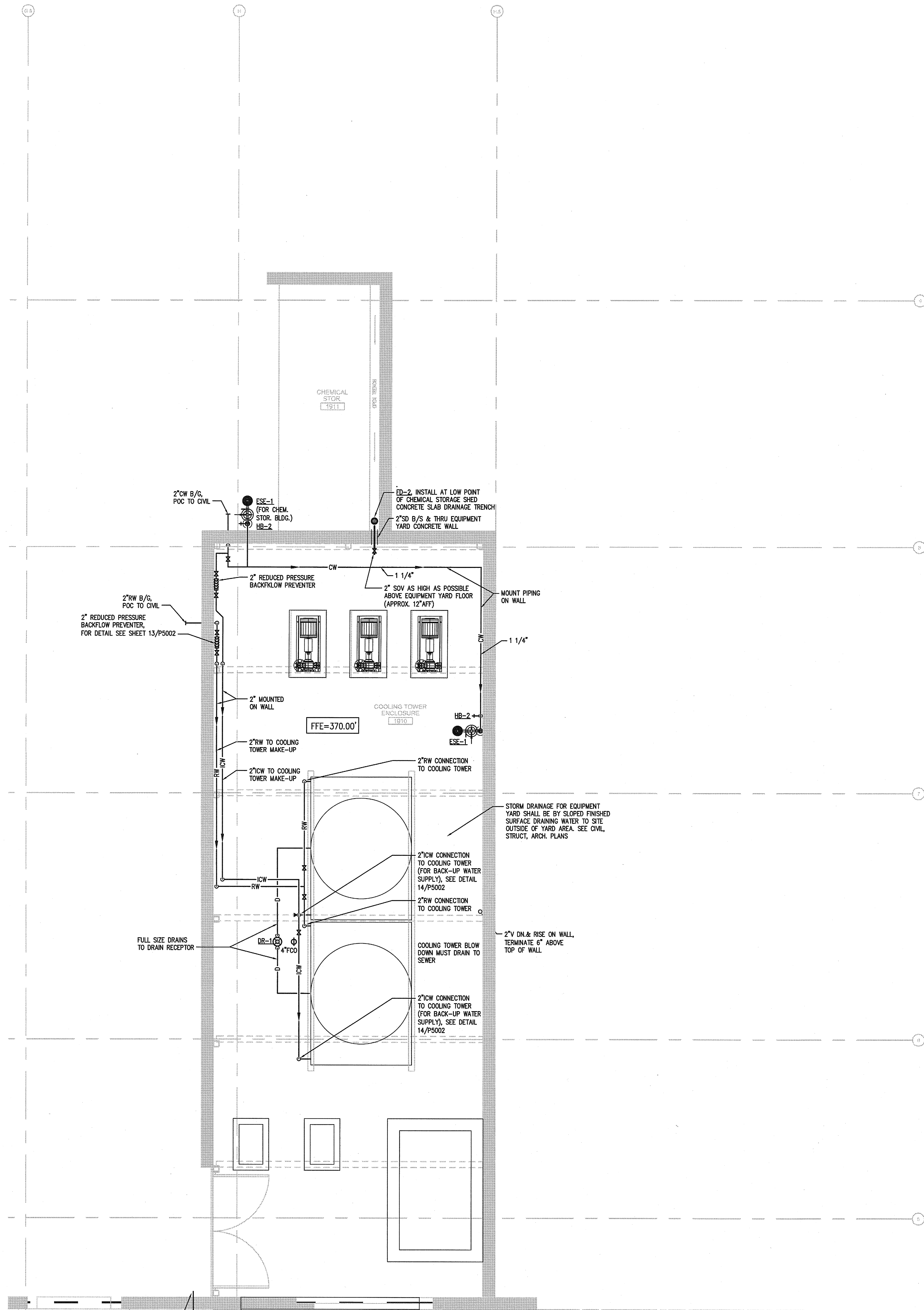

PARTIAL PLUMBING FIRST FLOOR PLAN - ZONE 5

Warning: It is a violation of the law for any person, unless acting under the direction of a licensed architect, to alter an item in any way. If an item in this document is altered, the altering architect, if other than the architect of record, shall affix the item his seal and the notation "altered by" followed by his signature and the date of such alteration, and the specific description of the alteration.



SCALE  
1/4" = 1'-0"

1

U.C.S.D.	
<input type="checkbox"/>	PRELIMINARY DRAWINGS
<input type="checkbox"/>	PROGRESS DRAWINGS
<input type="checkbox"/>	REVIEW DRAWINGS
<input checked="" type="checkbox"/>	CONSTRUCTION DRAWINGS

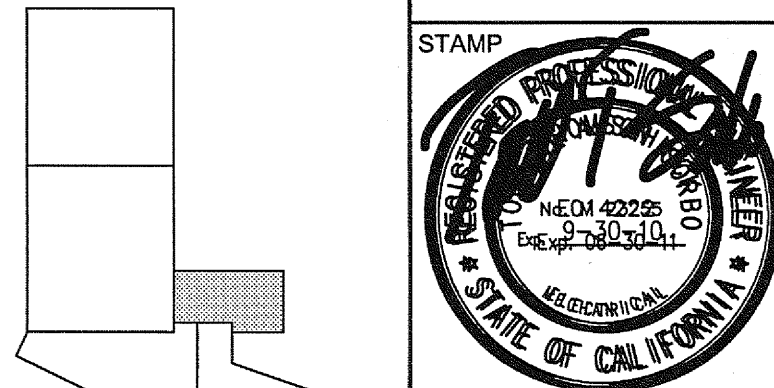
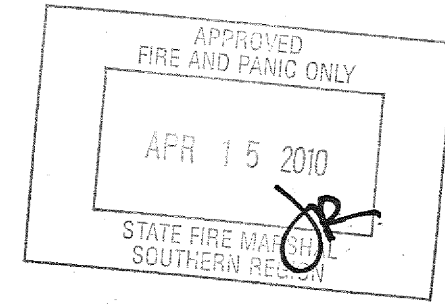

SHEET NAME  
PARTIAL PLUMBING FIRST  
FLOOR PLAN - ZONE 5  
DRAWN BY: Author  
PROJECT #: 200725.000  
SHEET NUMBER

P2215



CONSULTANT  
**Sanford Consortium for Regenerative Medicine**  
San Diego, CA 92161  
619.594.1000  
www.sanfordconsortium.org

LandfordPharm Consortium LLC  
San Diego, CA 92161  
619.594.1000  
www.landfordpharm.com

FENTRESS ARCHITECTS  
San Diego, CA 92161  
619.594.1000  
www.fentressarchitects.com



SHEET NAME  
PARTIAL PLUMBING FIRST  
FLOOR PLAN - ZONE 5  
DRAWN BY: Author  
PROJECT #: 200725.000  
SHEET NUMBER

P2215

WORK ORDER NO. 431587

SANFORD CONSORTIUM FOR REGENERATIVE MEDICINE

2880 TORREY PINES SCENIC DRIVE  
LA JOLLA, CALIFORNIA 92037

RW 2909

COPYRIGHT © FENTRESS ARCHITECTS	
ISSUED FOR	DATE
Pre-Schematic Design	07/14/2008
Schematic Design	07/28/2008
BID PK #1	10/06/2008
50% Progress	10/24/2008
BID PK #1 80 CD	12/01/2008
BID PK #1 100 CD	02/18/2009
BID PK #2 100 CD	03/24/2009
100% CD	06/08/2009
CD 4	01/07/2010
CD 1	02/28/2010
CD 2	02/28/2010
CD 4	04/16/2010