

## Part B Answer

RFI Title: Framing Solution for Lavatory Wall in Typical Member Bathroom.

RFI References: drawing 1B/A9.05, Attachment #1, and Attachment #2

Due to the large amount of backing and the Electrical and Plumbing penetrations in the lavatory wall of a Typical Member Bathroom, the congested space does not allow for vertical studs to run up the wall. (See attachment #1) This condition exists at back-to-back lavatories (i.e. Member Toilets 1A-150T and 1A-151T) and lavatories opposite of interior walls (i.e. Member Toilet 1A-152T). To accommodate all backing requirements and without relocating the plumbing and electrical rough-in locations, Hensel Phelps proposes to frame the wall using horizontal members, in lieu of vertical members. Horizontal framing will prevent notching of studs and allow the backing and rough-in to be installed in a timely manner with quality. Please confirm the proposed horizontal framing shown in Attachment #2 is acceptable.

# TYPICAL MEMBER TOILET ROUGH-IN

**PART B Answer**  
**(Attachement #1)**

Notes;

All dimensions are from finish floor  
and/or face of stud.

Drawing is not to scale.

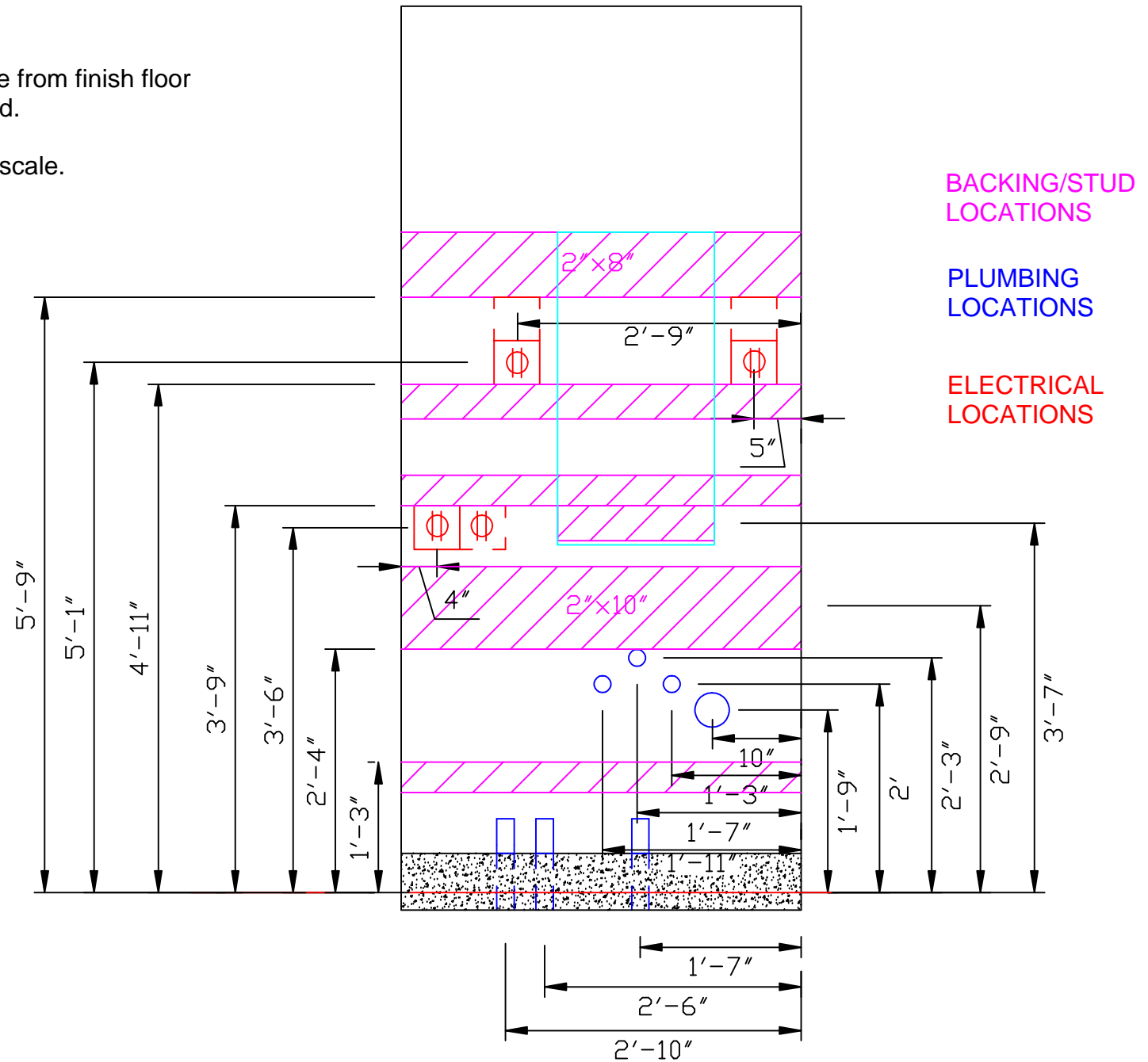

**PART B Answer**  
**(Attachement #2)**

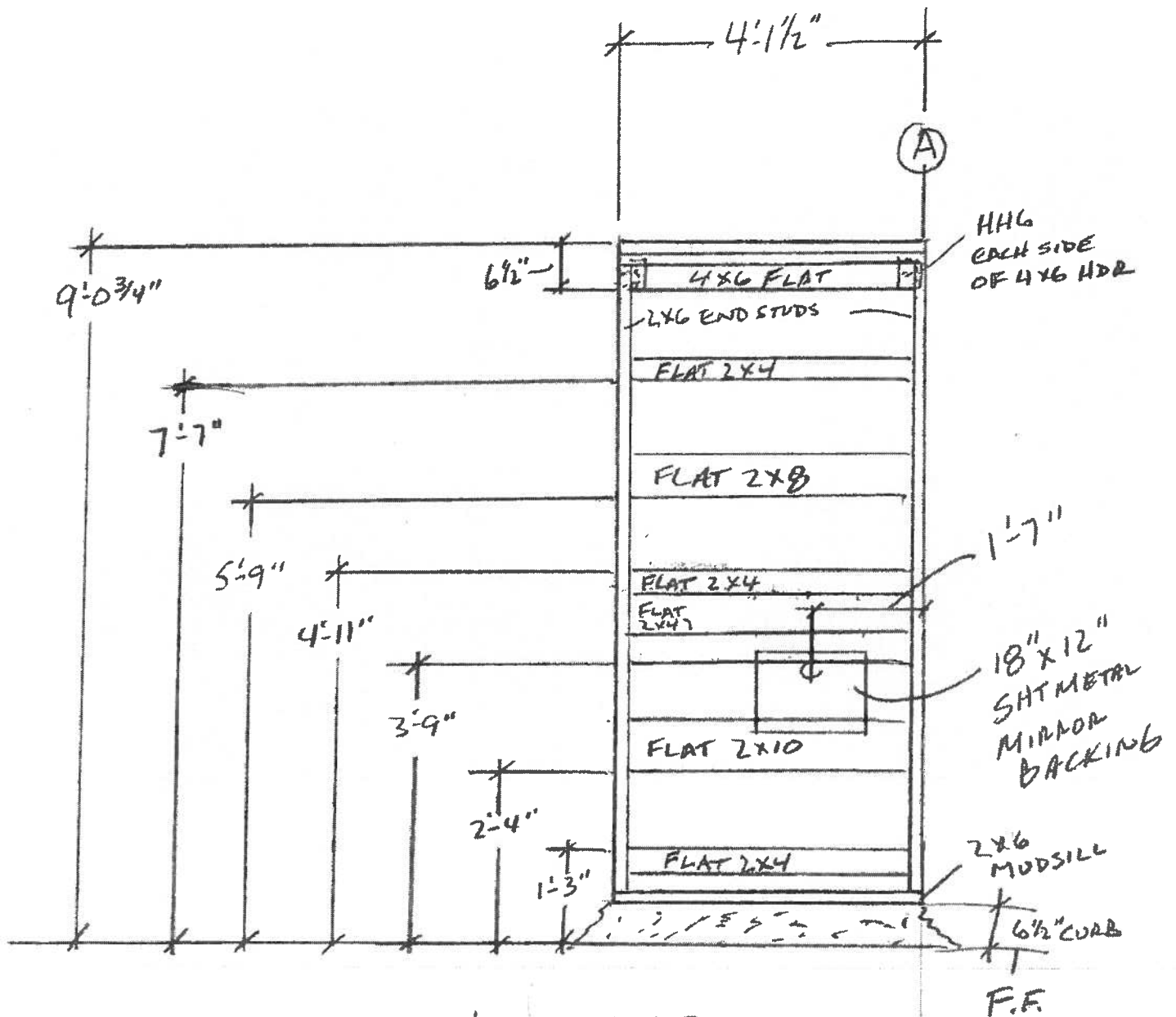

NOTE: FLAT 2X'S OCCUR AT BOTH SIDES OF WALL