

FOUNDATIONS

MITHUN

SEATTLE / P.O. Box 55, 1201 Alaskan Way, #200
Seattle, WA 98101 / 206.463.3344
SAN FRANCISCO / 605 Market Street, #300
San Francisco, CA 94104 / 415.560.0808

ARCHITECT, LANDSCAPE ARCHITECT, INTERIOR DESIGNERS
MITHUN, INC.

STRUCTURAL ENGINEER
DCI ENGINEERS
101 W. Broadway, #200
San Diego, CA 92101
(619) 594-0901

CIVIL ENGINEER
KHR ENGINEERS
4100 Newport Place Drive, #200
Newport Beach, CA 92660
(949) 736-6400

MECHANICAL / PLUMBING ENGINEER
HARTFORD ENGINEERING
11440 West Bernardo Court, #202
San Diego, CA 92121
(619) 527-7712

ELECTRICAL ENGINEER
MICHAEL WALL ENGINEERING
19802 Avenida Buena Vista, #200
Irvine, CA 92612
(949) 452-0900

DESIGN BUILDER
HENSEL PHELPS
10800 Van Kester Avenue, #100
Irvine, CA 92618
(949) 452-0111

HENSEL PHELPS
Plan. Build. Manage.

PROJECT
Project Name Here

LOCATION
Enter address by clicking
Manage Tab and Project
Information
PREPARED FOR

UCI
University of California, Irvine
Design & Construction
Services
5201 California Ave Suite 250
Irvine, CA 92697

UCI PROJECT NO.
996296

REVISION

NO. DATE REVISION

PROJECT DIRECTOR

PROJECT MANAGER

PROJECT ARCHITECT

PROJECT TEAM MEMBERS

CHECK

ARCHITECT SEAL

TITLE
LOWER LEVEL FLOOR
PLAN
PROJECT NO.
14051-0020
DATE
5-30-2014

SHEET NUMBER
S2.00
Project Status
© 2014 MITHUN, INC.

POUR BREAKDOWN
AND COLORS

- = POUR 1
- = POUR 2
- = POUR 3
- = POUR 4
- = POUR 5,

FOUNDATION PLAN NOTES:

- STRUCTURAL GENERAL NOTES, DESIGN CRITERIA, ABBREVIATIONS AND LEGEND PER S1.01, S1.02, S1.03 AND S1.04.
- VERIFY ALL DIMENSIONS AND ELEVATIONS WITH THE ARCHITECTURAL DRAWINGS.
- CONTRACTOR SHALL LOCATE AND VERIFY THE FOLLOWING WITH OTHERS PRIOR TO POURING CONCRETE: ALL DOOR OPENINGS IN FOUNDATION WALLS; DRAINS AND SLOPES; BLOCKOUTS; CHASES AND PIPES PER MECHANICAL, PLUMBING, ELECTRICAL AND SPRINKLER DRAWINGS; STAIR DETAILS AND GUARDRAILS PER ARCHITECTURAL DRAWINGS.
- ALL FOOTINGS AND SLABS TO BEAR ON COMPETENT NATIVE SOIL AND/OR STRUCTURAL FILL. SUBGRADE PREPARATION, STRUCTURAL FILL, FOOTING DRAINS, AND OTHER REQUIREMENTS PER GEOTECH REPORT AS NOTED IN THE STRUCTURAL GENERAL NOTES.
- CJ INDICATES CONTROL JOINT PER PLAN.
- MOISTURE PROOF PER ARCHITECT.
- STEEL STAIRS SHALL BE BIDDER-DESIGNED, UNO. APPLICABLE DESIGN REQUIREMENTS PER STRUCTURAL GENERAL NOTES.
- TYPICAL DETAILS PER:
 - S3.01 FOUNDATION
 - S4.01 COLUMNS
 - S4.02 SHEAR WALLS
 - S5.01-S5.03 CONCRETE

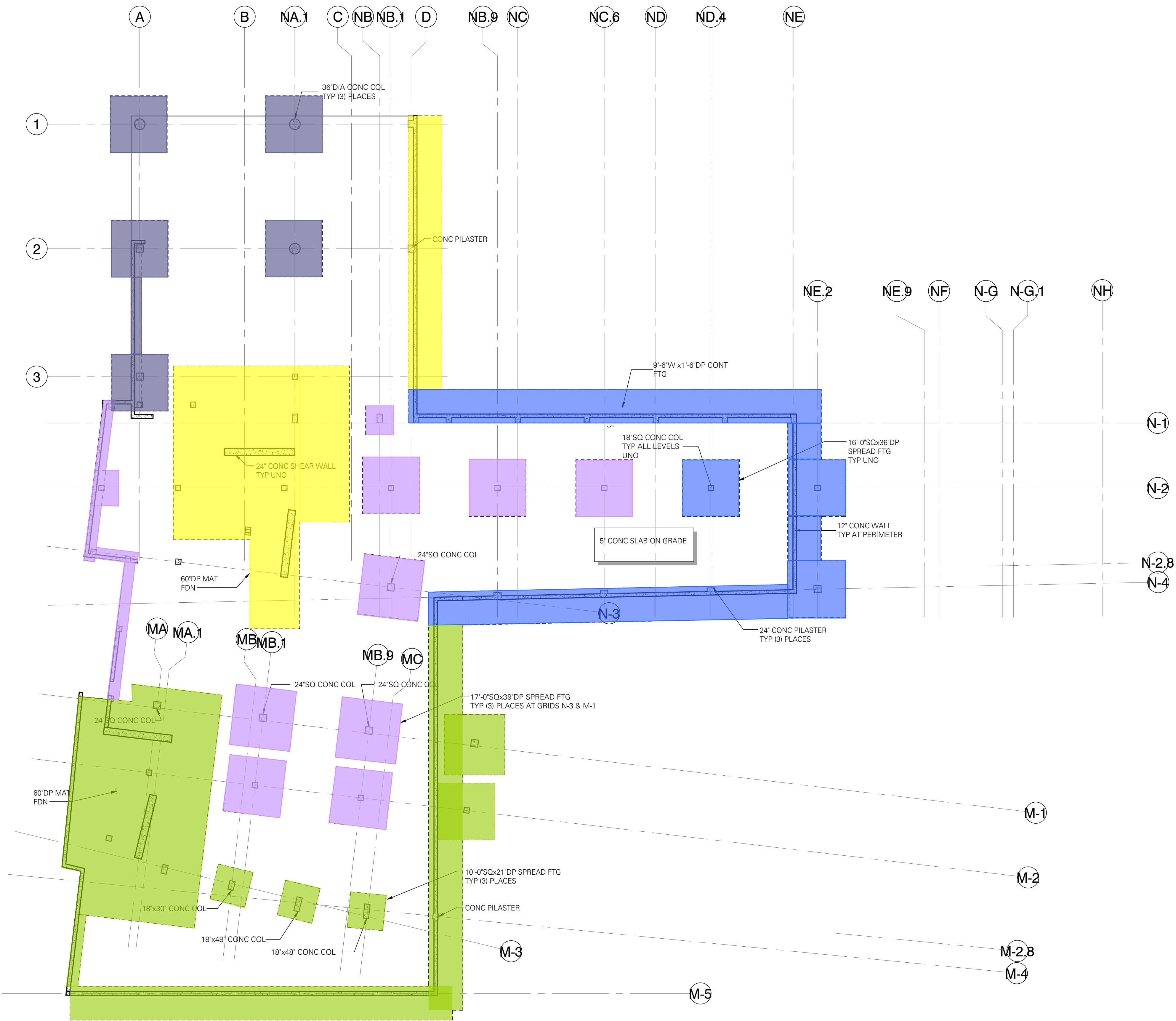

LOWER LEVEL
SCALE: 1/16" = 1'-0"



NOT FOR CONSTRUCTION

WALLS AND COLUMNS

POUR BREAKDOWN
AND COLORS

- = POUR 1
- = POUR 2
- = POUR 3
- = POUR 4
- = POUR 5
- = POUR 6
- = POUR 7
- = POUR 8

FOUNDATION PLAN NOTES:

- STRUCTURAL GENERAL NOTES, DESIGN CRITERIA, ABBREVIATIONS AND LEGEND PER S1.01, S1.02, S1.03 AND S1.04.
- VERIFY ALL DIMENSIONS AND ELEVATIONS WITH THE ARCHITECTURAL DRAWINGS.
- CONTRACTOR SHALL LOCATE AND VERIFY THE FOLLOWING WITH OTHERS PRIOR TO POURING CONCRETE: ALL DOOR OPENINGS IN FOUNDATION WALLS; DRAINS AND SLOPES; BLOCKOUTS; CHASES AND PIPES PER MECHANICAL, PLUMBING, ELECTRICAL AND SPRINKLER DRAWINGS; STAIR DETAILS AND GUARDRAILS PER ARCHITECTURAL DRAWINGS.
- ALL FOOTINGS AND SLABS TO BEAR ON COMPETENT NATIVE SOIL AND/OR STRUCTURAL FILL. SUBGRADE PREPARATION, STRUCTURAL FILL, FOOTING DRAINS, AND OTHER REQUIREMENTS PER GEOTECH REPORT AS NOTED IN THE STRUCTURAL GENERAL NOTES.
- CJ INDICATES CONTROL JOINT PER PLAN.
- MOISTURE PROOF PER ARCHITECT.
- STEEL STAIRS SHALL BE BIDDER-DESIGNED, UNO. APPLICABLE DESIGN REQUIREMENTS PER STRUCTURAL GENERAL NOTES.
- TYPICAL DETAILS PER:
 - S3.01 FOUNDATION
 - S4.01 COLUMNS
 - S4.02 SHEAR WALLS
 - S5.01-S5.03 CONCRETE

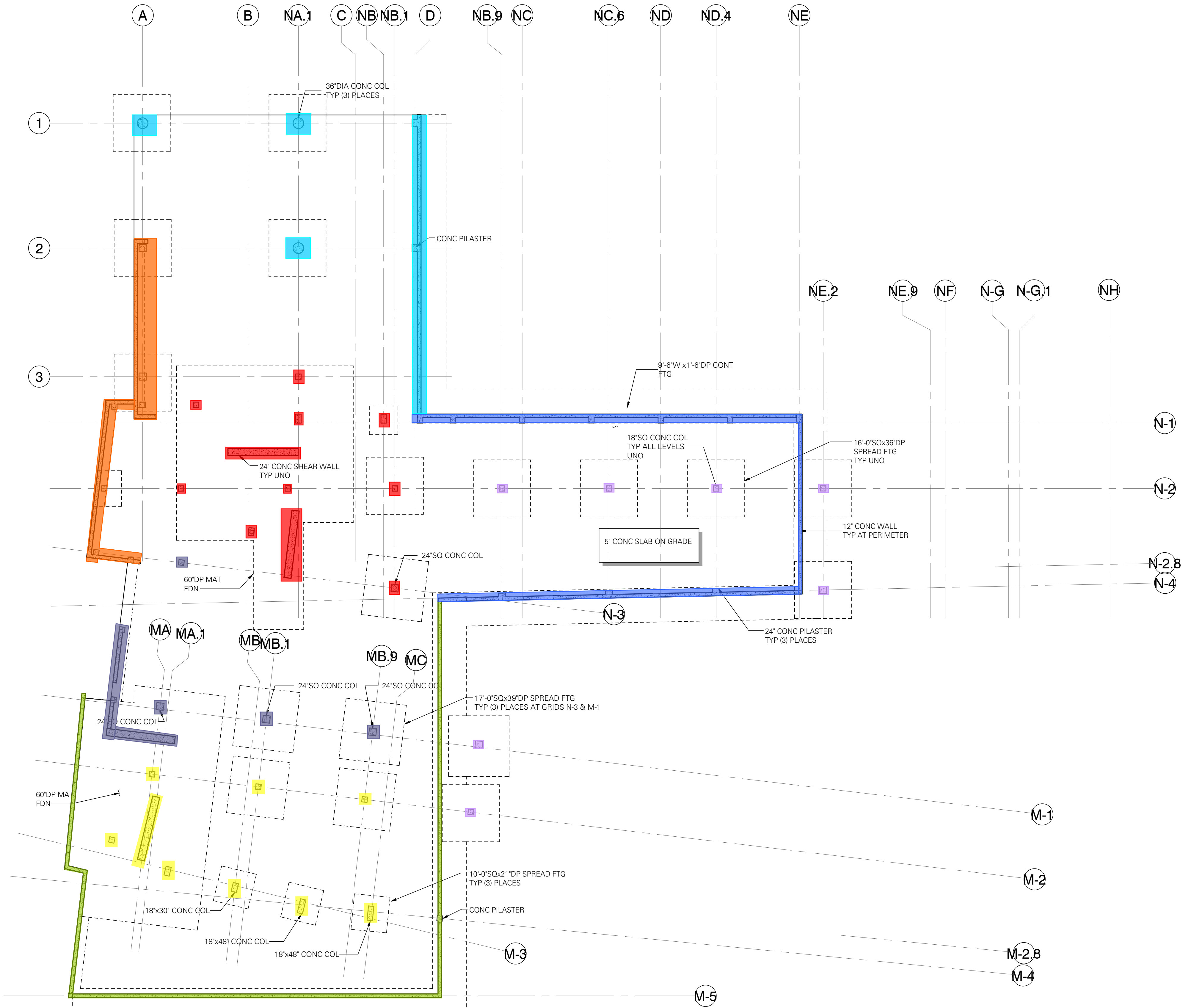

FOUNDATIONS

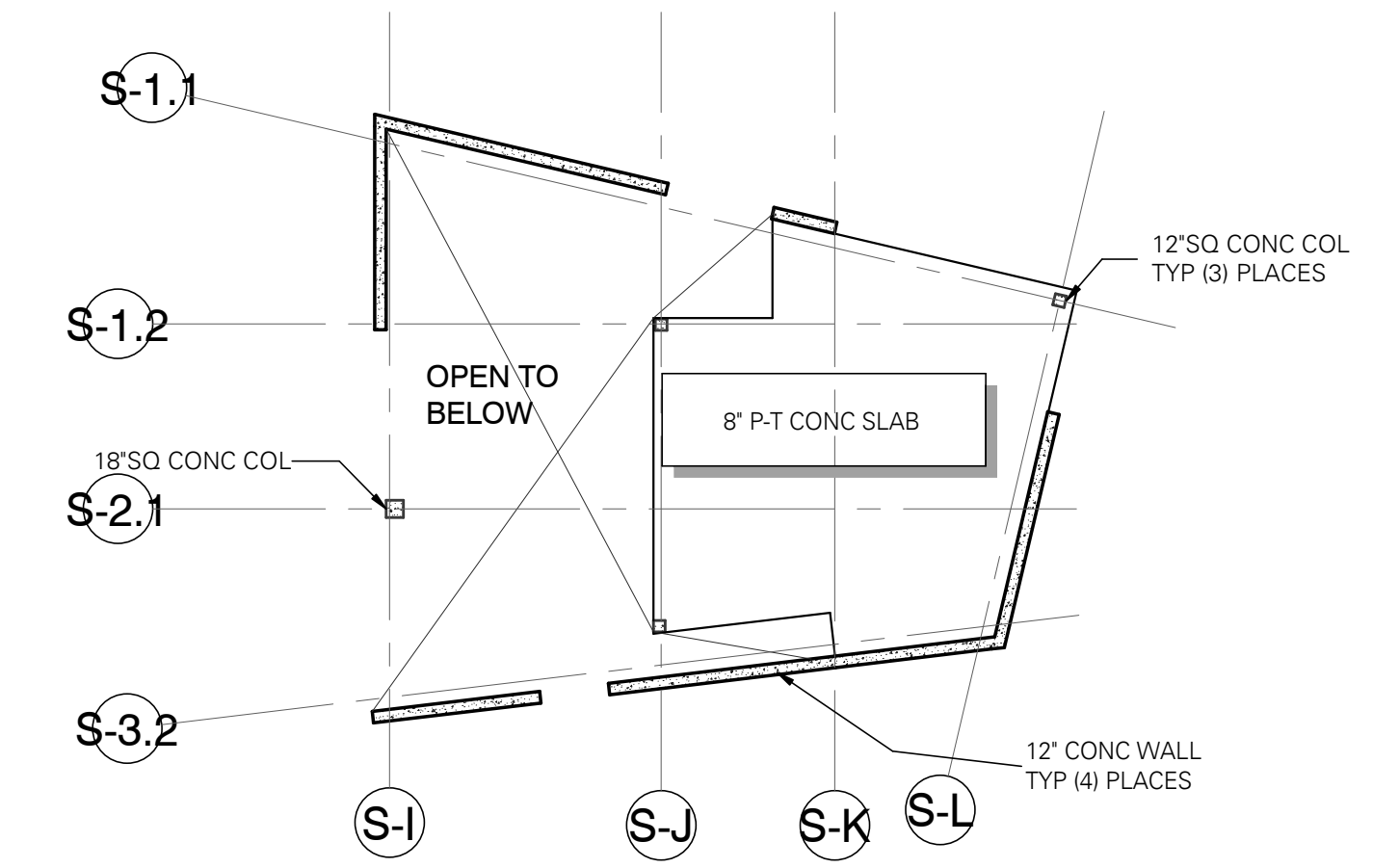
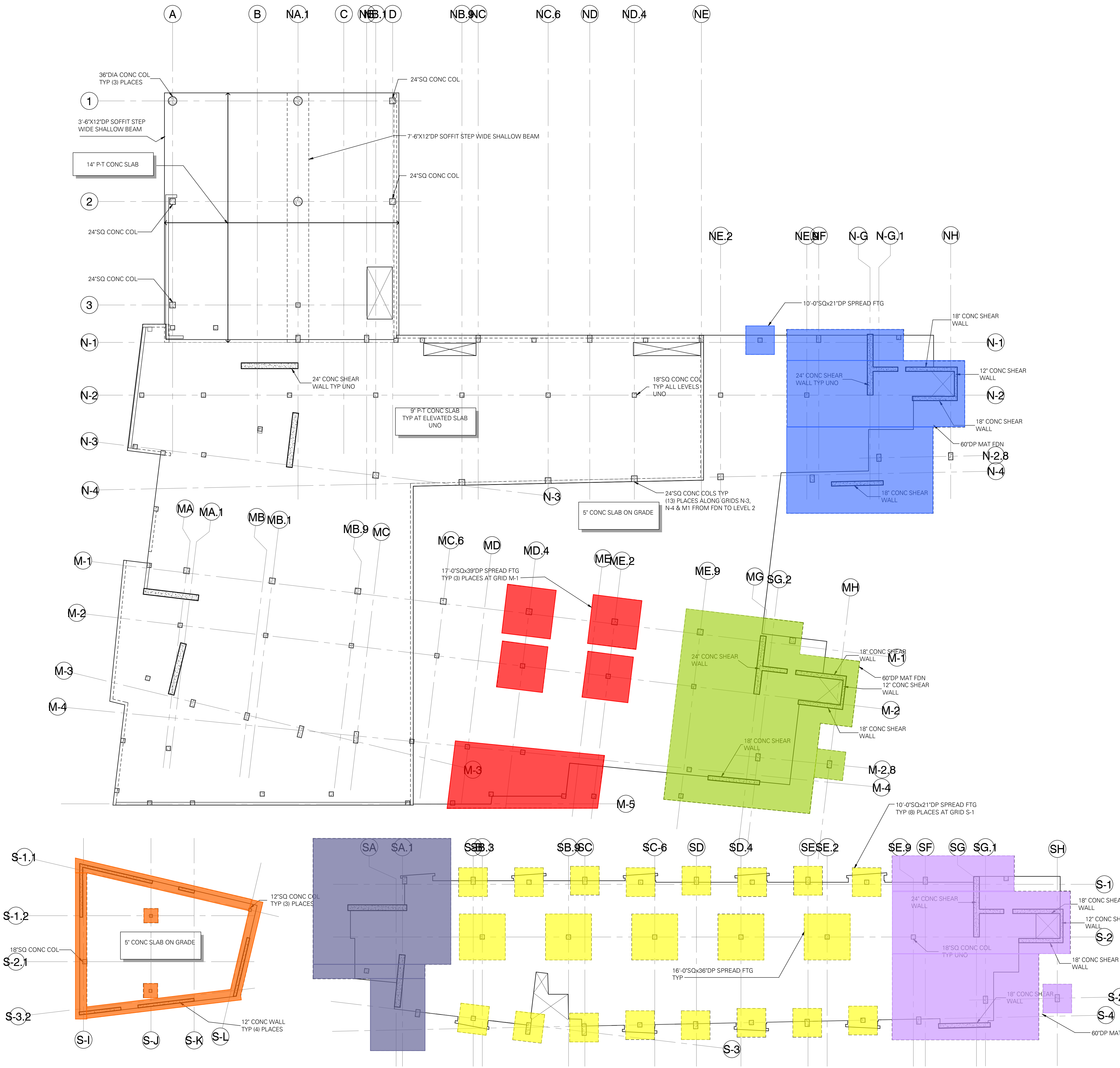

LEVEL 1M
SCALE: 1/16" = 1'-0"

POUR BREAKDOWN
AND COLORS

- [Blue Box] = POUR 1
- [Green Box] = POUR 2
- [Purple Box] = POUR 3
- [Yellow Box] = POUR 4
- [Dark Blue Box] = POUR 5
- [Red Box] = POUR 6
- [Orange Box] = POUR 7

MILD REINFORCING PLAN NOTES:

- STRUCTURAL GENERAL NOTES, DESIGN CRITERIA, ABBREVIATIONS AND LEGEND PER S1.01, S1.02, S1.03 AND S1.04.
- VERIFY ALL DIMENSIONS AND ELEVATIONS WITH THE ARCHITECTURAL DRAWINGS.
- POST-TENSIONED TENDON LAYOUT SHALL BE PER POST-TENSIONED FRAMING PLAN.
- CONTRACTOR IS RESPONSIBLE FOR THE DESIGN AND STAGING OF ALL SHORING AND RESHORING. SHORING PLACED BENEATH SLAB CLOSURE POURS SHALL NOT BE REMOVED UNTIL CLOSURE POUR CONCRETE HAS REACHED SPECIFIED STRENGTH.
- COLUMN OR WALL OVER-POURS INTO POST-TENSIONED SLABS SHALL NOT BE GREATER THAN 1/2" MAXIMUM. REMOVE ANY EXCESSIVE COLUMN OR WALL OVER-POURS PRIOR TO PLACING REINFORCING BARS AND POST-TENSIONED TENDONS.
- DO NOT INSTALL DRILL-IN ADHESIVE AND EXPANSION ANCHORS IN THE POST-TENSIONED SLAB. DRILLING INTO POST-TENSIONED SLAB WITHOUT APPROVAL FROM THE STRUCTURAL ENGINEER OF RECORD IS NOT PERMITTED. ALL BUILDING SYSTEMS: MECHANICAL, ELECTRICAL, PLUMBING, FIRE PROTECTION SHALL PLACE DUCTS, CHASES, PIPES OR PIPE SUPPORTS, CONDUIT SLEEVES AND HANGER INSERTS, ETC INTO THE POST-TENSIONED SLAB PRIOR TO POURING THE CONCRETE.
- ADDITIONAL SHAFTS MAY BE LOCATED AFTER THE SLAB IS POURED IF APPROVED BY THE STRUCTURAL ENGINEER AND COORDINATED WITH THE GENERAL CONTRACTOR.
- PROVIDE 1" CLEAR FOR ALL BOTTOM REINFORCING.
- CONTRACTOR TO COORDINATE EMBED PLATES REQUIRED FOR STAIRS, GUARDRAILS, INTERIOR AND EXTERIOR WALLS, WINDOW WASHING ANCHORS, ETC.
- TYPICAL DETAILS PER:
 - S3.01 FOUNDATION
 - S4.01 COLUMNS
 - S4.02 SHEAR WALLS
 - S5.01-S5.03 CONCRETE

LEVEL 1 FLOOR PLAN
SCALE: 1/16" = 1'-0"

SLAB ON GRADE

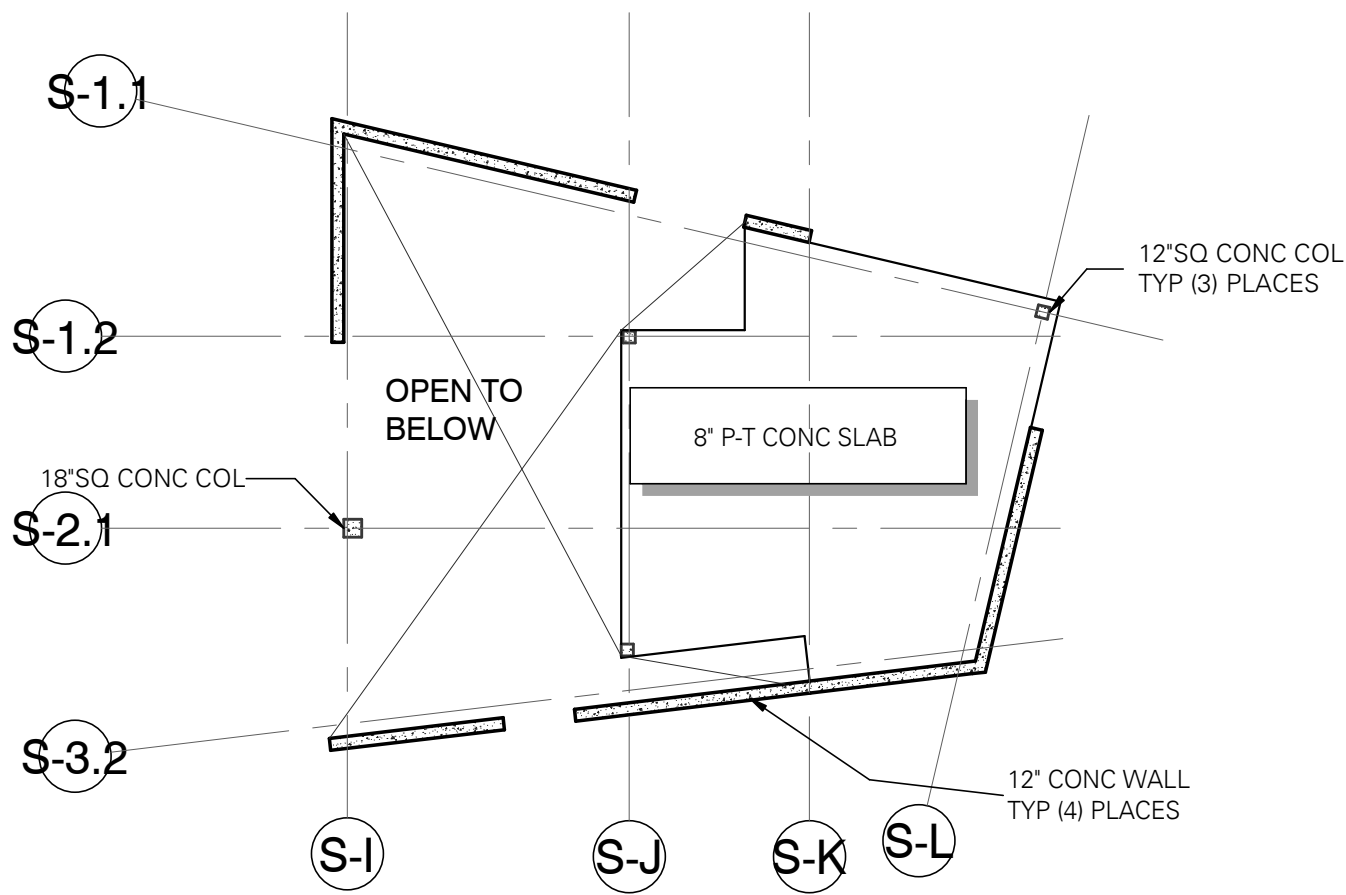

LEVEL 1M
SCALE: 1/16" = 1'-0"

POUR BREAKDOWN
AND COLORS

- = POUR 1
- = POUR 2
- = POUR 3
- = POUR 4
- = POUR 5

MILD REINFORCING PLAN NOTES:

- STRUCTURAL GENERAL NOTES, DESIGN CRITERIA, ABBREVIATIONS AND LEGEND PER S1.01, S1.02, S1.03 AND S1.04.
- VERIFY ALL DIMENSIONS AND ELEVATIONS WITH THE ARCHITECTURAL DRAWINGS.
- POST-TENSIONED TENDON LAYOUT SHALL BE PER POST-TENSIONED FRAMING PLAN.
- CONTRACTOR IS RESPONSIBLE FOR THE DESIGN AND STAGING OF ALL SHORING AND RESHORING. SHORING PLACED BENEATH SLAB CLOSURE POURS SHALL NOT BE REMOVED UNTIL CLOSURE POUR CONCRETE HAS REACHED SPECIFIED STRENGTH.
- COLUMN OR WALL OVER-POURS INTO POST-TENSIONED SLABS SHALL NOT BE GREATER THAN 1/2" MAXIMUM. REMOVE ANY EXCESSIVE COLUMN OR WALL OVER-POURS PRIOR TO PLACING REINFORCING BARS AND POST-TENSIONED TENDONS.
- DO NOT INSTALL DRILL-IN ADHESIVE AND EXPANSION ANCHORS IN THE POST-TENSIONED SLAB. DRILLING INTO POST-TENSIONED SLAB WITHOUT APPROVAL FROM THE STRUCTURAL ENGINEER OF RECORD IS NOT PERMITTED. ALL BUILDING SYSTEMS: MECHANICAL, ELECTRICAL, PLUMBING, FIRE PROTECTION SHALL PLACE DUCTS, CHASES, PIPES OR PIPE SUPPORTS, CONDUIT SLEEVES AND HANGER INSERTS, ETC INTO THE POST-TENSIONED SLAB PRIOR TO POURING THE CONCRETE.
- ADDITIONAL SHAFTS MAY BE LOCATED AFTER THE SLAB IS POURED IF APPROVED BY THE STRUCTURAL ENGINEER AND COORDINATED WITH THE GENERAL CONTRACTOR.
- PROVIDE 1" CLEAR FOR ALL BOTTOM REINFORCING.
- CONTRACTOR TO COORDINATE EMBED PLATES REQUIRED FOR STAIRS, GUARDRAILS, INTERIOR AND EXTERIOR WALLS, WINDOW WASHING ANCHORS, ETC.
- TYPICAL DETAILS PER:
 - S3.01 FOUNDATION
 - S4.01 COLUMNS
 - S4.02 SHEAR WALLS
 - S5.01-S5.03 CONCRETE

LEVEL 1 FLOOR PLAN
SCALE: 1/16" = 1'-0"



NOT FOR CONSTRUCTION

SLAB ON DECK

POUR BREAKDOWN AND COLORS

- = POUR 1
- = POUR 2
- = POUR 3

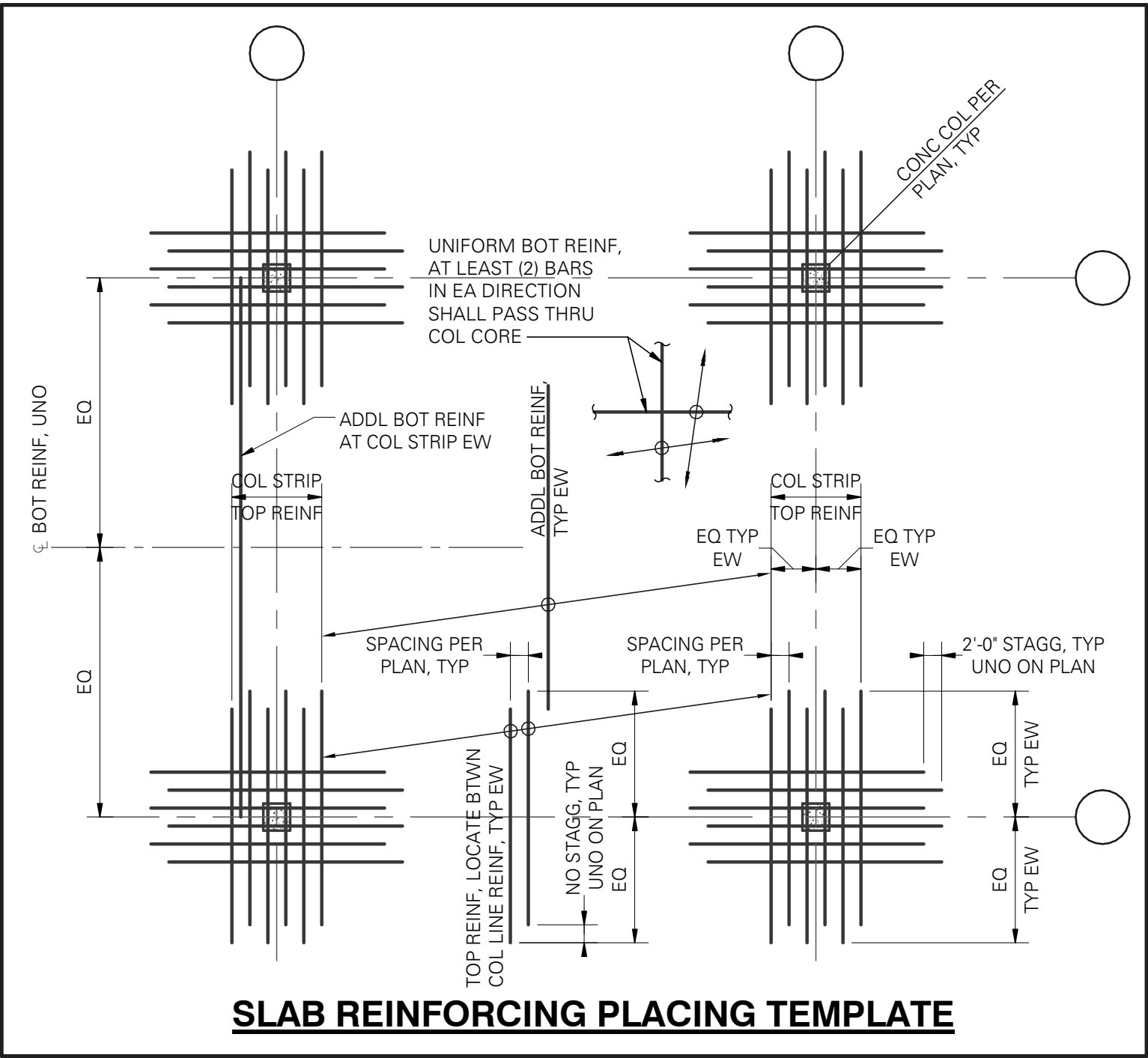
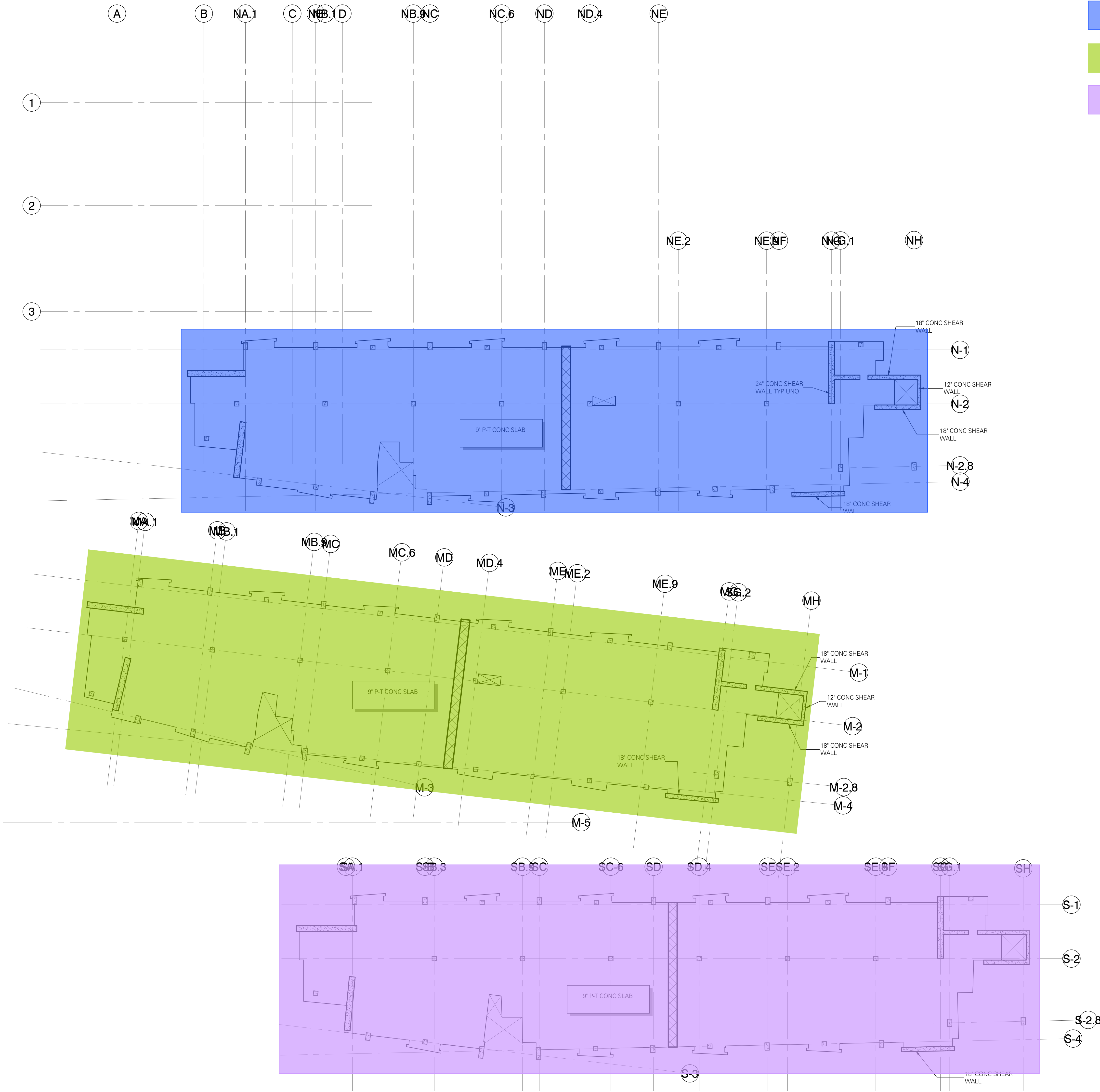

- MILD REINFORCING PLAN NOTES:
- STRUCTURAL GENERAL NOTES, DESIGN CRITERIA, ABBREVIATIONS AND LEGEND PER S1.01, S1.02, S1.03 AND S1.04.
 - VERIFY ALL DIMENSIONS AND ELEVATIONS WITH THE ARCHITECTURAL DRAWINGS.
 - POST-TENSIONED TENDON LAYOUT SHALL BE PER POST-TENSIONED FRAMING PLAN.
 - CONTRACTOR IS RESPONSIBLE FOR THE DESIGN AND STAGING OF ALL SHORING AND RESHORING. SHORING PLACED BENEATH SLAB CLOSURE POURS SHALL NOT BE REMOVED UNTIL CLOSURE POUR CONCRETE HAS REACHED SPECIFIED STRENGTH.
 - COLUMN OR WALL OVER-POURS INTO POST-TENSIONED SLABS SHALL NOT BE GREATER THAN 1/2\"/>

WALLS AND COLUMNS

POUR BREAKDOWN
AND COLORS

- = POUR 1
- = POUR 2
- = POUR 3
- = POUR 4
- = POUR 5
- = POUR 6

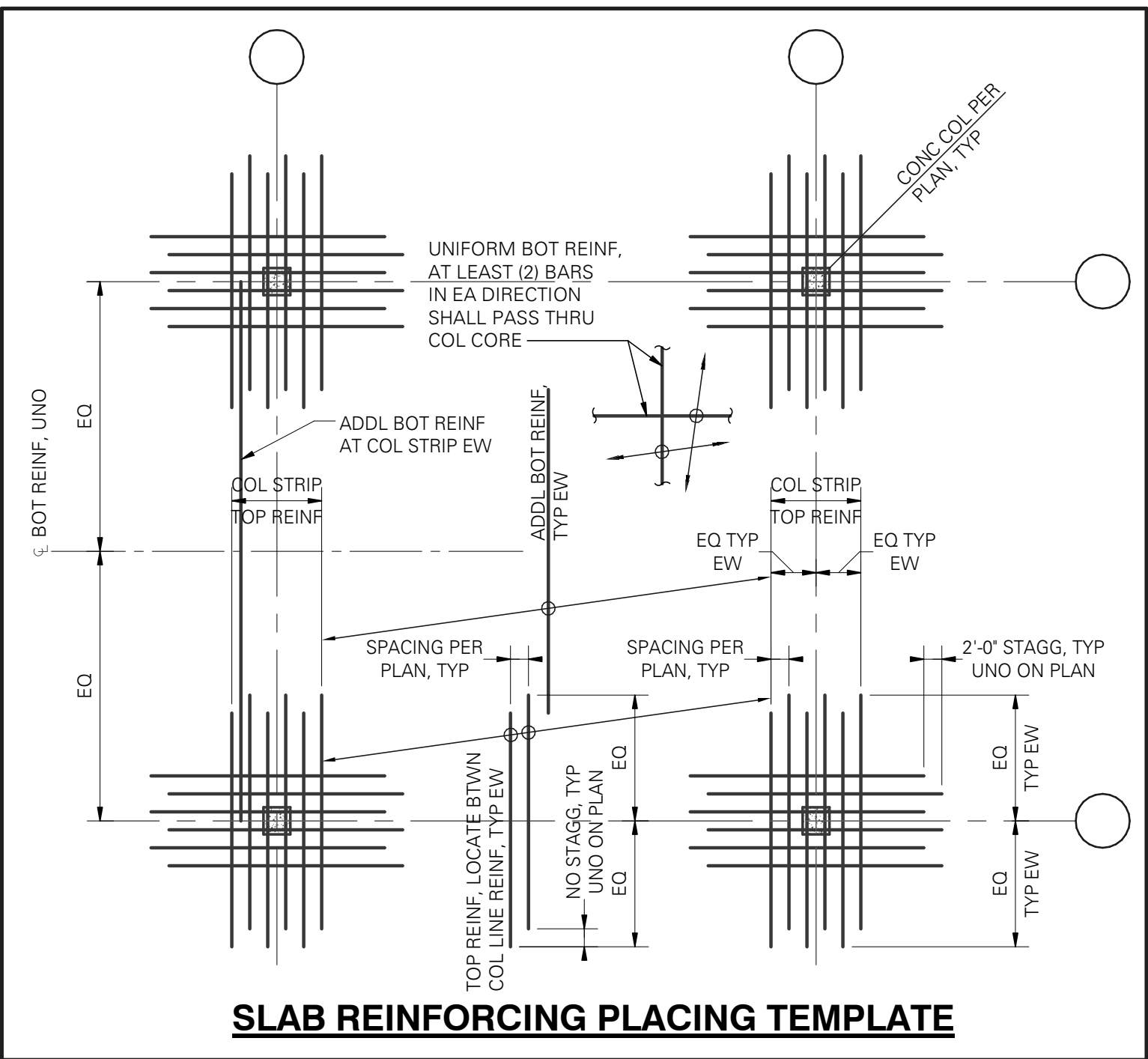

MILD REINFORCING PLAN NOTES:

- STRUCTURAL GENERAL NOTES, DESIGN CRITERIA, ABBREVIATIONS AND LEGEND PER S1.01, S1.02, S1.03 AND S1.04.
- VERIFY ALL DIMENSIONS AND ELEVATIONS WITH THE ARCHITECTURAL DRAWINGS.
- POST-TENSIONED TENDON LAYOUT SHALL BE PER POST-TENSIONED FRAMING PLAN.
- CONTRACTOR IS RESPONSIBLE FOR THE DESIGN AND STAGING OF ALL SHORING AND RESHORING. SHORING PLACED BENEATH SLAB CLOSURE POURS SHALL NOT BE REMOVED UNTIL CLOSURE POUR CONCRETE HAS REACHED SPECIFIED STRENGTH.
- COLUMN OR WALL OVER-POURS INTO POST-TENSIONED SLABS SHALL NOT BE GREATER THAN 1/2" MAXIMUM. REMOVE ANY EXCESSIVE COLUMN OR WALL OVER-POURS PRIOR TO PLACING REINFORCING BARS AND POST-TENSIONED TENDONS.
- DO NOT INSTALL DRILL-IN ADHESIVE AND EXPANSION ANCHORS IN THE POST-TENSIONED SLAB. DRILLING INTO POST-TENSIONED SLAB WITHOUT APPROVAL FROM THE STRUCTURAL ENGINEER OF RECORD IS NOT PERMITTED. ALL BUILDING SYSTEMS: MECHANICAL, ELECTRICAL, PLUMBING, FIRE PROTECTION SHALL PLACE DUCTS, CHASES, PIPES OR PIPE SUPPORTS, CONDUIT SLEEVES AND HANGER INSERTS, ETC INTO THE POST-TENSIONED SLAB PRIOR TO POURING THE CONCRETE.
- ADDITIONAL SHAFTS MAY BE LOCATED AFTER THE SLAB IS POURED IF APPROVED BY THE STRUCTURAL ENGINEER AND COORDINATED WITH THE GENERAL CONTRACTOR.
- PROVIDE 1" CLEAR FOR ALL BOTTOM REINFORCING.
- CONTRACTOR TO COORDINATE EMBED PLATES REQUIRED FOR STAIRS, GUARDRAILS, INTERIOR AND EXTERIOR WALLS, WINDOW WASHING ANCHORS, ETC.
- TYPICAL DETAILS PER:
 - S3.01 FOUNDATION
 - S4.01 COLUMNS
 - S4.02 SHEAR WALLS
 - S5.01-S5.03 CONCRETE

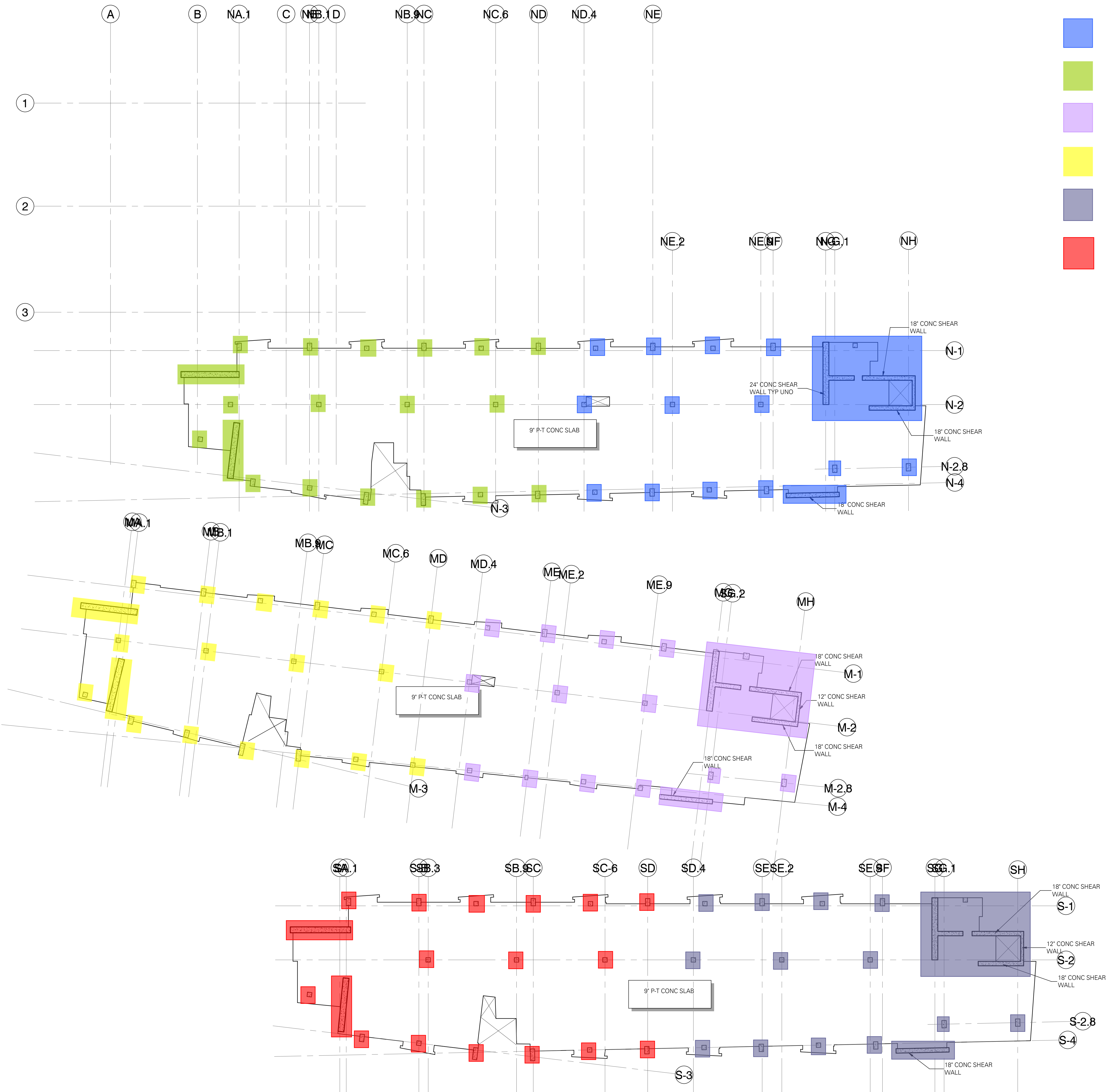

LEVEL 4 FLOOR PLAN

SCALE: 1/16" = 1'-0"



NOT FOR CONSTRUCTION

SLAB ON DECK

POUR BREAKDOWN
AND COLORS

- = POUR 1
- = POUR 2
- = POUR 3

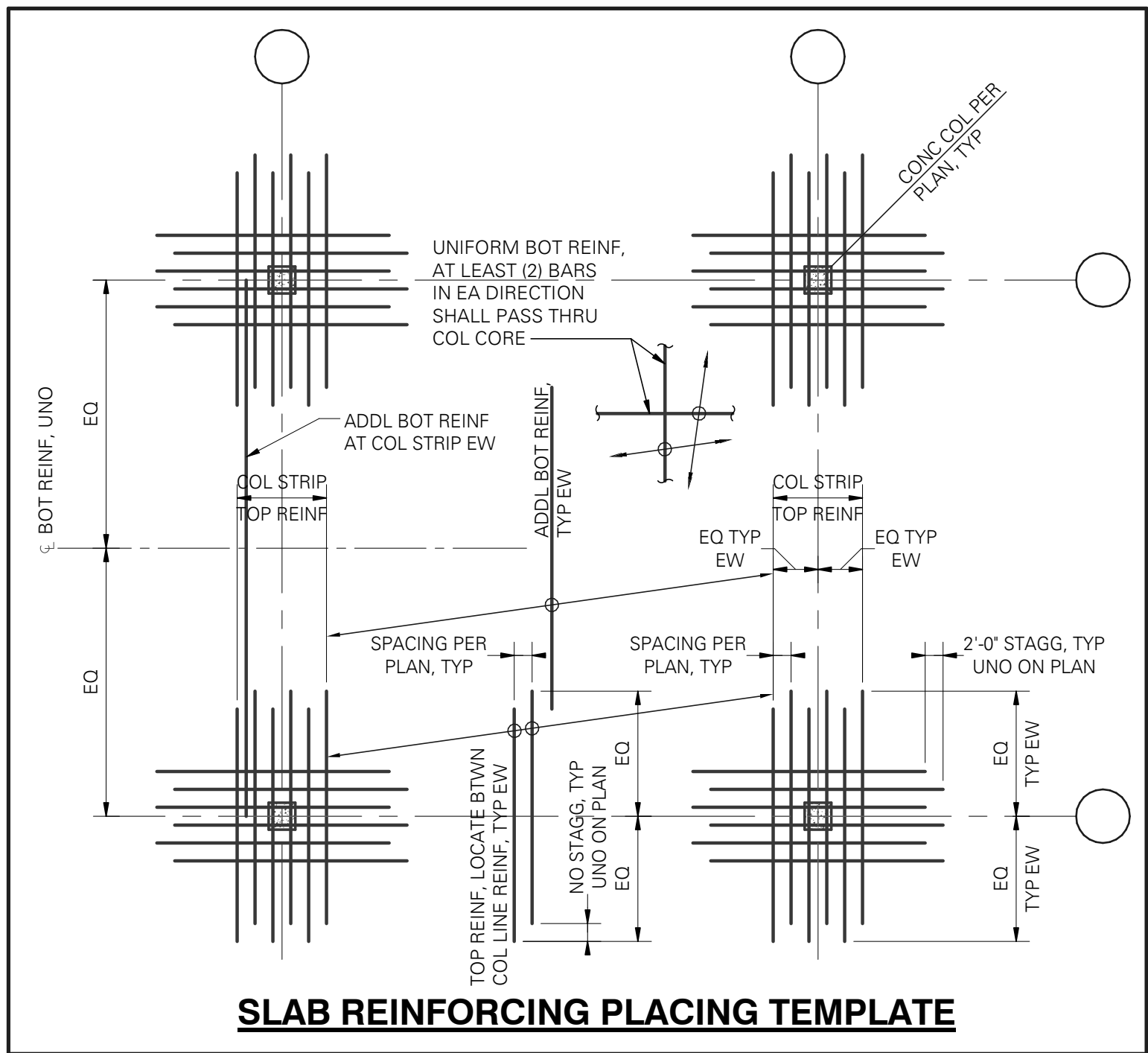
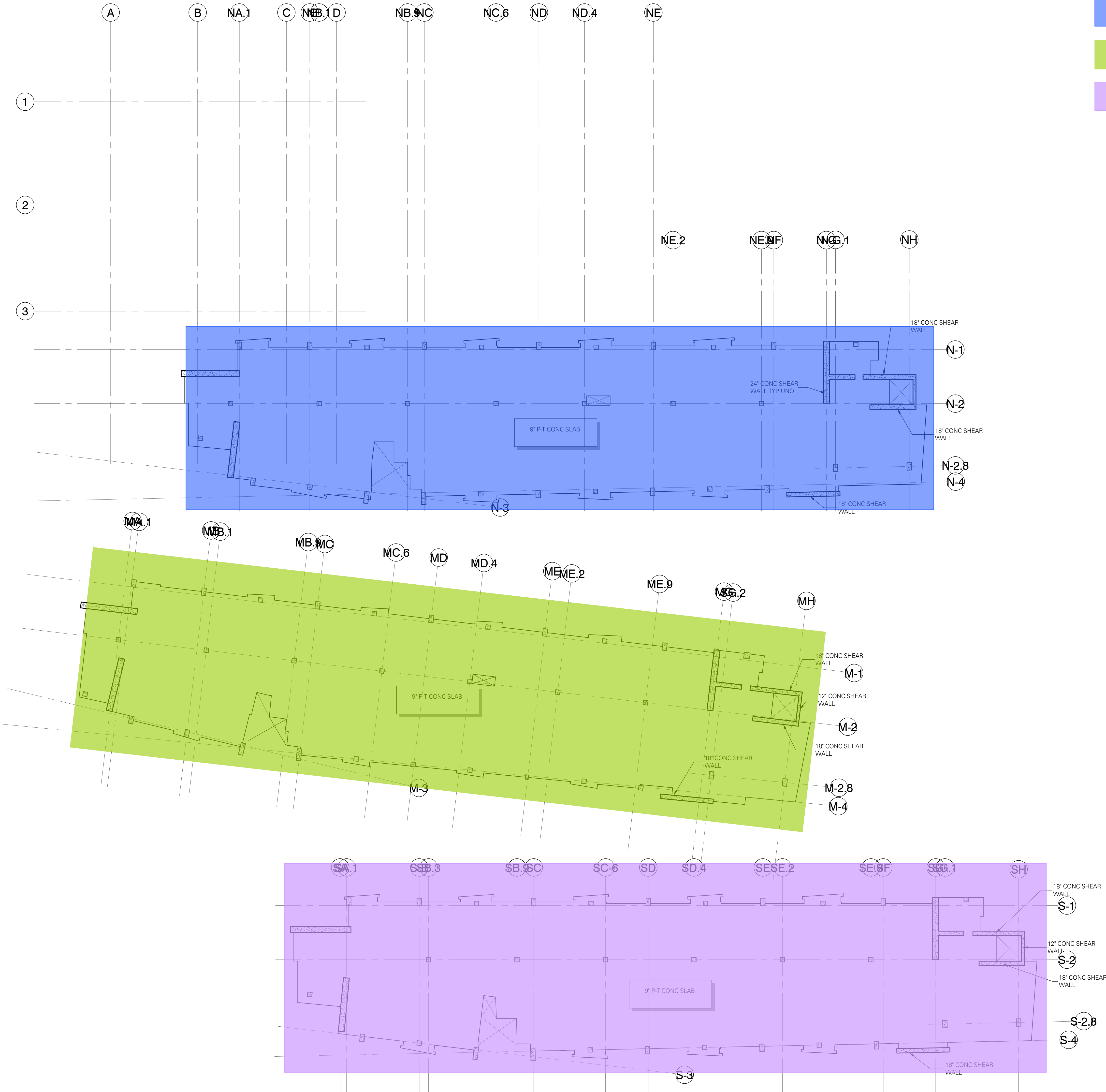

MILD REINFORCING PLAN NOTES:

- STRUCTURAL GENERAL NOTES, DESIGN CRITERIA, ABBREVIATIONS AND LEGEND PER S1.01, S1.02, S1.03 AND S1.04.
- VERIFY ALL DIMENSIONS AND ELEVATIONS WITH THE ARCHITECTURAL DRAWINGS.
- POST-TENSIONED TENDON LAYOUT SHALL BE PER POST-TENSIONED FRAMING PLAN.
- CONTRACTOR IS RESPONSIBLE FOR THE DESIGN AND STAGING OF ALL SHORING AND RESHORING. SHORING PLACED BENEATH SLAB CLOSURE POURS SHALL NOT BE REMOVED UNTIL CLOSURE POUR CONCRETE HAS REACHED SPECIFIED STRENGTH.
- COLUMN OR WALL OVER-POURS INTO POST-TENSIONED SLABS SHALL NOT BE GREATER THAN 1/2" MAXIMUM. REMOVE ANY EXCESSIVE COLUMN OR WALL OVER-POURS PRIOR TO PLACING REINFORCING BARS AND POST-TENSIONED TENDONS.
- DO NOT INSTALL DRILL-IN ADHESIVE AND EXPANSION ANCHORS IN THE POST-TENSIONED SLAB. DRILLING INTO POST-TENSIONED SLAB WITHOUT APPROVAL FROM THE STRUCTURAL ENGINEER OF RECORD IS NOT PERMITTED. ALL BUILDING SYSTEMS: MECHANICAL, ELECTRICAL, PLUMBING, FIRE PROTECTION SHALL PLACE DUCTS, CHASES, PIPES OR PIPE SUPPORTS, CONDUIT SLEEVES AND HANGER INSERTS, ETC INTO THE POST-TENSIONED SLAB PRIOR TO POURING THE CONCRETE.
- ADDITIONAL SHAFTS MAY BE LOCATED AFTER THE SLAB IS POURED IF APPROVED BY THE STRUCTURAL ENGINEER AND COORDINATED WITH THE GENERAL CONTRACTOR.
- PROVIDE 1" CLEAR FOR ALL BOTTOM REINFORCING.
- CONTRACTOR TO COORDINATE EMBED PLATES REQUIRED FOR STAIRS, GUARDRAILS, INTERIOR AND EXTERIOR WALLS, WINDOW WASHING ANCHORS, ETC.
- TYPICAL DETAILS PER:
 - S3.01 FOUNDATION
 - S4.01 COLUMNS
 - S4.02 SHEAR WALLS
 - S5.01-S5.03 CONCRETE

LEVEL 4 FLOOR PLAN

SCALE: 1/16" = 1'-0"



NOT FOR CONSTRUCTION

SLAB ON DECK

POUR BREAKDOWN
AND COLORS

- = POUR 1
- = POUR 2
- = POUR 3

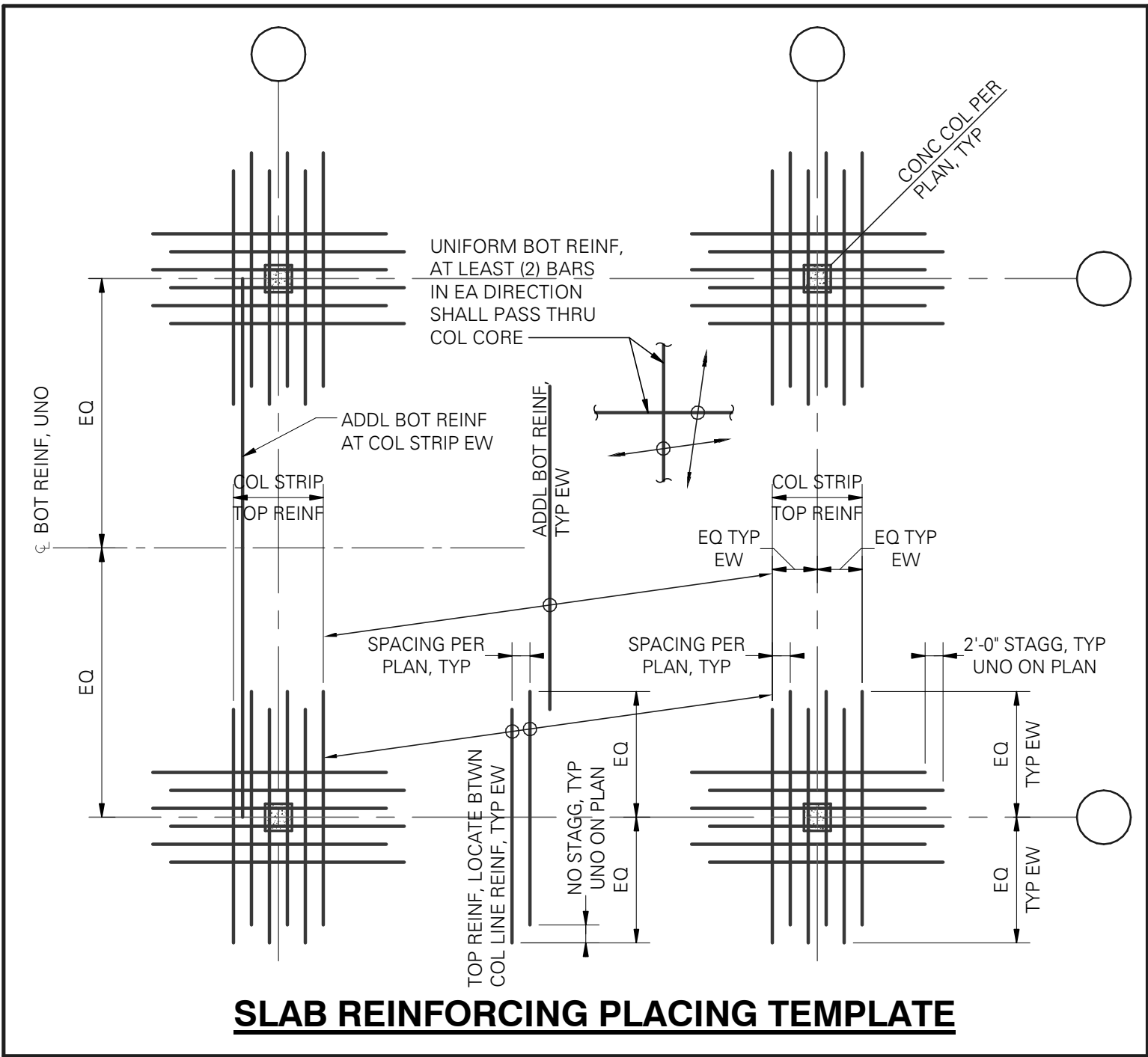
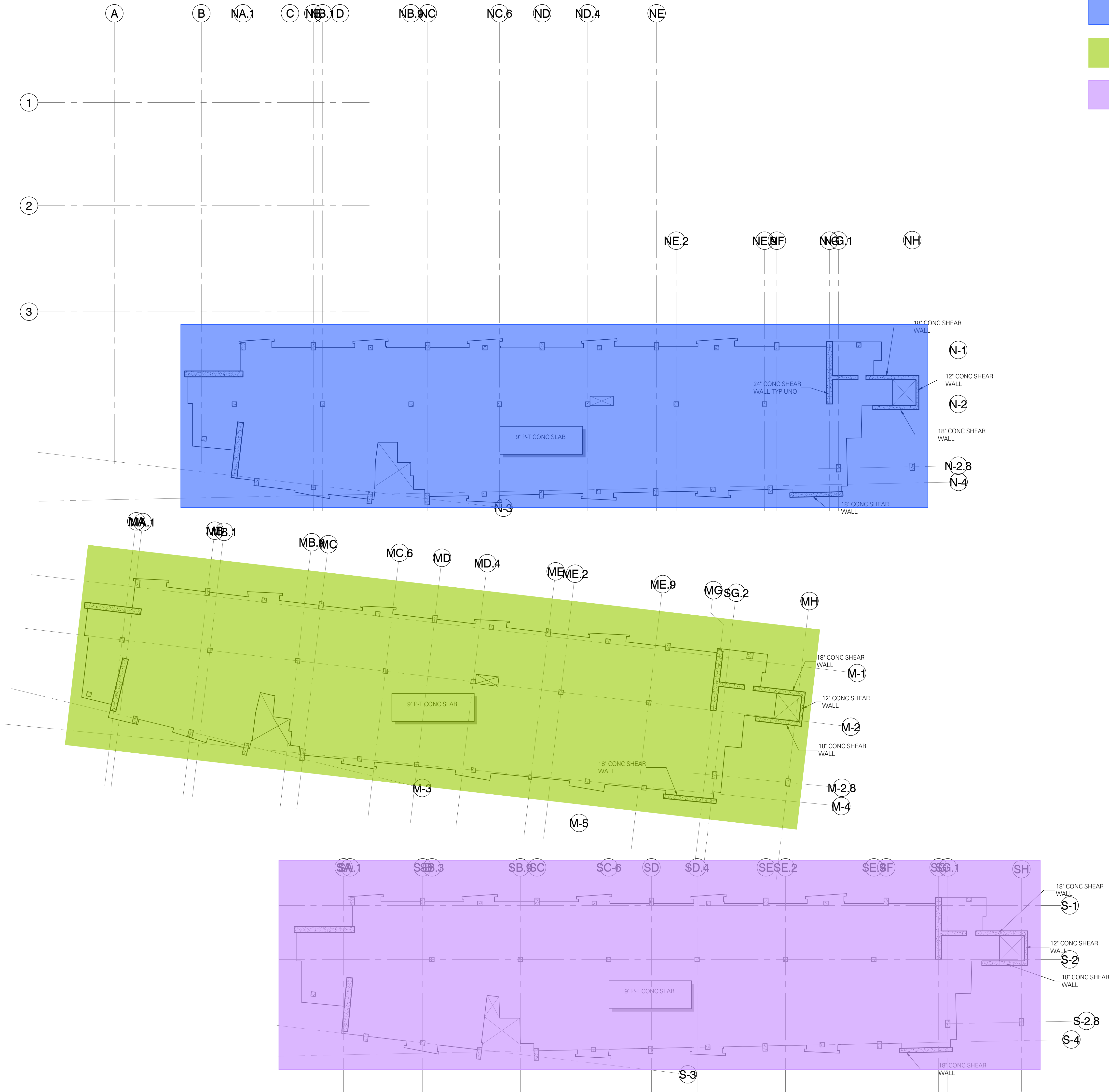

MILD REINFORCING PLAN NOTES:

- STRUCTURAL GENERAL NOTES, DESIGN CRITERIA, ABBREVIATIONS AND LEGEND PER S1.01, S1.02, S1.03 AND S1.04.
- VERIFY ALL DIMENSIONS AND ELEVATIONS WITH THE ARCHITECTURAL DRAWINGS.
- POST-TENSIONED TENDON LAYOUT SHALL BE PER POST-TENSIONED FRAMING PLAN.
- CONTRACTOR IS RESPONSIBLE FOR THE DESIGN AND STAGING OF ALL SHORING AND RESHORING. SHORING PLACED BENEATH SLAB CLOSURE POURS SHALL NOT BE REMOVED UNTIL CLOSURE POUR CONCRETE HAS REACHED SPECIFIED STRENGTH.
- COLUMN OR WALL OVER-POURS INTO POST-TENSIONED SLABS SHALL NOT BE GREATER THAN 1/2" MAXIMUM. REMOVE ANY EXCESSIVE COLUMN OR WALL OVER-POURS PRIOR TO PLACING REINFORCING BARS AND POST-TENSIONED TENDONS.
- DO NOT INSTALL DRILL-IN ADHESIVE AND EXPANSION ANCHORS IN THE POST-TENSIONED SLAB. DRILLING INTO POST-TENSIONED SLAB WITHOUT APPROVAL FROM THE STRUCTURAL ENGINEER OF RECORD IS NOT PERMITTED. ALL BUILDING SYSTEMS: MECHANICAL, ELECTRICAL, PLUMBING, FIRE PROTECTION SHALL PLACE DUCTS, CHASES, PIPES OR PIPE SUPPORTS, CONDUIT SLEEVES AND HANGER INSERTS, ETC INTO THE POST-TENSIONED SLAB PRIOR TO POURING THE CONCRETE.
- ADDITIONAL SHAFTS MAY BE LOCATED AFTER THE SLAB IS POURED IF APPROVED BY THE STRUCTURAL ENGINEER AND COORDINATED WITH THE GENERAL CONTRACTOR.
- PROVIDE 1" CLEAR FOR ALL BOTTOM REINFORCING.
- CONTRACTOR TO COORDINATE EMBED PLATES REQUIRED FOR STAIRS, GUARDRAILS, INTERIOR AND EXTERIOR WALLS, WINDOW WASHING ANCHORS, ETC.
- TYPICAL DETAILS PER:

S3.01	FOUNDATION
S4.01	COLUMNS
S4.02	SHEAR WALLS
S5.01-S5.03	CONCRETE

LEVEL 5 FLOOR PLAN

SCALE: 1/16" = 1'-0"



NOT FOR CONSTRUCTION

MITHUN

SEATTLE | P.O. Box 55, 1201 Alaskan Way, #200
Seattle, WA 98101 | 206.423.3344
SAN FRANCISCO | 665 Market Street, #300
San Francisco, CA 94104 | 415.560.0888

ARCHITECT, LANDSCAPE ARCHITECT, INTERIOR DESIGNERS
MITHUN, INC.

STRUCTURAL ENGINEER
DCI ENGINEERS

CIVIL ENGINEER
KHR ENGINEERS

MECHANICAL / PLUMBING ENGINEER
HARTFORD ENGINEERING

ELECTRICAL ENGINEER
MICHAEL WALL ENGINEERING

DESIGN BUILDER
HENSEL PHELPS

HENSEL PHELPS
Plan. Build. Manage.

PROJECT
Project Name Here

LOCATION
Enter address by clicking
Manage Tab and Project
Information
PREPARED FOR

UCI
University of California, Irvine
Design & Construction
Services
5201 California Ave Suite 250
Irvine, CA 92697

UCI PROJECT NO.

996296

REVISION

NO. DATE REVISION

PROJECT DIRECTOR

PROJECT MANAGER

PROJECT ARCHITECT

PROJECT TEAM MEMBERS

CHECK

ARCHITECT SEAL

TITLE
LEVEL 5 FLOOR PLAN

PROJECT NO.

14051-0020

DATE

5-30-2014

SHEET NUMBER

S2.05

Project Status

© 2014 MITHUN, INC.

SLAB ON DECK

POUR BREAKDOWN
AND COLORS

- = POUR 1
- = POUR 2
- = POUR 3

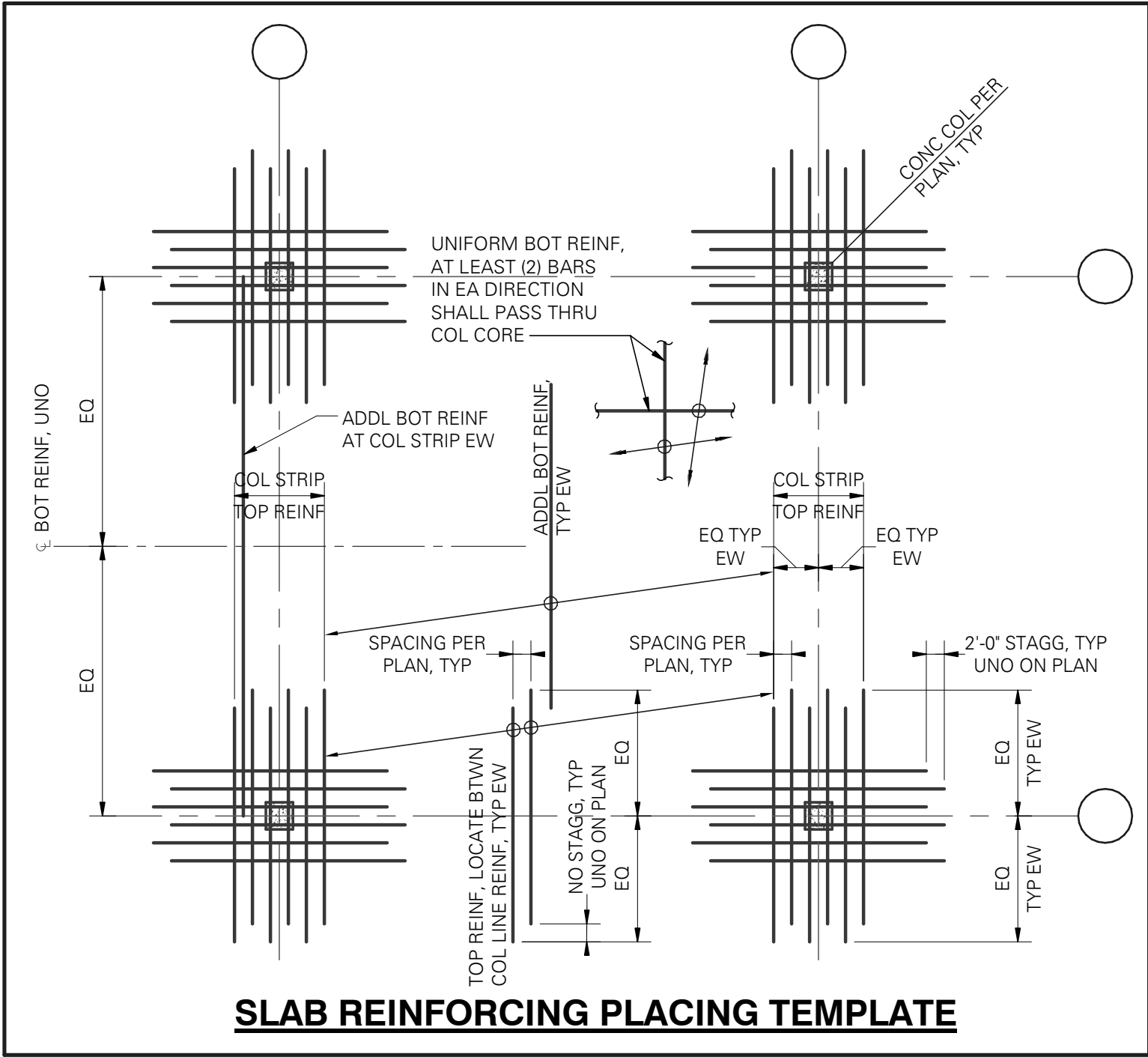

- MILD REINFORCING PLAN NOTES:
- STRUCTURAL GENERAL NOTES, DESIGN CRITERIA, ABBREVIATIONS AND LEGEND PER S1.01, S1.02, S1.03 AND S1.04.
 - VERIFY ALL DIMENSIONS AND ELEVATIONS WITH THE ARCHITECTURAL DRAWINGS.
 - POST-TENSIONED TENDON LAYOUT SHALL BE PER POST-TENSIONED FRAMING PLAN.
 - CONTRACTOR IS RESPONSIBLE FOR THE DESIGN AND STAGING OF ALL SHORING AND RESHORING. SHORING PLACED BENEATH SLAB CLOSURE POURS SHALL NOT BE REMOVED UNTIL CLOSURE POUR CONCRETE HAS REACHED SPECIFIED STRENGTH.
 - COLUMN OR WALL OVER-POURS INTO POST-TENSIONED SLABS SHALL NOT BE GREATER THAN 1/2" MAXIMUM. REMOVE ANY EXCESSIVE COLUMN OR WALL OVER-POURS PRIOR TO PLACING REINFORCING BARS AND POST-TENSIONED TENDONS.
 - DO NOT INSTALL DRILL-IN ADHESIVE AND EXPANSION ANCHORS IN THE POST-TENSIONED SLAB. DRILLING INTO POST-TENSIONED SLAB WITHOUT APPROVAL FROM THE STRUCTURAL ENGINEER OF RECORD IS NOT PERMITTED. ALL BUILDING SYSTEMS: MECHANICAL, ELECTRICAL, PLUMBING, FIRE PROTECTION SHALL PLACE DUCTS, CHASES, PIPES OR PIPE SUPPORTS, CONDUIT SLEEVES AND HANGER INSERTS, ETC INTO THE POST-TENSIONED SLAB PRIOR TO POURING THE CONCRETE.
 - ADDITIONAL SHAFTS MAY BE LOCATED AFTER THE SLAB IS POURED IF APPROVED BY THE STRUCTURAL ENGINEER AND COORDINATED WITH THE GENERAL CONTRACTOR.
 - PROVIDE 1" CLEAR FOR ALL BOTTOM REINFORCING.
 - CONTRACTOR TO COORDINATE EMBED PLATES REQUIRED FOR STAIRS, GUARDRAILS, INTERIOR AND EXTERIOR WALLS, WINDOW WASHING ANCHORS, ETC.
 - TYPICAL DETAILS PER:
 - S3.01 FOUNDATION
 - S4.01 COLUMNS
 - S4.02 SHEAR WALLS
 - S5.01-S5.03 CONCRETE

MITHUN

SEATTLE | Pier 56, 1201 Alaskan Way, #200
Seattle, WA 98101 | 206.423.3344
SAN FRANCISCO | 685 Market Street, #300
San Francisco, CA 94104 | 415.590.0888

ARCHITECT, LANDSCAPE ARCHITECT, INTERIOR DESIGNERS
MITHUN, INC.

STRUCTURAL ENGINEER
DCI ENGINEERS
10118 Broadway #200
San Diego, CA 92101
(619) 524-9801

CIVIL ENGINEER
KHR ENGINEERS
4100 Newport Place Drive, #200
Newport Beach, CA 92660
(949) 738-5400

MECHANICAL / PLUMBING ENGINEER
HARTFORD ENGINEERING
11440 West Bonaville Court, #202
San Diego, CA 92121
(619) 337-7712

ELECTRICAL ENGINEER
MICHAEL WALL ENGINEERING
19802 Avenida Real, #200
Irvine, CA 92612
(949) 452-0800

DESIGN BUILDER
HENSEL PHELPS
10850 Van Kester Ave, #100
Irvine, CA 92618
(949) 452-0111

HENSEL PHELPS
Plan. Build. Manage.

PROJECT
Project Name Here

LOCATION
Enter address by clicking
Manage Tab and Project
Information
PREPARED FOR

UCI
University of California, Irvine
Design & Construction
Services
5201 California Ave Suite 250
Irvine, CA 92697

UCI PROJECT NO.
996296

REVISION

NO. DATE REVISION

PROJECT DIRECTOR

PROJECT MANAGER

PROJECT ARCHITECT

PROJECT TEAM MEMBERS

CHECK

ARCHITECT SEAL

TITLE
LEVEL 6 FLOOR PLAN

PROJECT NO.
14051-0020
DATE
5-30-2014

SHEET NUMBER
S2.06
Project Status
© 2014 MITHUN, INC.

NOT FOR CONSTRUCTION

SLAB ON DECK

POUR BREAKDOWN
AND COLORS

- = POUR 1
- = POUR 2
- = POUR 3

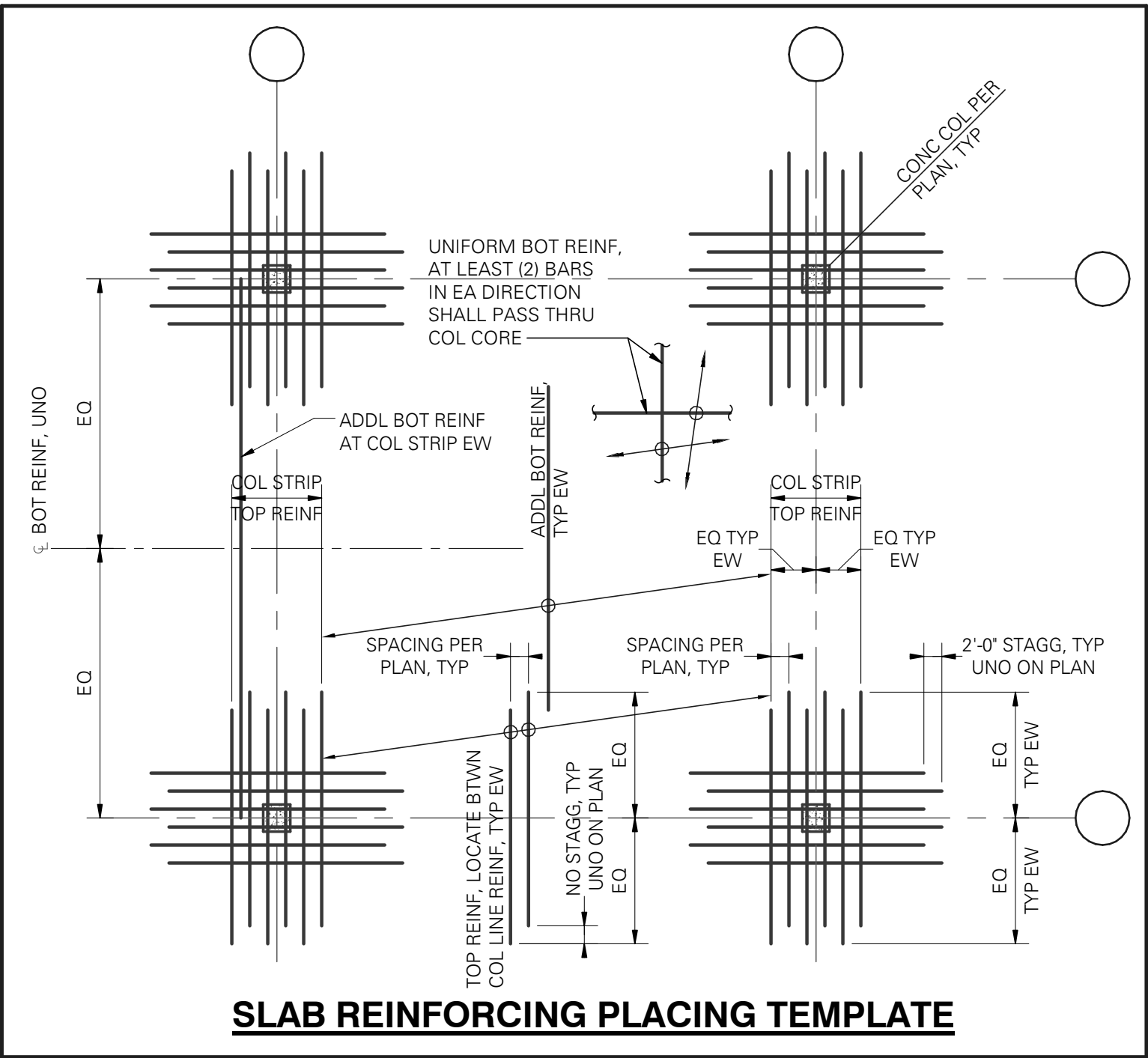
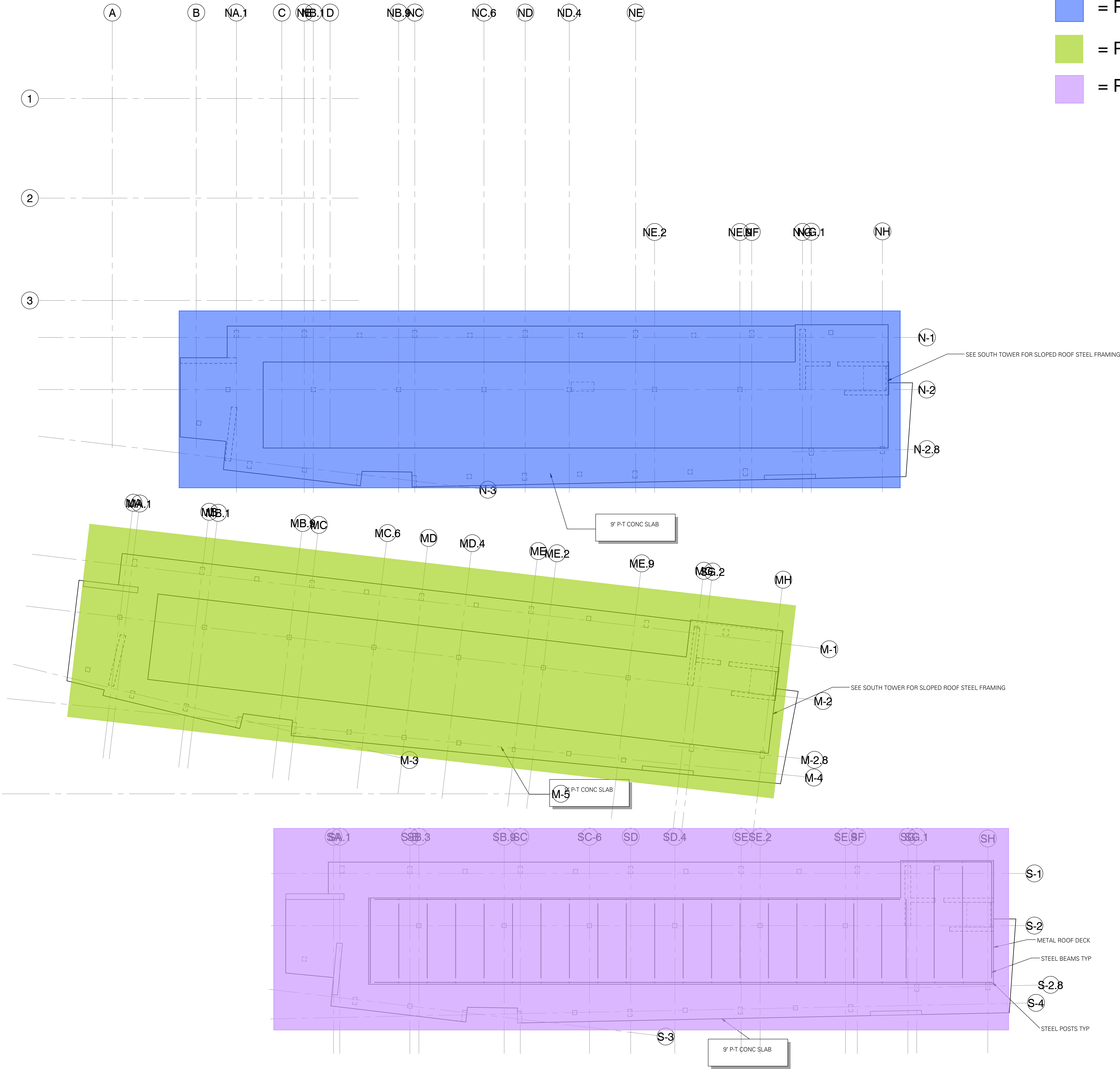

- MILD REINFORCING PLAN NOTES:
- STRUCTURAL GENERAL NOTES, DESIGN CRITERIA, ABBREVIATIONS AND LEGEND PER S1.01, S1.02, S1.03 AND S1.04.
 - VERIFY ALL DIMENSIONS AND ELEVATIONS WITH THE ARCHITECTURAL DRAWINGS.
 - POST-TENSIONED TENDON LAYOUT SHALL BE PER POST-TENSIONED FRAMING PLAN.
 - CONTRACTOR IS RESPONSIBLE FOR THE DESIGN AND STAGING OF ALL SHORING AND RESHORING. SHORING PLACED BENEATH SLAB CLOSURE POURS SHALL NOT BE REMOVED UNTIL CLOSURE POUR CONCRETE HAS REACHED SPECIFIED STRENGTH.
 - COLUMN OR WALL OVER-POURS INTO POST-TENSIONED SLABS SHALL NOT BE GREATER THAN 1/2" MAXIMUM. REMOVE ANY EXCESSIVE COLUMN OR WALL OVER-POURS PRIOR TO PLACING REINFORCING BARS AND POST-TENSIONED TENDONS.
 - DO NOT INSTALL DRILL-IN ADHESIVE AND EXPANSION ANCHORS IN THE POST-TENSIONED SLAB. DRILLING INTO POST-TENSIONED SLAB WITHOUT APPROVAL FROM THE STRUCTURAL ENGINEER OF RECORD IS NOT PERMITTED. ALL BUILDING SYSTEMS: MECHANICAL, ELECTRICAL, PLUMBING, FIRE PROTECTION SHALL PLACE DUCTS, CHASES, PIPES OR PIPE SUPPORTS, CONDUIT SLEEVES AND HANGER INSERTS, ETC INTO THE POST-TENSIONED SLAB PRIOR TO POURING THE CONCRETE.
 - ADDITIONAL SHAFTS MAY BE LOCATED AFTER THE SLAB IS POURED IF APPROVED BY THE STRUCTURAL ENGINEER AND COORDINATED WITH THE GENERAL CONTRACTOR.
 - PROVIDE 1" CLEAR FOR ALL BOTTOM REINFORCING.
 - CONTRACTOR TO COORDINATE EMBED PLATES REQUIRED FOR STAIRS, GUARDRAILS, INTERIOR AND EXTERIOR WALLS, WINDOW WASHING ANCHORS, ETC.
 - TYPICAL DETAILS PER:
 - S3.01 FOUNDATION
 - S4.01 COLUMNS
 - S4.02 SHEAR WALLS
 - S5.01-S5.03 CONCRETE

ROOF LEVEL
SCALE: 1/16" = 1'-0"



MITHUN

SEATTLE | Pier 56, 1201 Alaskan Way, #200
Seattle, WA 98101 | 206.423.3344
SAN FRANCISCO | 665 Market Street, #300
San Francisco, CA 94104 | 415.560.0888

ARCHITECT, LANDSCAPE ARCHITECT, INTERIOR DESIGNERS
MITHUN, INC.
101 W. Broadway, #200
San Diego, CA 92101
(619) 521-3344

STRUCTURAL ENGINEER
DCI ENGINEERS
101 W. Broadway, #200
San Diego, CA 92101
(619) 521-3344

CIVIL ENGINEER
KHR ENGINEERS
4100 Newport Place Drive, #200
Newport Beach, CA 92660
(949) 738-6400

MECHANICAL / PLUMBING ENGINEER
HARTFORD ENGINEERING
11440 West Bonaventure Court, #200
San Diego, CA 92121
(619) 521-7712

ELECTRICAL ENGINEER
MICHAEL WALL ENGINEERING
10802 Wilshire Blvd, #200
Irvine, CA 92618
(949) 452-0800

DESIGN BUILDER
HENSEL PHELPS
10800 Van Kester Ave, #100
Irvine, CA 92618
(949) 452-0111

HENSEL PHELPS
Plan. Build. Manage.

PROJECT
Project Name Here

LOCATION
Enter address by clicking
Manage Tab and Project
Information
PREPARED FOR

UCI
University of California, Irvine
Design & Construction
Services
5201 California Ave Suite 250
Irvine, CA 92697

UCI PROJECT NO.
996296

REVISION

NO. DATE REVISION

PROJECT DIRECTOR

PROJECT MANAGER

PROJECT ARCHITECT

PROJECT TEAM MEMBERS

CHECK

ARCHITECT SEAL

TITLE
ROOF LEVEL FLOOR PLAN

PROJECT NO.
14051-0020
DATE
5-30-2014

SHEET NUMBER
S2.07
Project Status
© 2014 MITHUN, INC.

NOT FOR CONSTRUCTION